

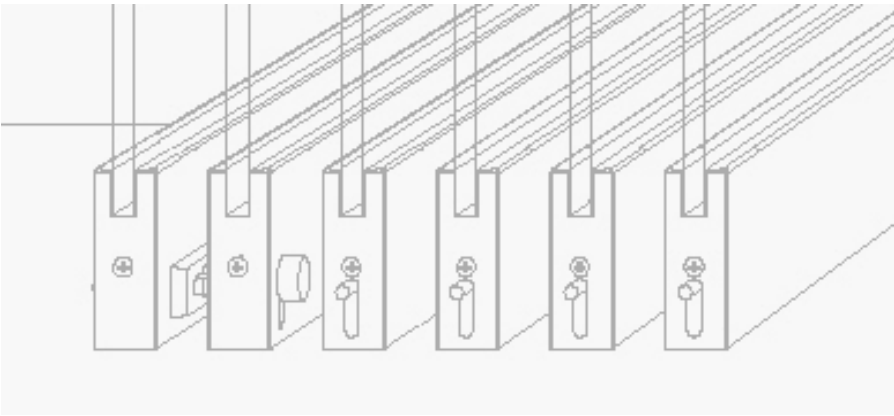

SLF300

**Slide and Stack
Glass Panel System**



SLF300

SLF300 Slide and Stack Glass Panel System features a comprehensive combination of aluminium top track that facilitates flexibility in design layout. This system is able to carry frameless glass door panels of up to 4000mm in height and width of up to 1100mm.

With its robust carriage roller made up of stainless steel body with eight ball bearing wheels, it allows better weight distribution and stability, thereby eliminating excessive swaying and reducing the track to wheel friction thus translating smooth and effortless sliding motion.

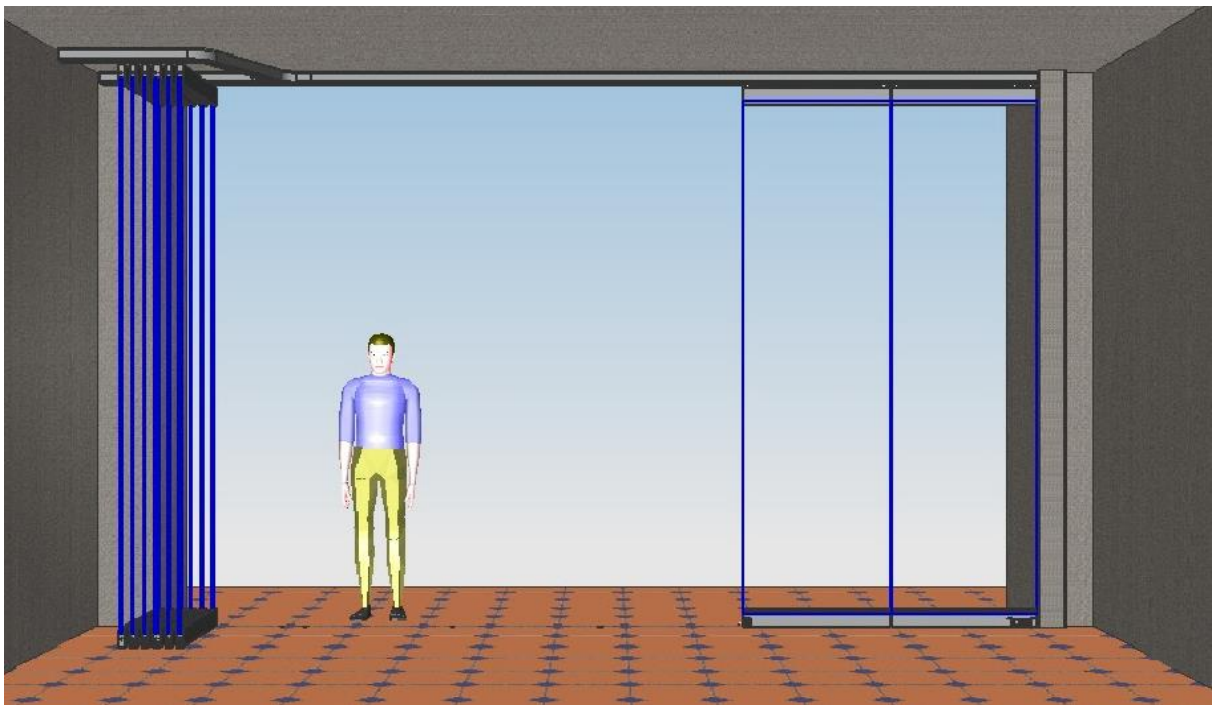
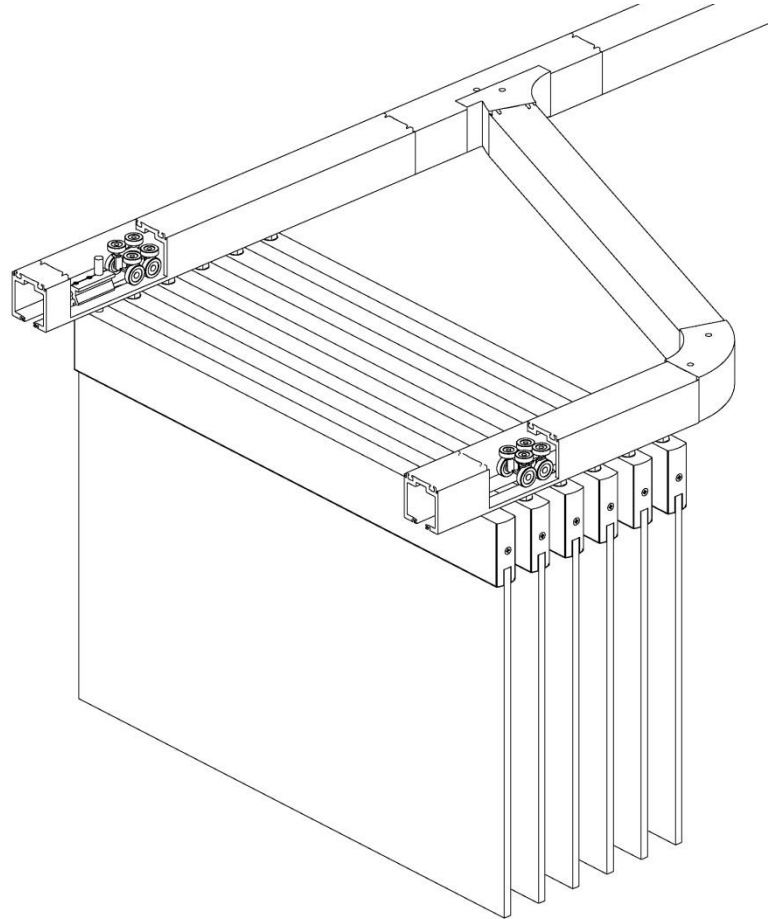

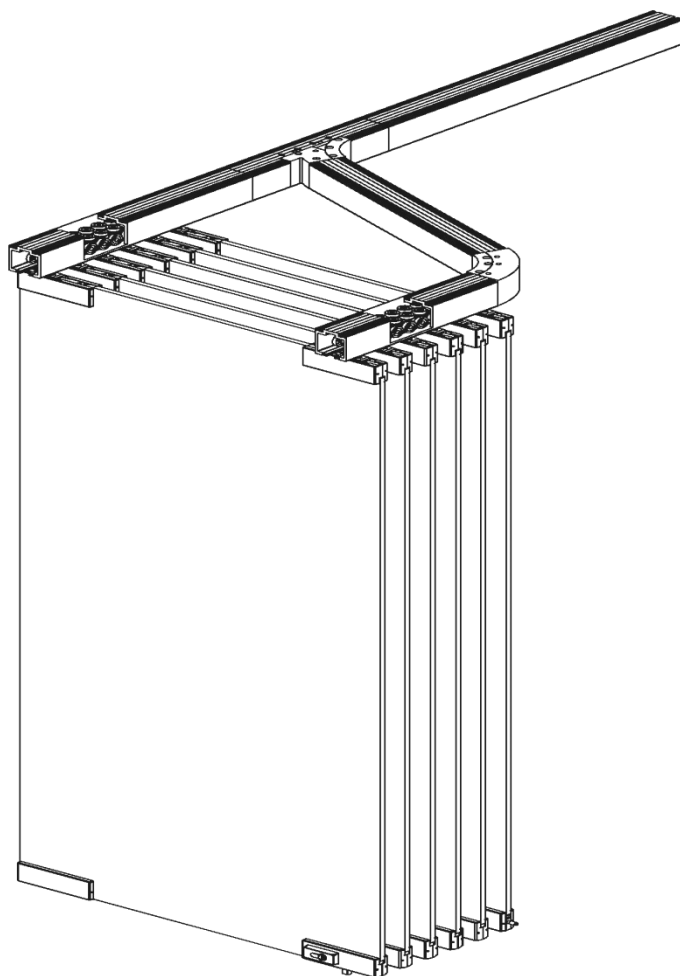

SLF300P complements both maximum shop front area and close customer proximity as you have a choice of various parking space layout to dock the individual frameless glass panels.

It also enhances maximum security with various security locking devices (key lock; thumb turn lock).

SLF300 comprises of sliding door intermediate panels and swing door pivot panel. In addition, you have a choice of both aluminum clip-on rail covers or stainless steel rail-covers of both polish and satin finish.

SLF300P

For maximum vision, the system is now available in standard universal patch fittings.

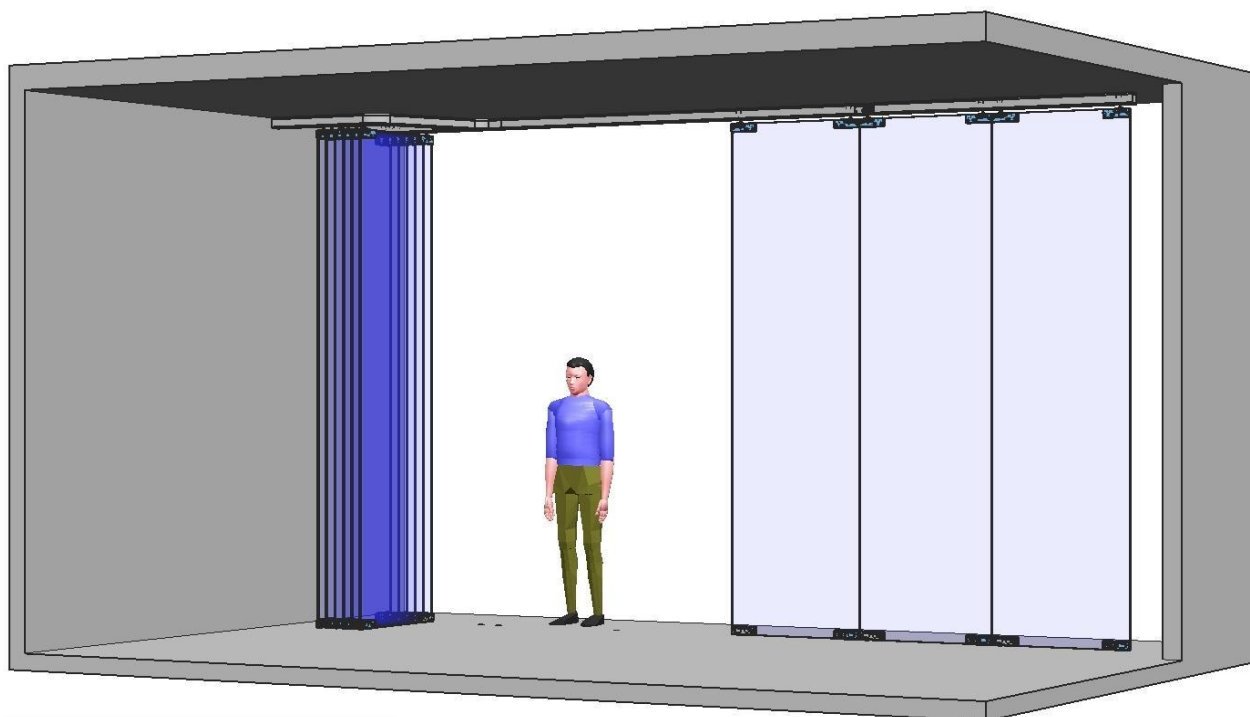

Cross Section (Intermediate Panels) with DRM80 Rails

SLF300 with DRM80 Rails is available with the following components:

- Main Top Tracks
- Sliding Door Panels comprising of:
 - DRM80 Top & Bottom Rails (1set / panel)
 - 8pt Carriage Rollers (2nos / panel)
 - Rubber Seal / Bristle
 - Flush Bolts
 - End Caps
 - Bolt Keepers
- Pivot Door Panel comprising of:
 - DRM80 Top & Bottom Rails (1set / panel)
 - Top Pivot / End Stopper
 - Bottom Pivot
 - Rubber Seal / Bristle
 - Euro-profile Key / Thumb Turn Cylinders
 - Lock Bolt
 - End Caps
 - Bolt Keeper
- Parking Bay comprising of:
 - Junction Track (90° / 110°)
 - Elbow Track (90° / 110°)

Upon order, please specify the following:

- Length of Rails
(Glass panel width is required)
- Door Rails Covers
Aluminium Snap-On (Natural Anodised)
Stainless Steel (Polish/Satin)
- Glass Thickness
(10 / 12mm)
- Key Combinations
(Independent / Key-Alike)

Note:

- Total number of panels per system is determined by:
Total clear opening width
Per glass panel width (ne: 1000mmL)
Number of Parking Bay
- SUS316 stainless steel cover is available subject to availability.
- Glass thru-hole fixing is recommended for door panels with $\geq 3\text{m}$ height.

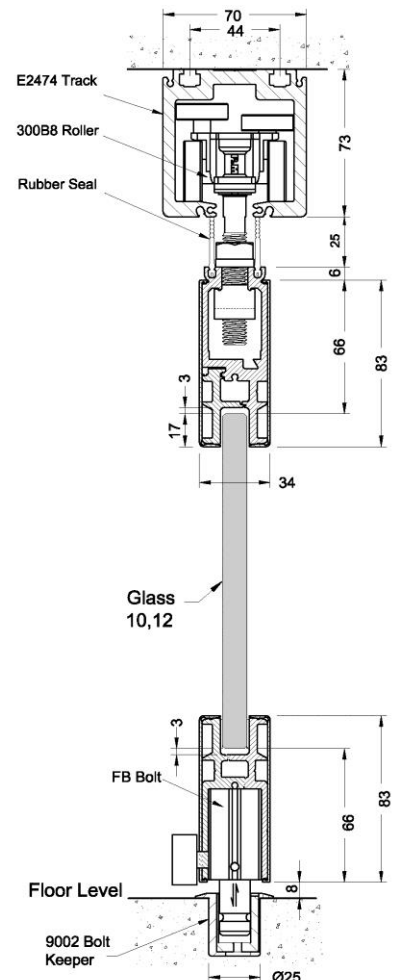
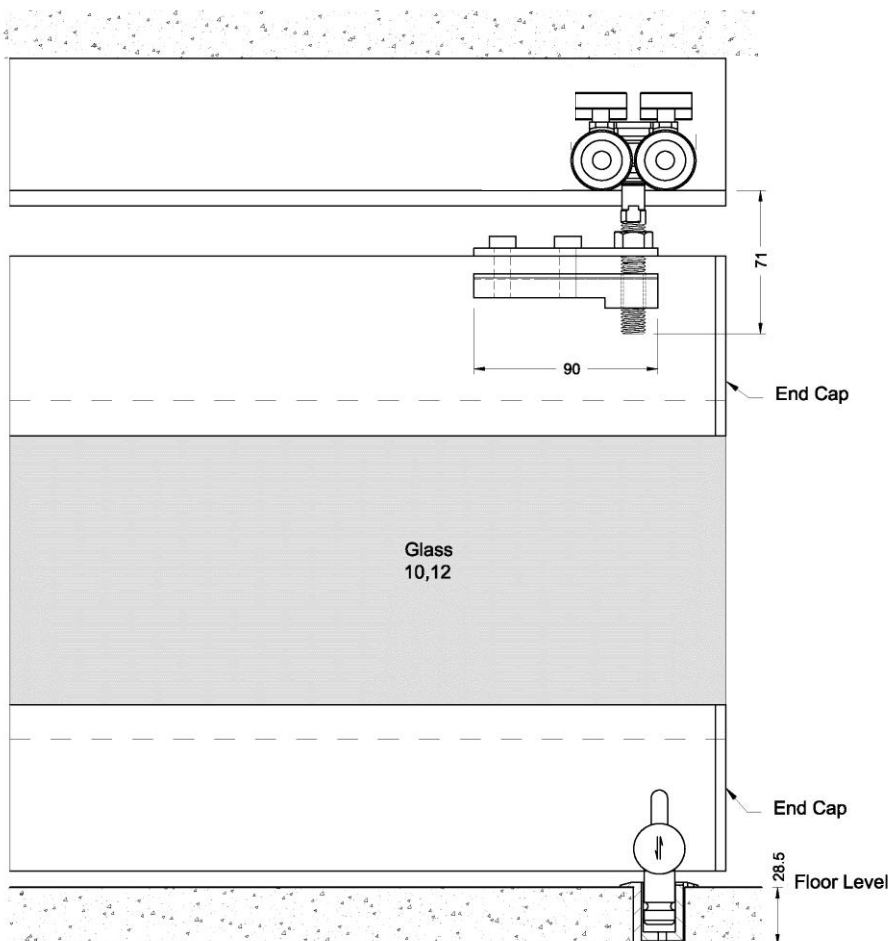

Cross Section (Intermediate Panels) with DRM100 Rails

SLF300 with DRM100 Rails is available with the following components:

- Main Top Tracks
- Sliding Door Panels comprising of:
 - DRM100 Top & Bottom Rails (1set / panel)
 - 8pt Carriage Rollers (2nos / panel)
 - Rubber Seals / Bristles
 - Flush Bolts
 - End Caps
 - Bolt Keepers
- Pivot Door Panel comprising of:
 - DRM100 Top & Bottom Rails (1set / panel)
 - Top Pivot / End Stopper
 - Bottom Pivot
 - Rubber Seals / Bristles
 - Euro-profile Key / Thumb Turn Cylinders
 - Lock Bolt
 - End Caps
 - Bolt Keeper
- Parking Bay comprising of:
 - Junction Track (90° / 110°)
 - Elbow Track (90° / 110°)

Upon order, please specify the following:

- Length of Rails
(Glass panel width is required)
- Door Rails Covers
Aluminium Snap-On (Natural Anodised)
Stainless Steel (Polish/Satin)
- Glass Thickness
(10 / 12mm)
- Key Combinations
(Independent / Key-Alike)

Note:

- Total number of panels per system is determined by:
Total clear opening width
Per glass panel width (ne: 1000mmL)
Number of Parking Bay
- SUS316 stainless steel cover is available subject to availability.
- Glass thru-hole fixing is recommended for door panels with $\geq 3\text{m}$ height.

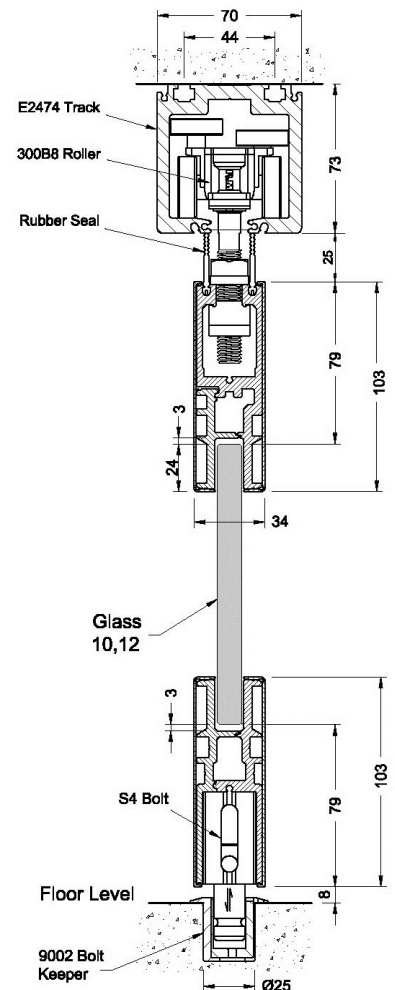
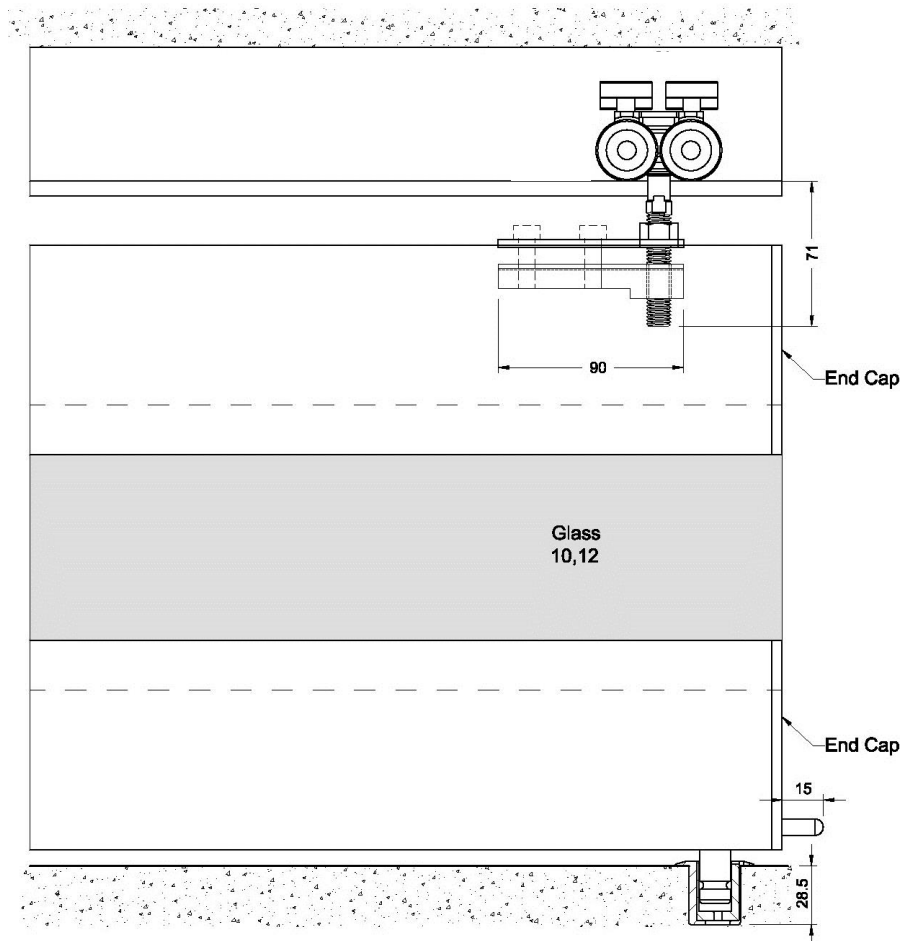

SLF300P

Slide and Stack Glass Panel in Patch Fitting

SLF300P is available with the following components:

- Main Top Tracks
- Sliding Door Panels comprising of:
 - PSAS 300-T Top Patch (2nos / panel)
 - PSAS 300-F Bottom Patch (1no / panel)
 - PSAS 300-M Bottom Patch (1no / panel)
 - 8pt Carriage Rollers (2nos / panel)
 - Countersunk Screw Pack
 - Keeper Cup
- Pivot Door Panel comprising of:
 - PD 20 Top Patch (1no)
 - PD24 Top Pivot (1no)
 - PD10 Bottom Patch (1no)
 - PD15 Bottom Pivot (1no)
 - PL50 Patch Lock (1no)
 - Countersunk Screw Pack
 - Bolt Keeper
- Parking Bay comprising of:
 - Junction Track (90° / 110°)
 - Elbow Track (90° / 110°)

Upon order, please specify the following:

- Patch Finishes:
 - Polished Stainless Steel
 - Satin Stainless Steel
 - Physical Vapour Deposit
- Glass Thickness
 - (10 / 12mm)
- Key Combinations
 - (Independent / Key-Alike)

Note:

- Total number of panels per system is determined by:
 - Total clear opening width
 - Per glass panel width (ne: 1000mmL)
 - Number of Parking Bay

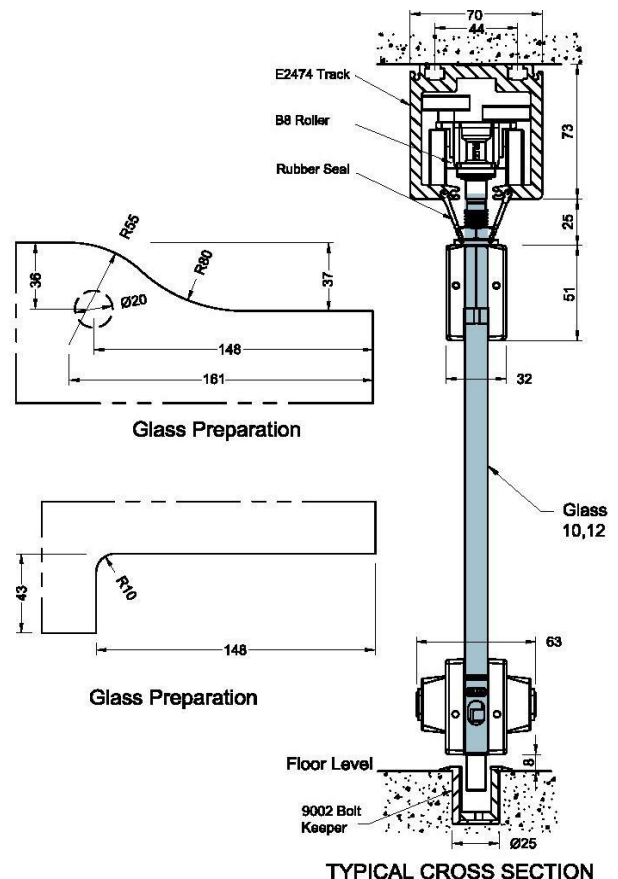
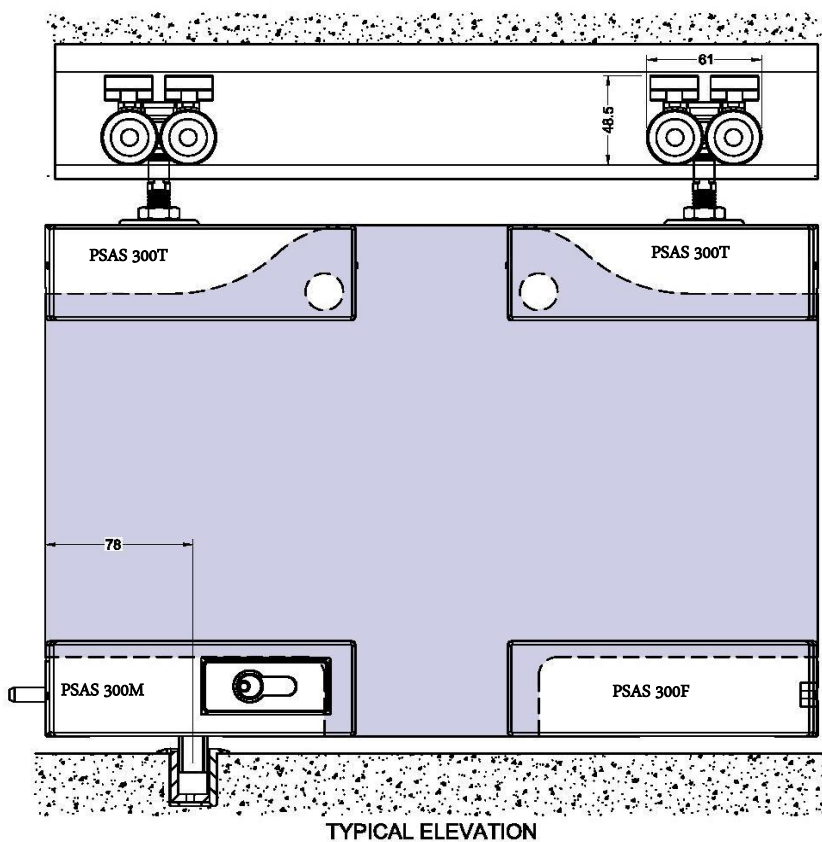

Plan View of Parking Space

Layout 1

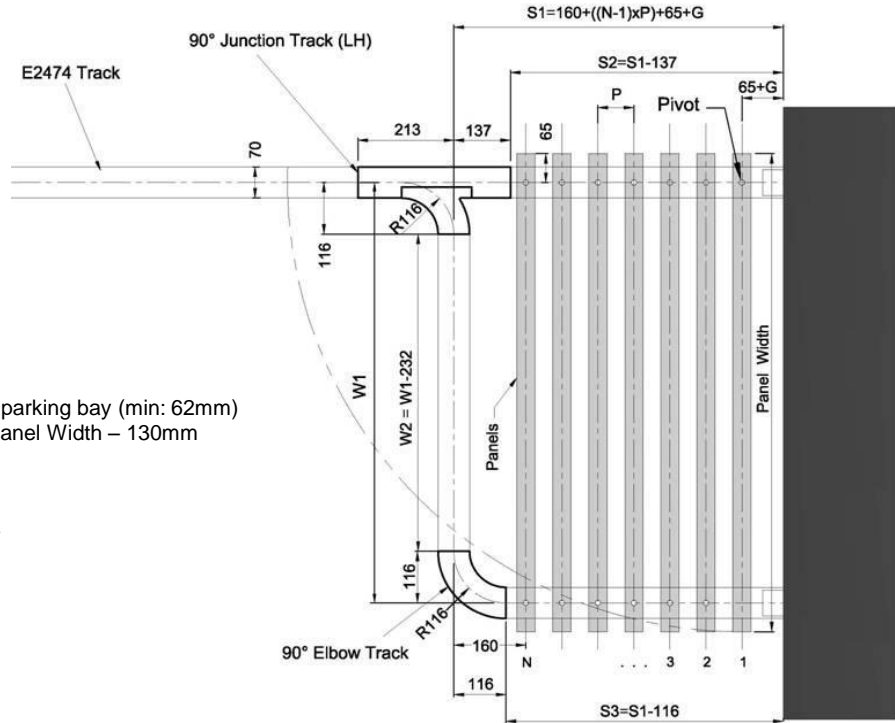

Legend:

N = No. of panels
 P = distance between panels on parking bay (min: 62mm)
 W1 = Width of stacking track = Panel Width – 130mm
 G = Gap between wall and panel

Note:

1st Panel is a pivoting panel door

Layout 2

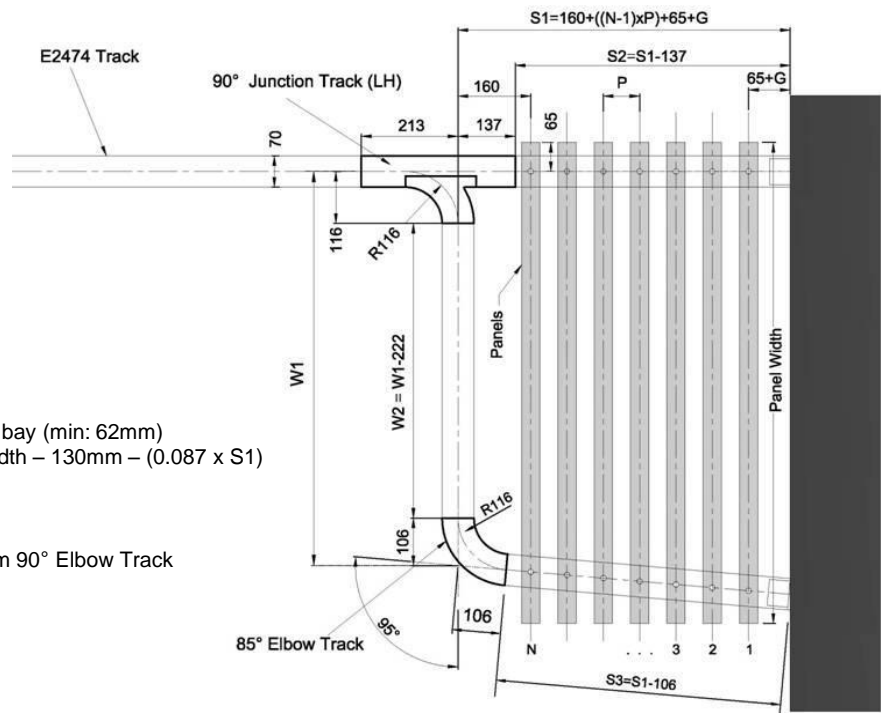

Legend:

N = No. of panels
 P = distance between panels on parking bay (min: 62mm)
 W1 = Width of stacking track = Panel Width – 130mm – (0.087 x S1)
 G = Gap between wall and panel

Note:

85° Elbow Track is fabricated on site from 90° Elbow Track

Plan View of Parking Bay

Layout 3

Legend:

N = No. of panels
P = distance between panels on parking bay (min: 62mm)
G = Gap between wall and panel

*GIVEN : W1 = 945mm
L = 586mm

$W2 = (W1 \times 1.064) - 162 = 843.5\text{mm}$

$B = (W1 \times 0.36397) + L - 91 = 839\text{mm}$

Note:

1st Panel is a pivoting panel door

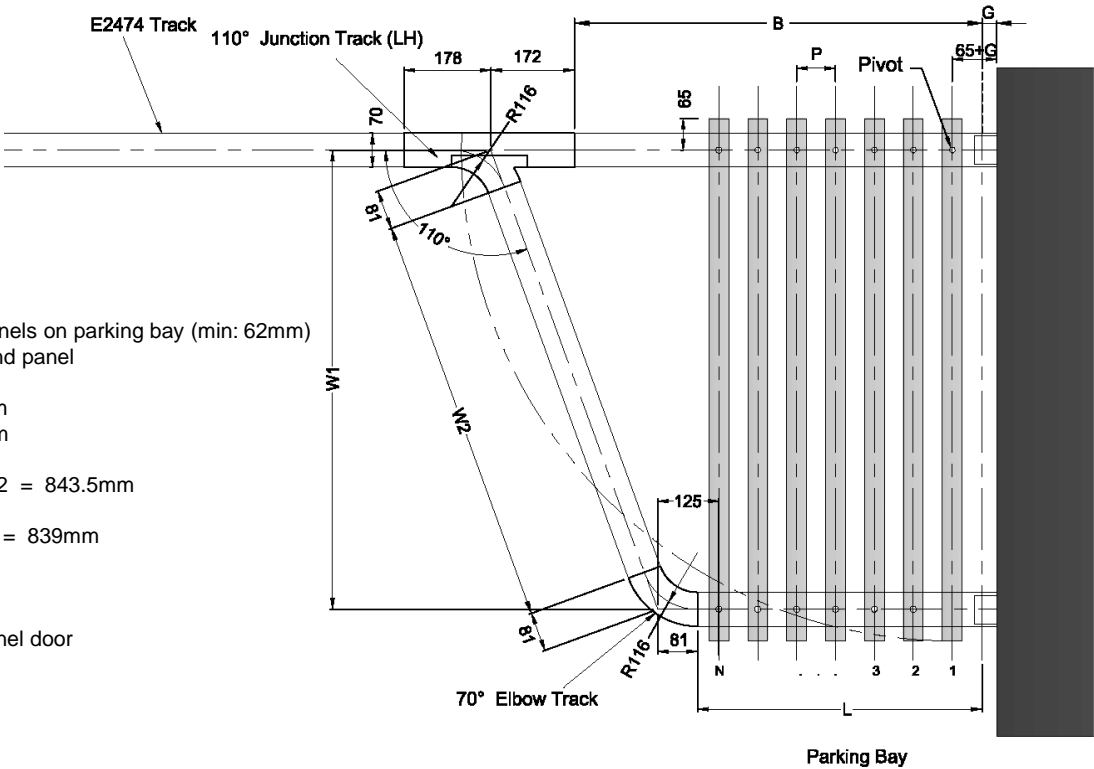

Layout 4

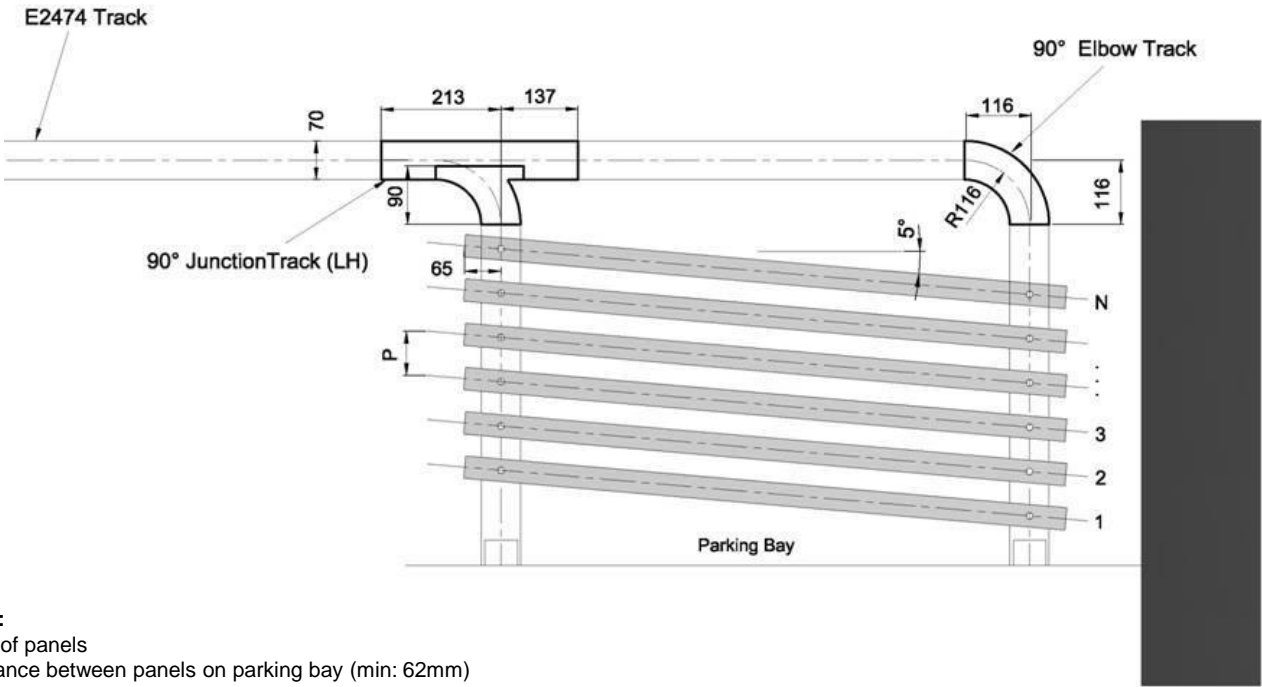

Legend:

N = No. of panels
P = distance between panels on parking bay (min: 62mm)

Layout 5

Aluminium Top Track

90° Left Hand Junction

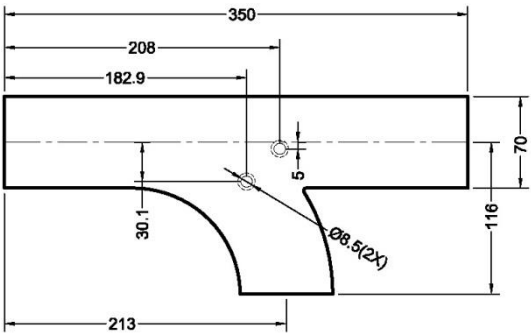
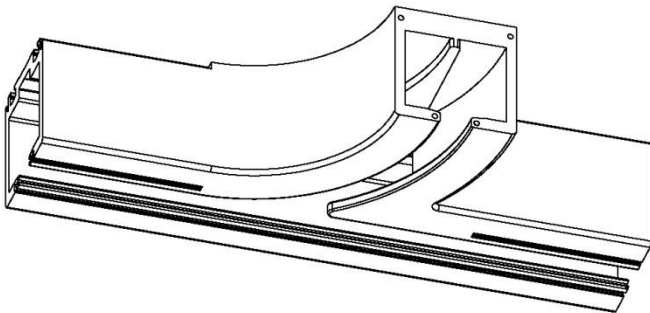

90° Right Hand Junction

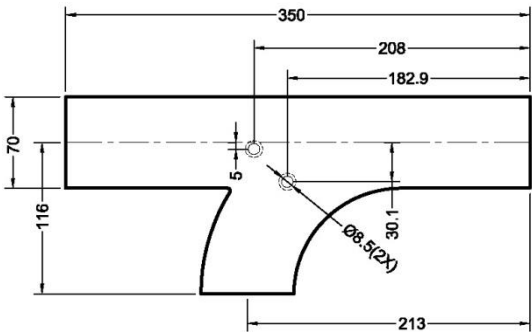
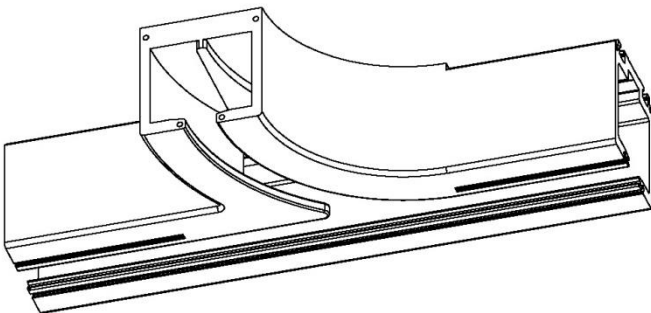

110° Left Hand Junction

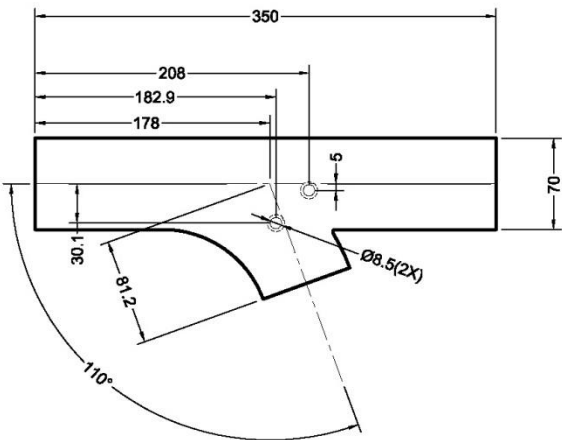
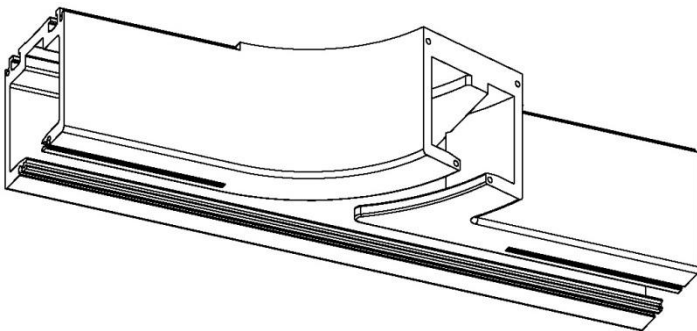

Aluminium Top Track

110° Right Hand Junction

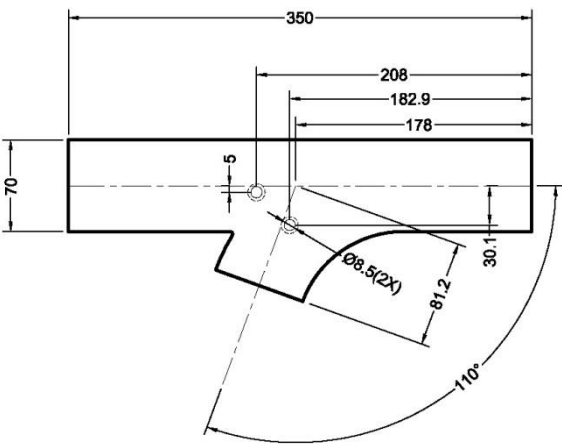
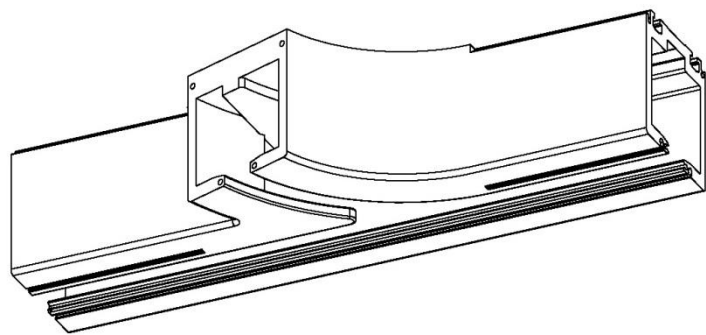

90° Elbow

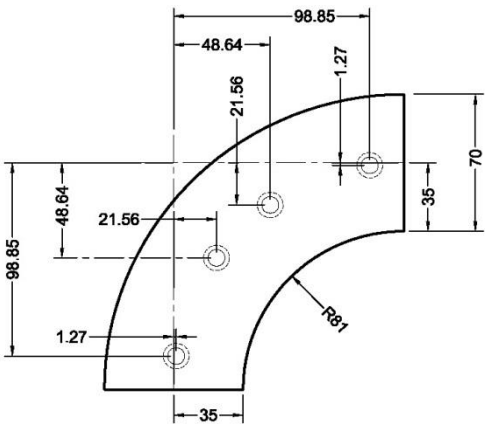
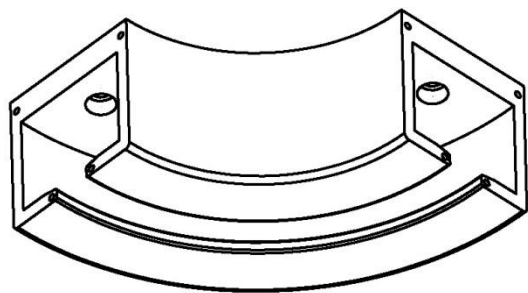

110° Elbow

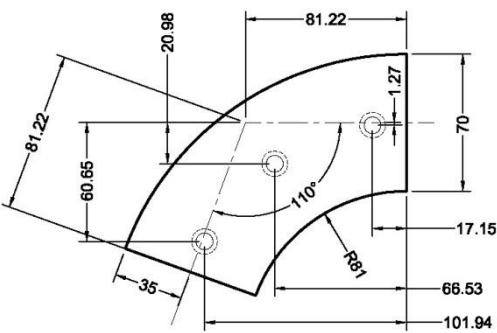
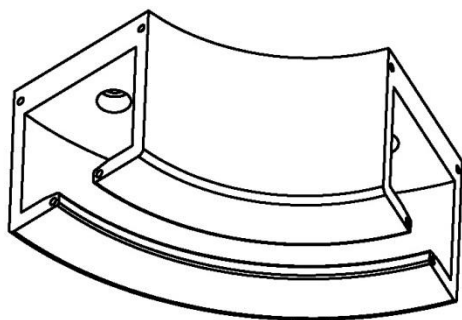

Aluminium Top Track

T-JUNCTION

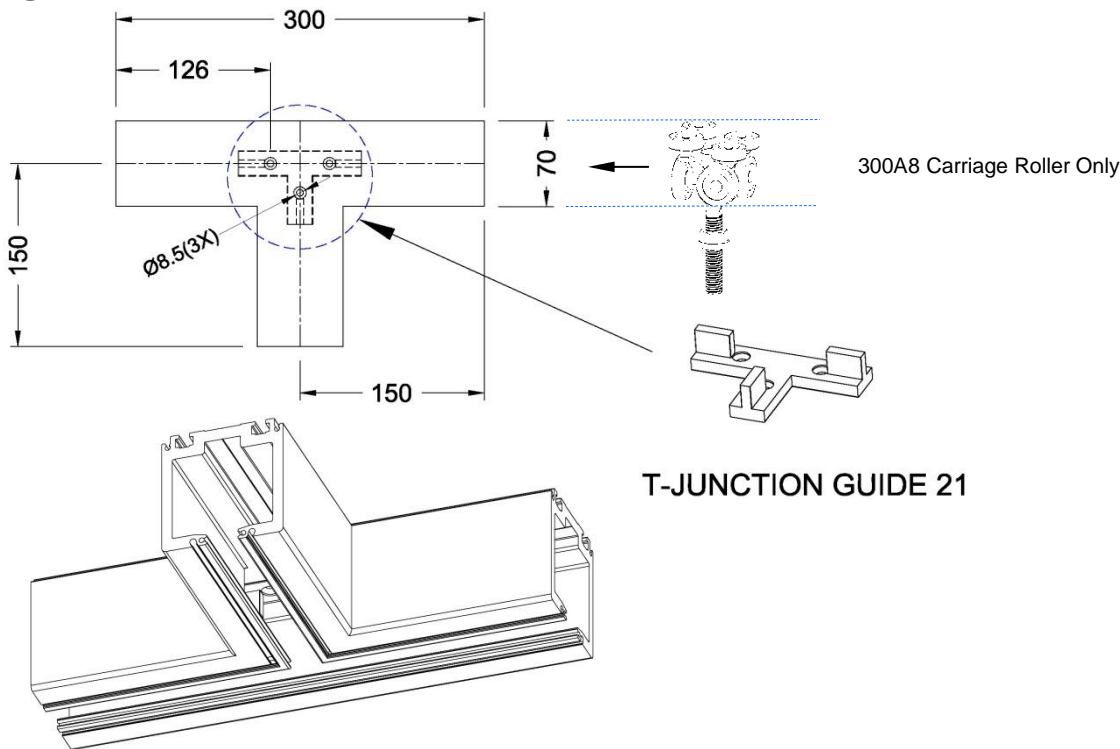

CORNER JUNCTION

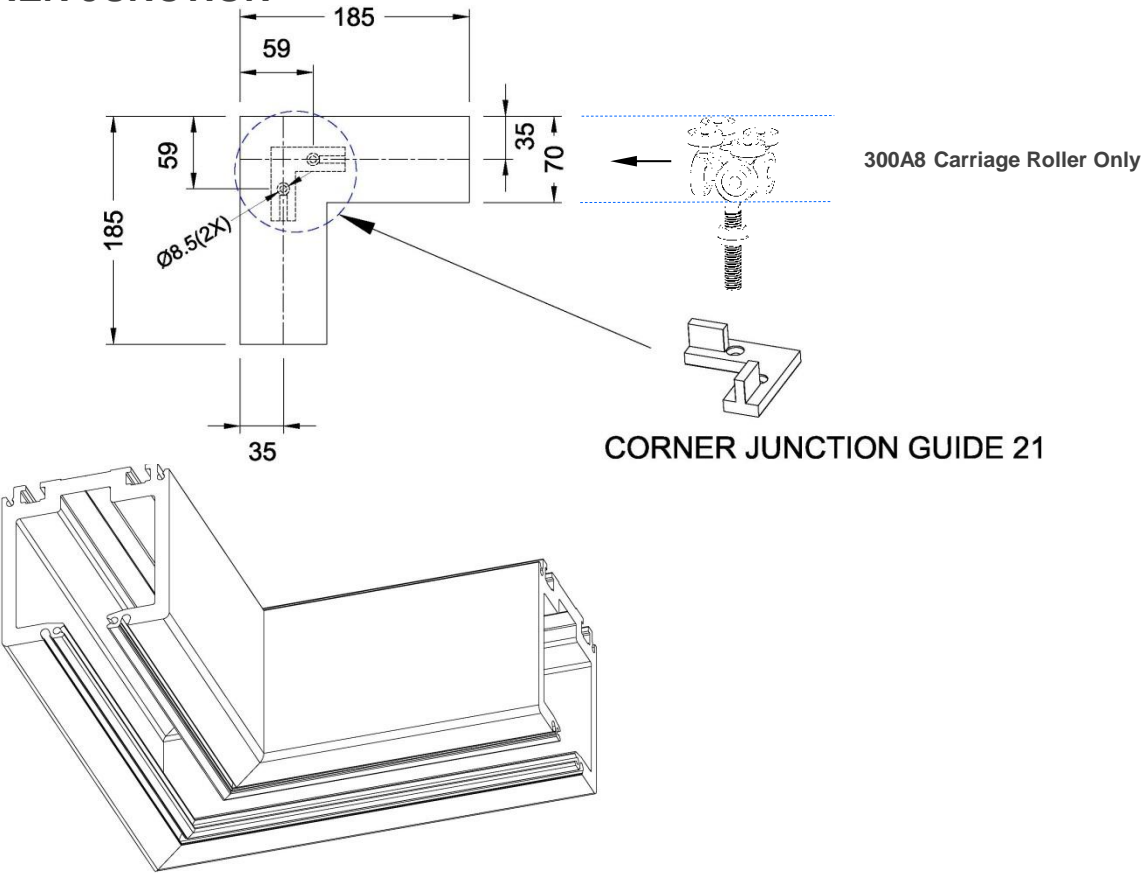

Accessories

E2474 – Main Top Track

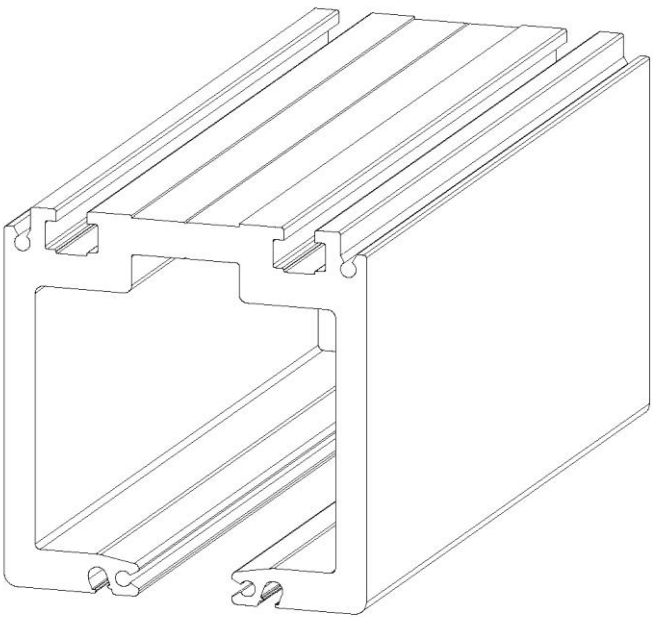
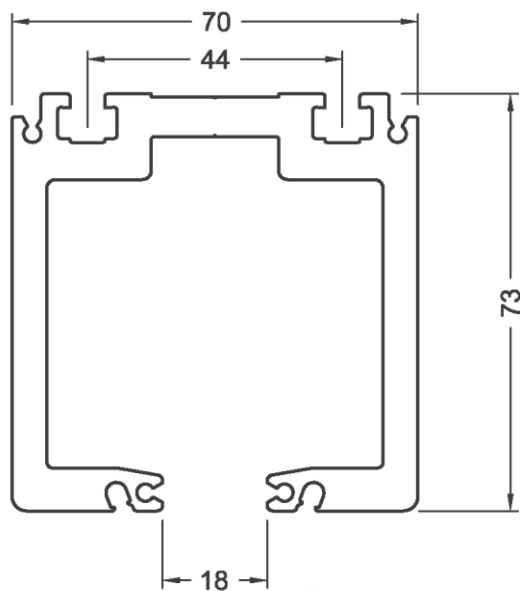

300A8 – 8pt Carriage Roller with Slider

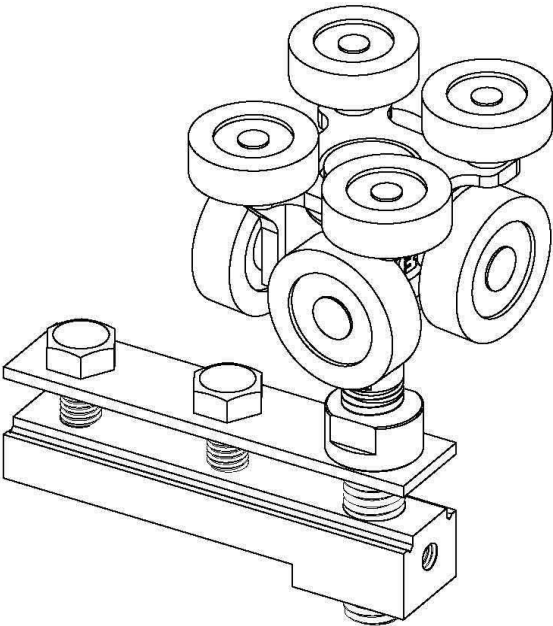

300B8 – 8pt Carriage Roller with Slider

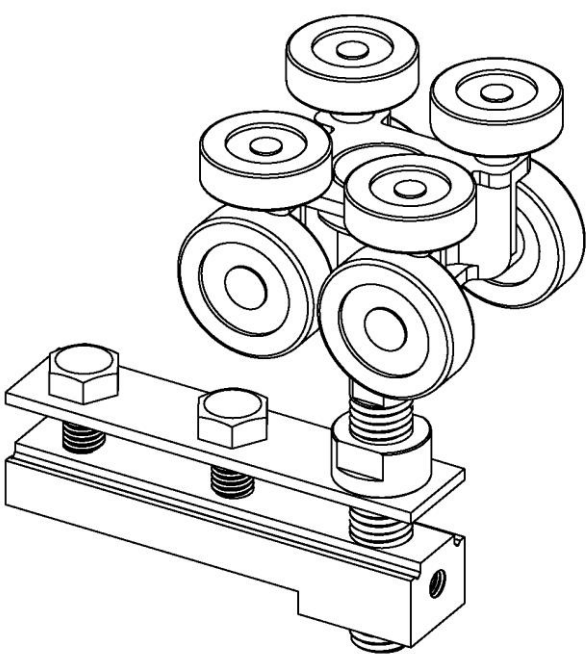

Top Accessories

End Cap

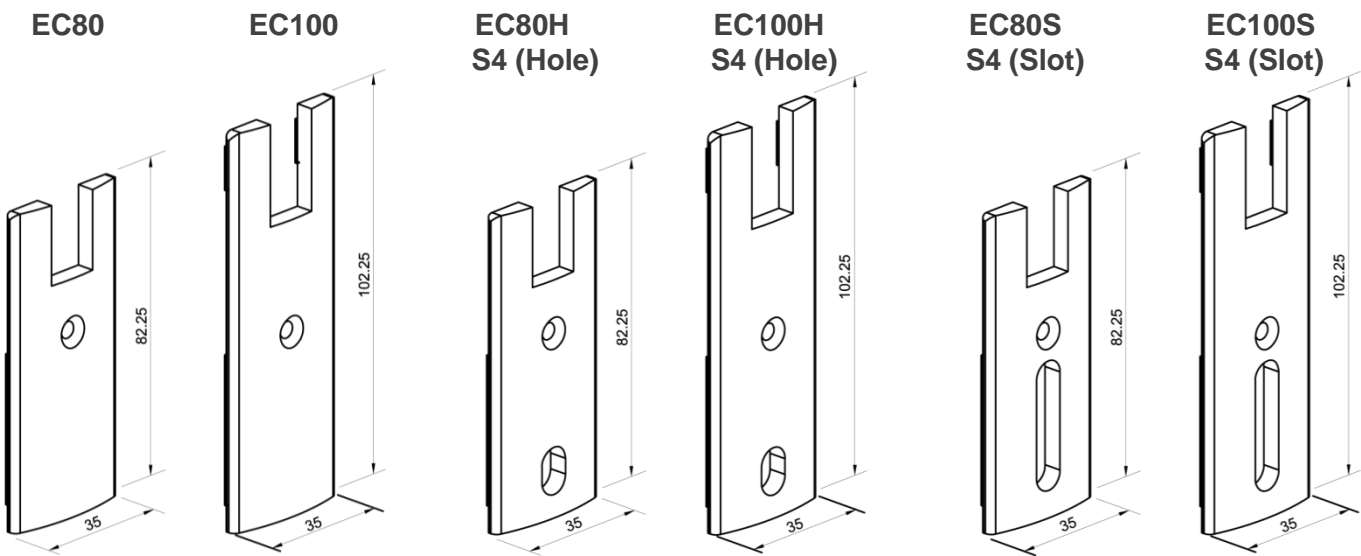

7322 – Rubber Seal

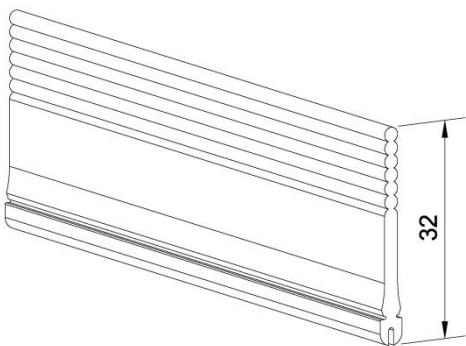

Bristle

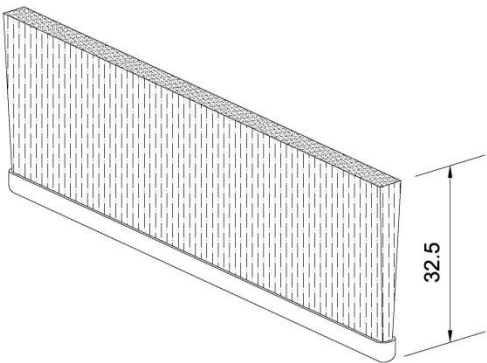

300TP – Top Pivot with Slider

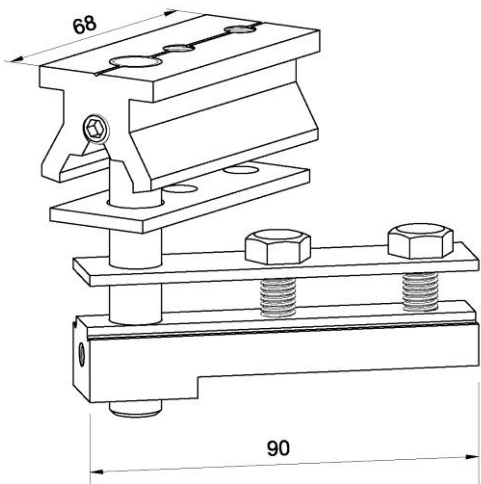

300ES – End Stopper

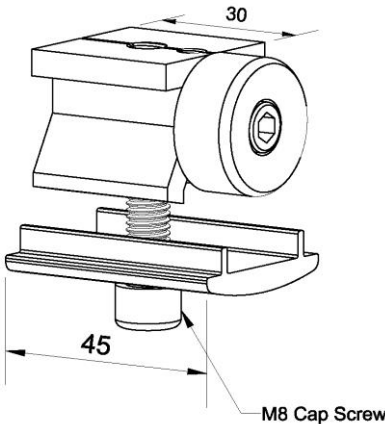

Bottom Accessories

S4 – End Flush Bolt

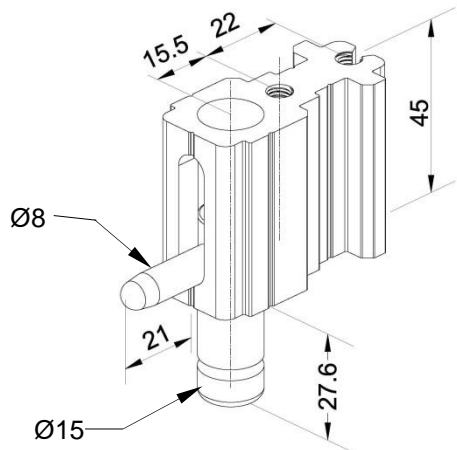

FB- Front Flush Bolt

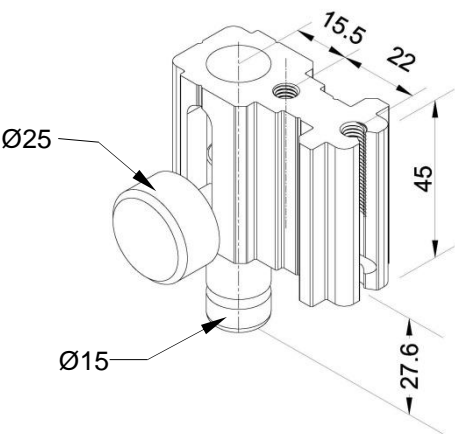

PL2 – Lock Bolt

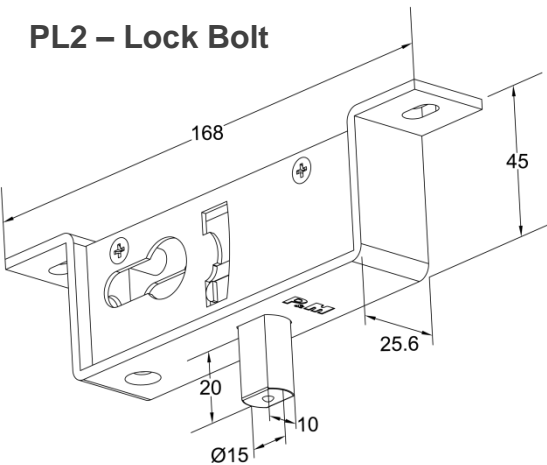

PD16 – Bottom Pivot

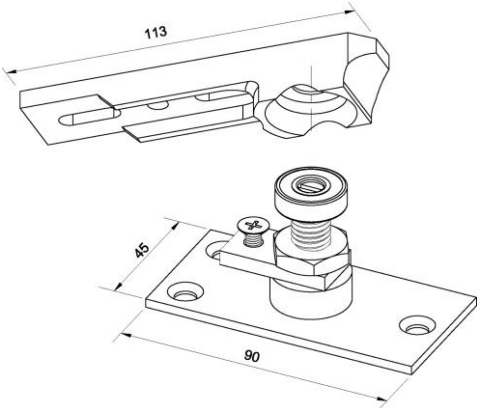

PM88 – Euro-Profile Key Cylinder

Available Length : (62mm; 42mm)

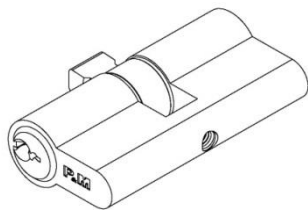

PM88T- Thumb Turn & Key Cylinder

Available Length : (62mm, 28mm Thumb Turn Only)

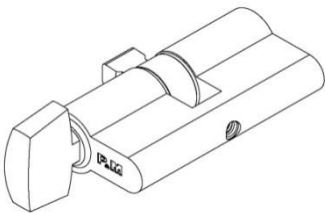

9001 – Bolt Keeper

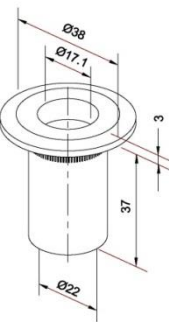

9001WS – Bolt Keeper with Spring

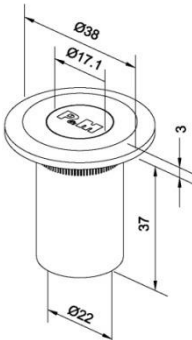

9002 – Eccentric Bolt Keeper

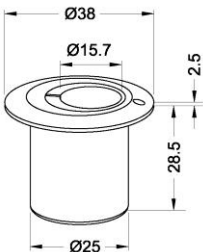

Also Available

SLF400

Slide and Fold Glass Panels System

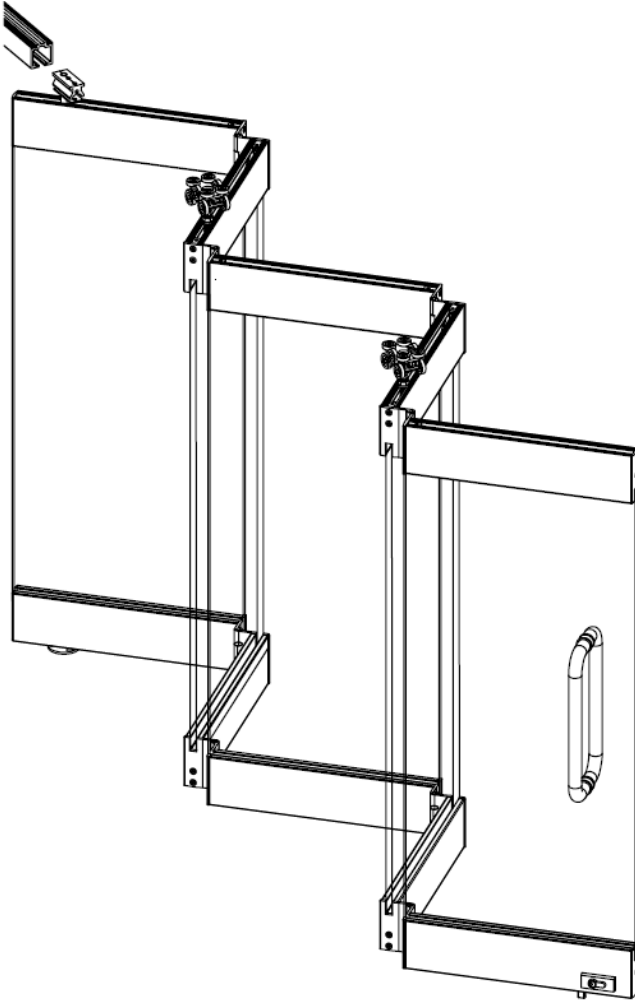

Related Products



Door Handles – Melosa Series



Door Knobs – Cerise Series

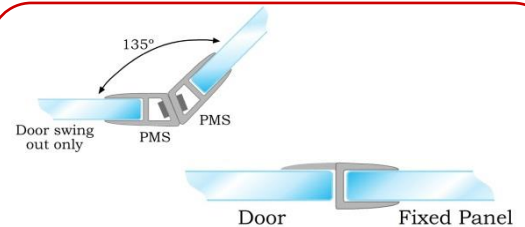

Vinyl Clip Seals – Deane Series

1 Preference
The Preferred Name in Entrance Systems

Preference Pte Ltd

No.2 Kallang Pudding Road #01-02 Mactech Building Singapore 349307

Tel: (65) 6746 5185 Fax: (65) 6746 8749 Email: enquiry@preference.com.sg Website: www.preference.com.sg