

Glass Thickness	8 - 12 mm Glass Thickness
Material	SUS304 Stainless Steel
Product Finish	Satin Stainless Steel
Revision	Update Drawing

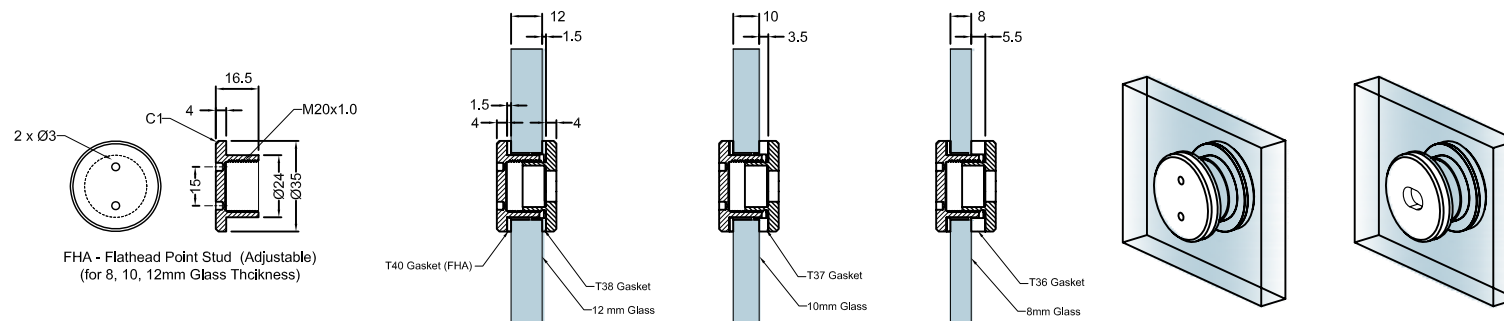

FHA - Flathead Point Stud (Adjustable)
(for 8, 10, 12mm Glass Thickness)

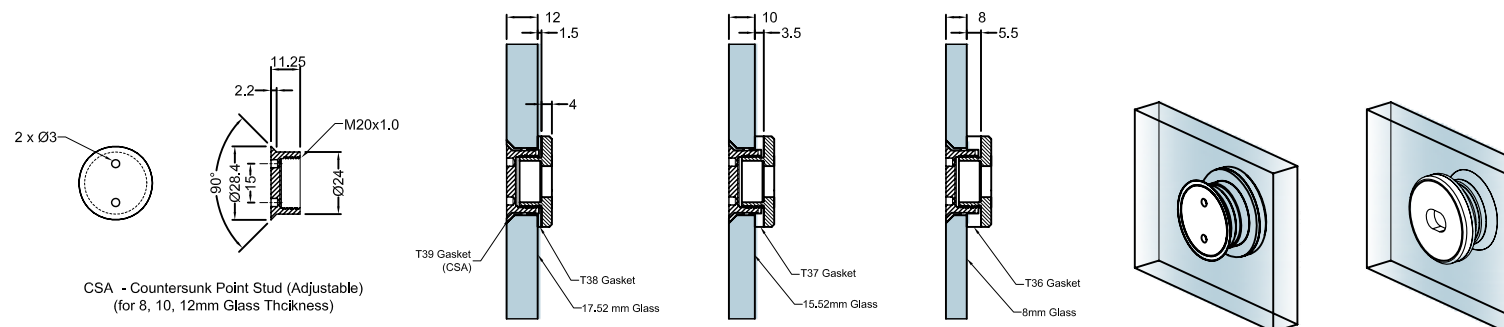

CSA - Countersunk Point Stud (Adjustable)
(for 8, 10, 12mm Glass Thickness)

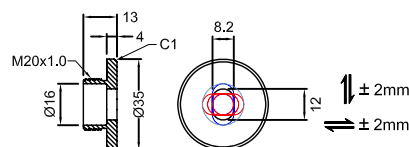

Point Stud (Adjustable)

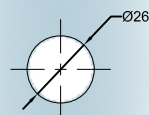

Glass Preparation for Flathead Point Stud
Glass Thickness (8,10,12,mm)

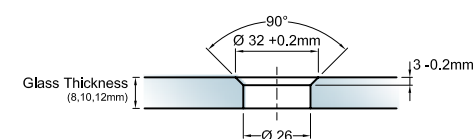

Glass Preparation for Countersunk Point Stud

ROUND GASKET MODEL	
FHA Gasket	T40 1.5
CSA Gasket	T39 5.85
for 12mm Glass Thickness	T38 1.5
for 10mm Glass Thickness	T37 3.5
for 8mm Glass Thickness	T36 5.5

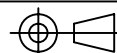

Glass Thickness	8 - 12 mm Glass Thickness
Material	SUS304 Stainless Steel
Product Finish	Satin Stainless Steel
Revision	Update Drawing

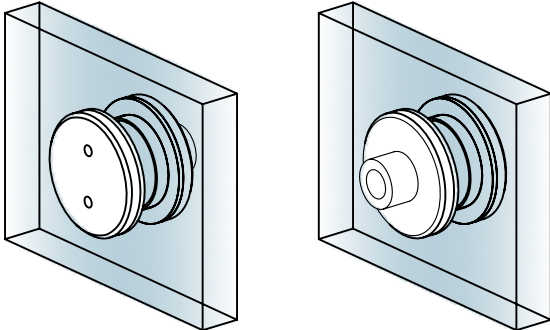
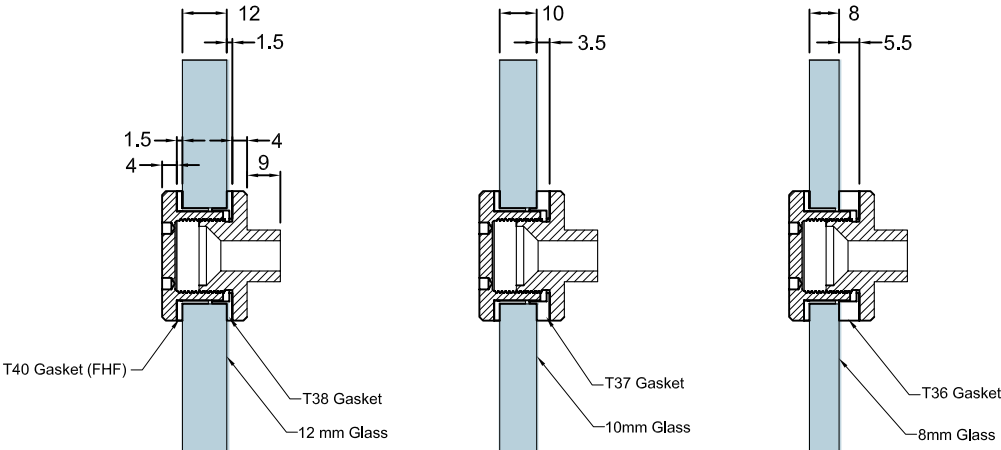
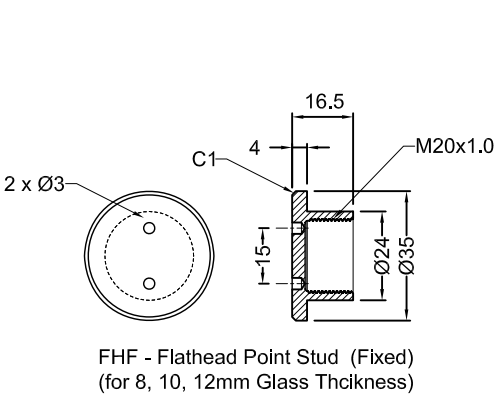

ROUND GASKET MODEL	
FHF Gasket	T40 1.5
CSF Gasket	T39 5.85
for 12mm Glass Thickness	T38 1.5
for 10mm Glass Thickness	T37 3.5
for 8mm Glass Thickness	T36 5.5

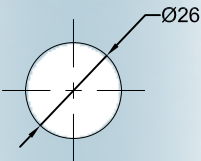
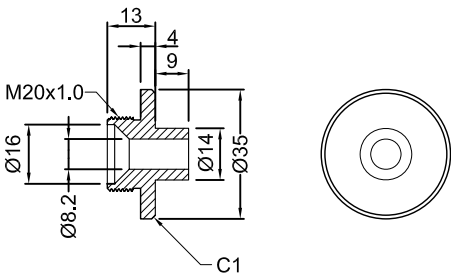
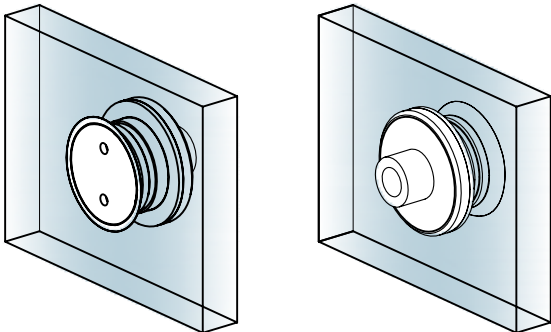
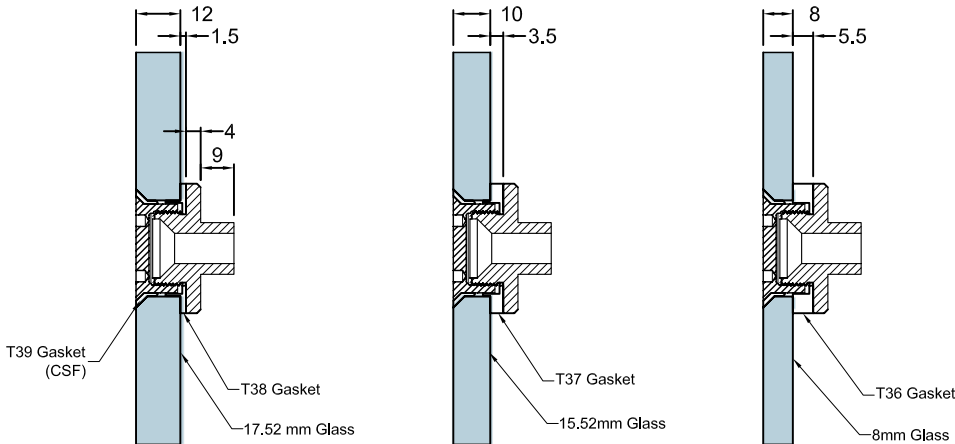
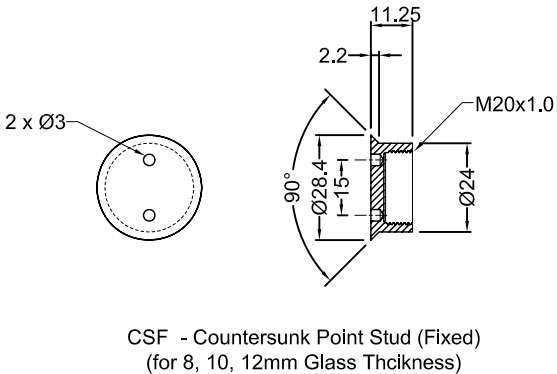

Glass Preparation for Flathead Point Stud
Glass Thickness (8,10,12,mm)

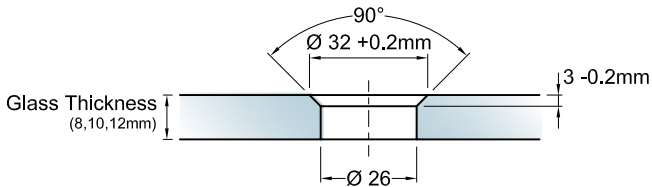

Glass Preparation for Countersunk Point Stud

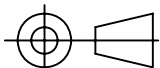
 <p>Preference Pte. Ltd. www.preference.com.sg</p>	Model: FHF - FLATHEAD POINT STUD (FIXED) CSF - COUNTERSUNK POINT STUD (FIXED)	Disclaimer: This drawing shows the actual stage of product development at the date indicated. No claims or damages in any form can be made against Preference Pte. Ltd. as a result of the interpretation of this drawing. This drawing remains the property of Preference Pte. Ltd. and is made available to third parties only for the duration of contractual obligations. All rights connected with this drawing remain in possession of Preference Pte. Ltd. This drawing may not be copied or handed over to third parties without the express consent of Preference Pte. Ltd.
	Art. No. 	
Date : 08-MAY-2013		

Glass Thickness	8 - 12 mm Glass Thickness
Material	SUS304 Stainless Steel
Product Finish	Satin Stainless Steel
Revision	Update Drawing

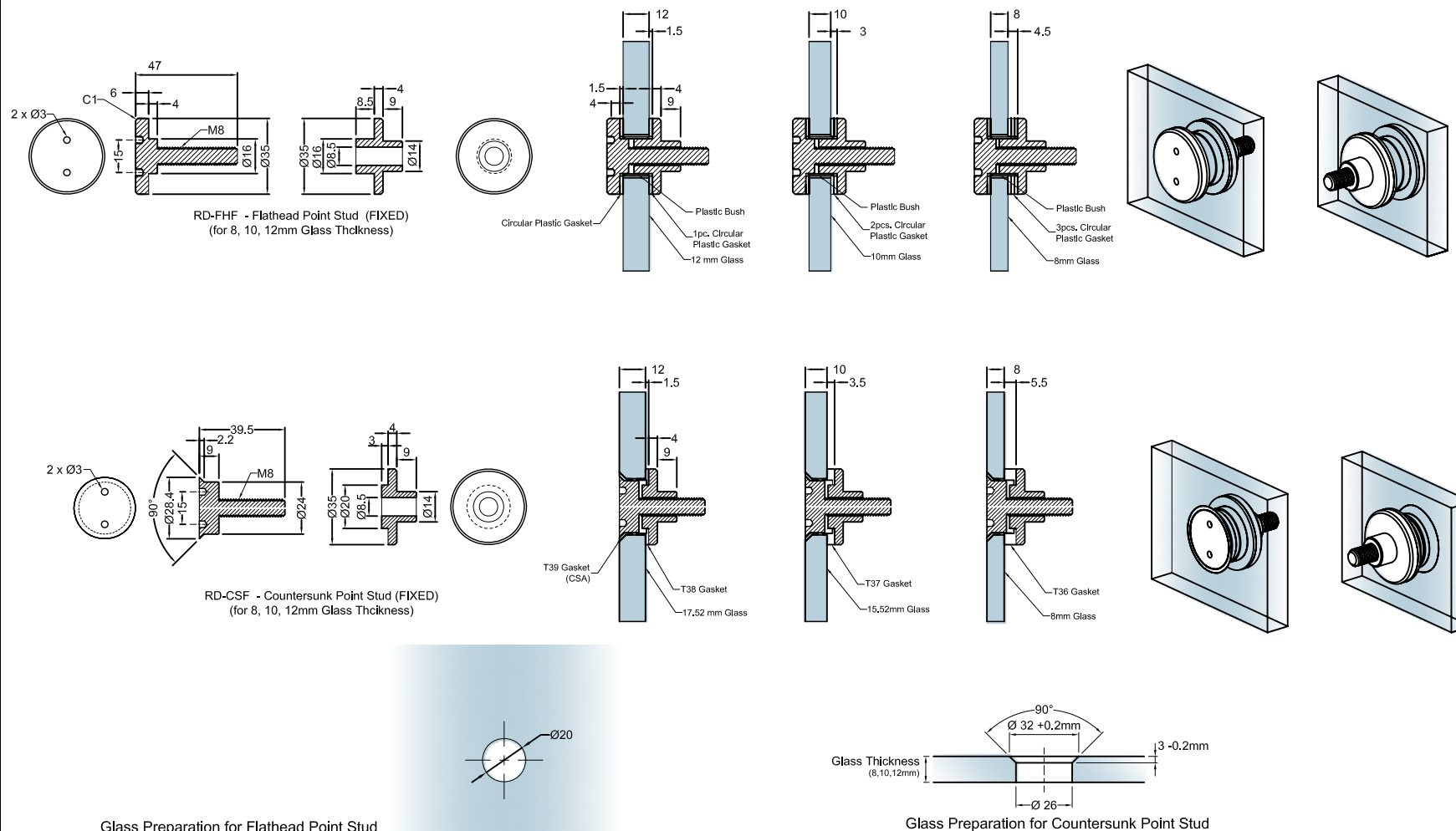

ROUND GASKET MODEL	
RD-CSF Gasket	T39 5.85
for 12mm Glass Thickness	T38 1.5
for 10mm Glass Thickness	T37 3.5
for 8mm Glass Thickness	T36 5.5
Circular Plastic Gasket	Ø18.2 Ø35 1.5
Plastic Bush	Ø16.2 11 Ø18

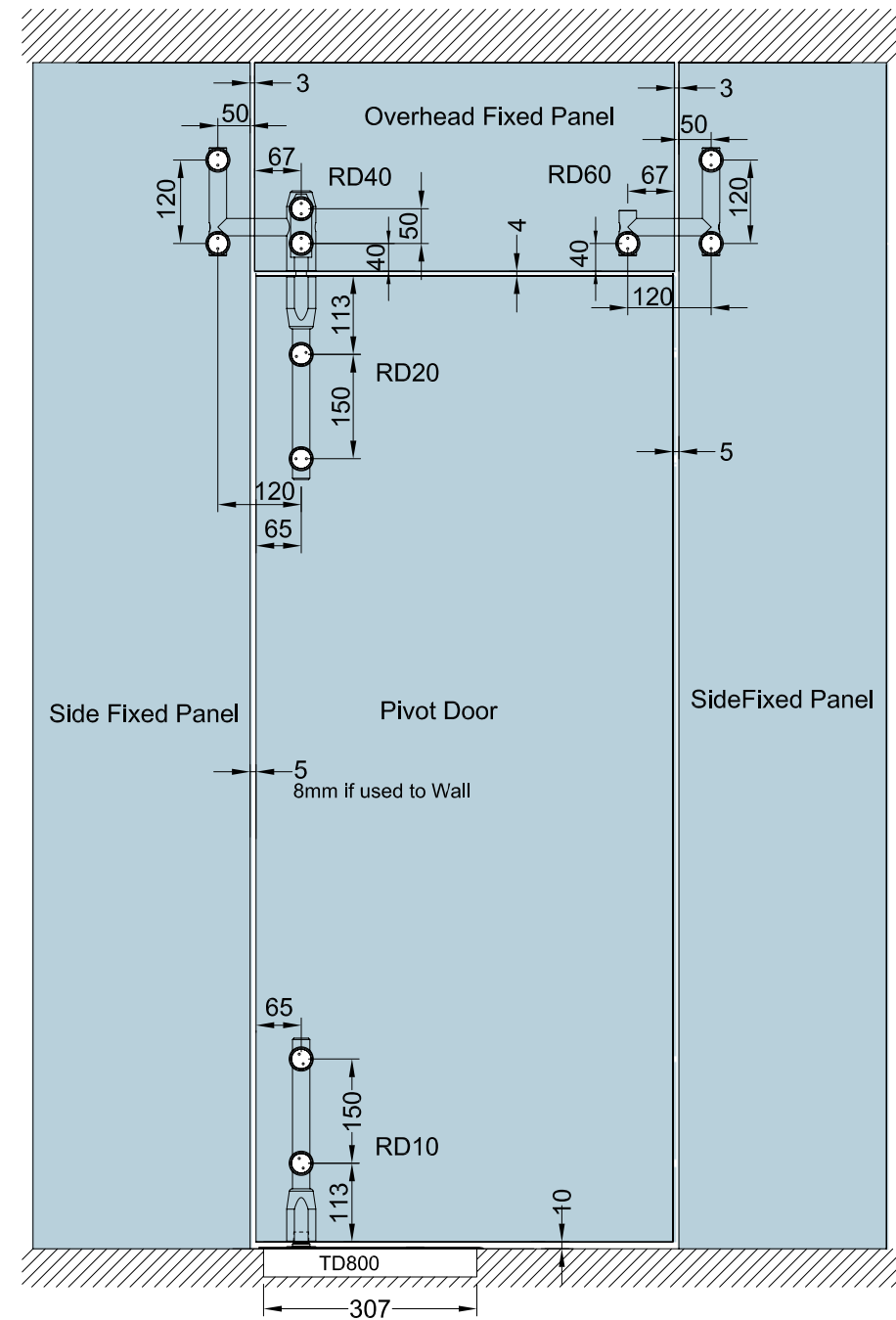

ELEVATION

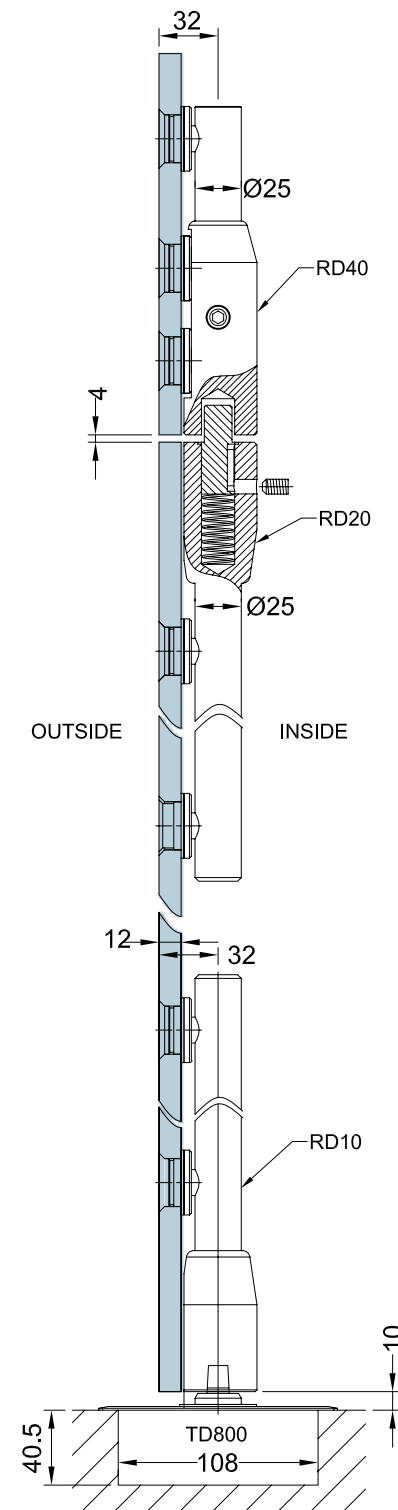

CROSS SECTION

RD UNIT	Point Stud	Qty.
RD10	RD-CSF / RD-FHF	2
RD20	RD-CSF / RD-FHF	2
RD30	CSA / FHA	2
RD40	CSA / FHA	4
RD60	CSA / FHA	3

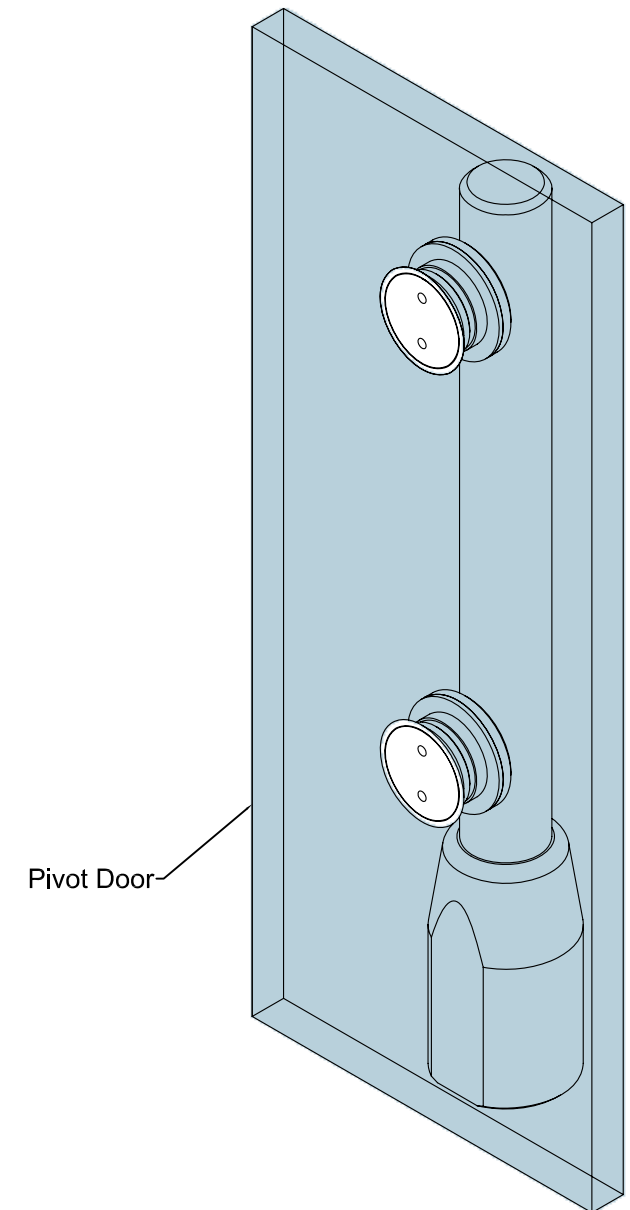
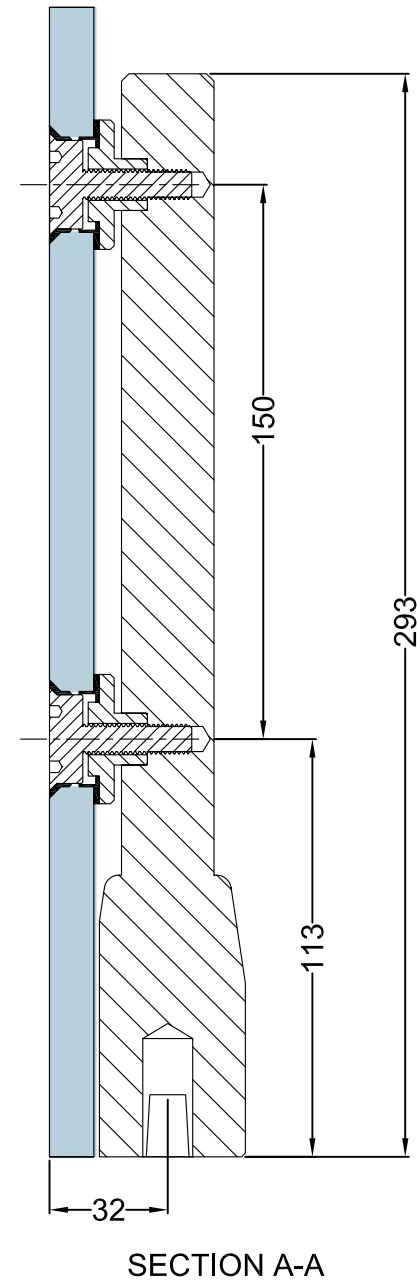
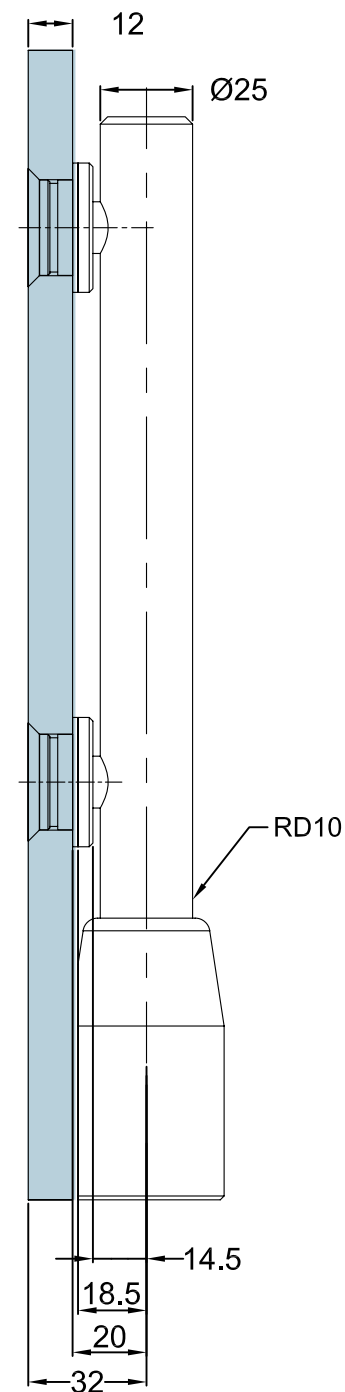
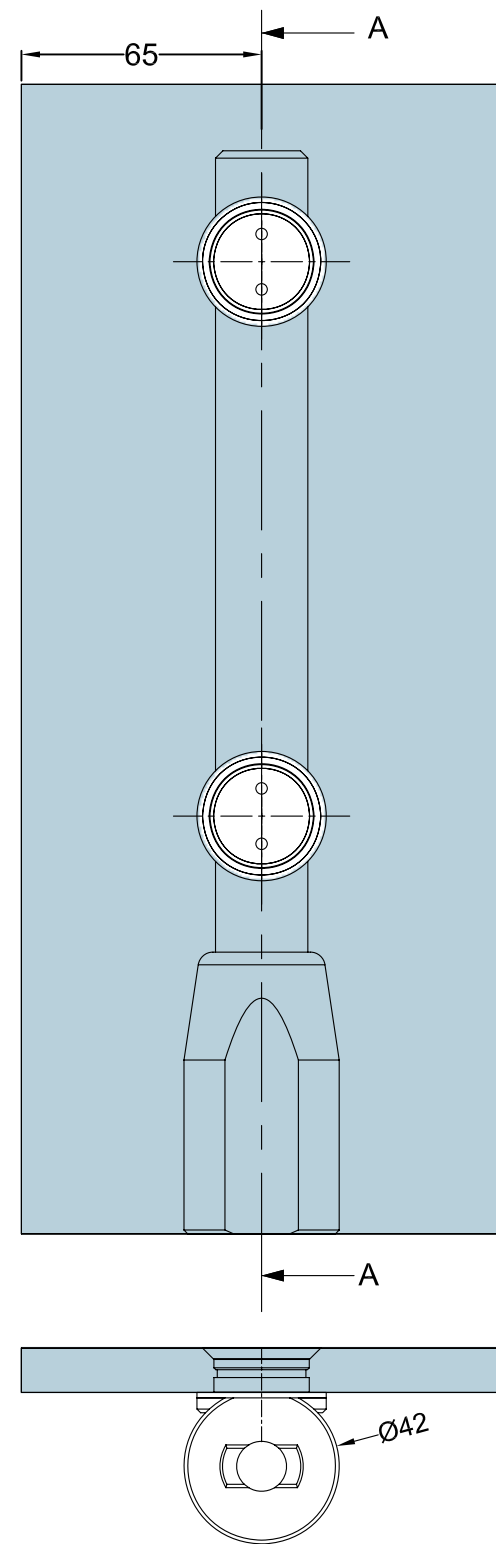

Note:
Must use 2pcs. of RD-CSF / RD-FHF Point Studs

PIVOT DOOR WALL FIXING

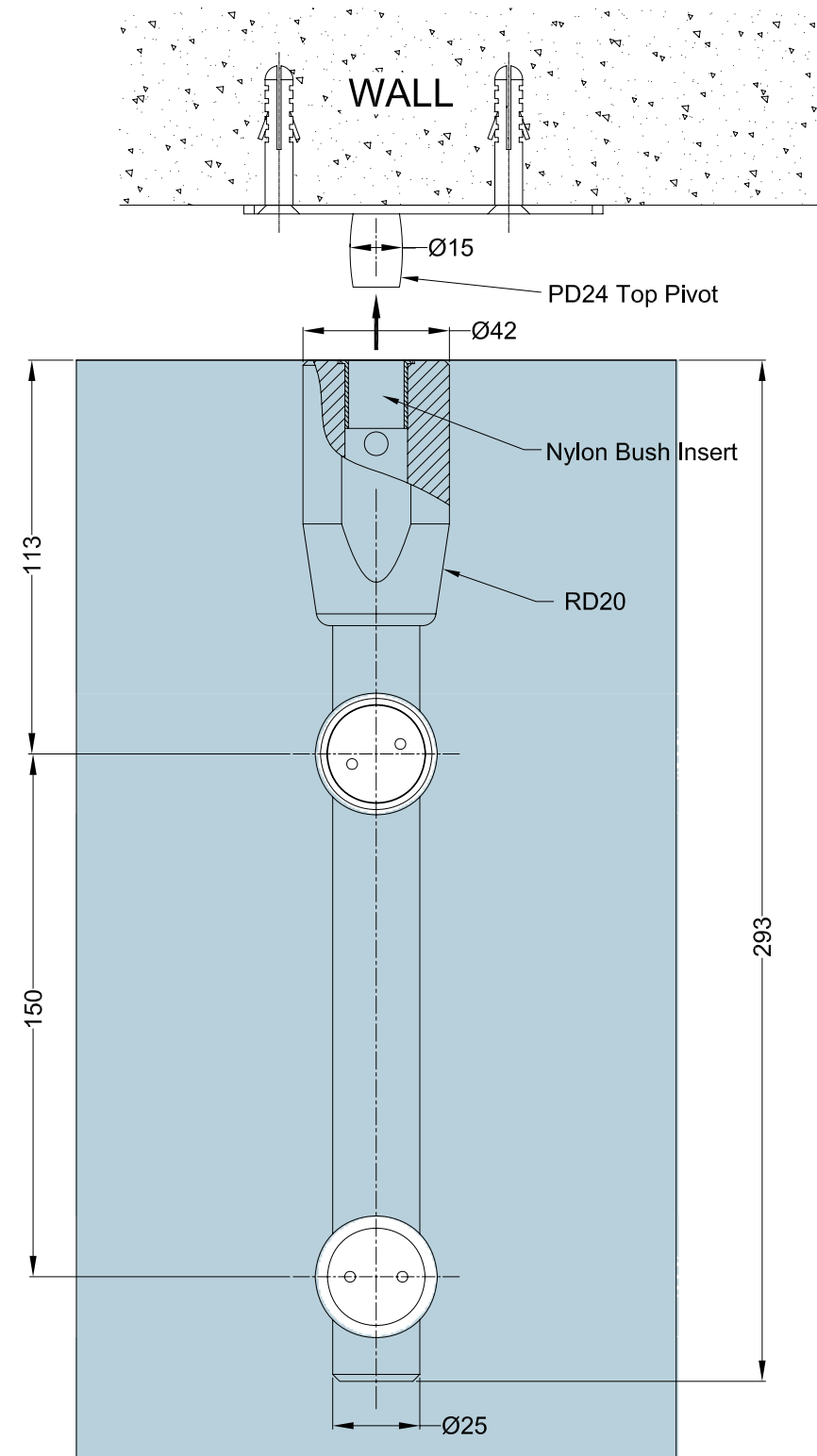

PIVOT DOOR WALL FIXING

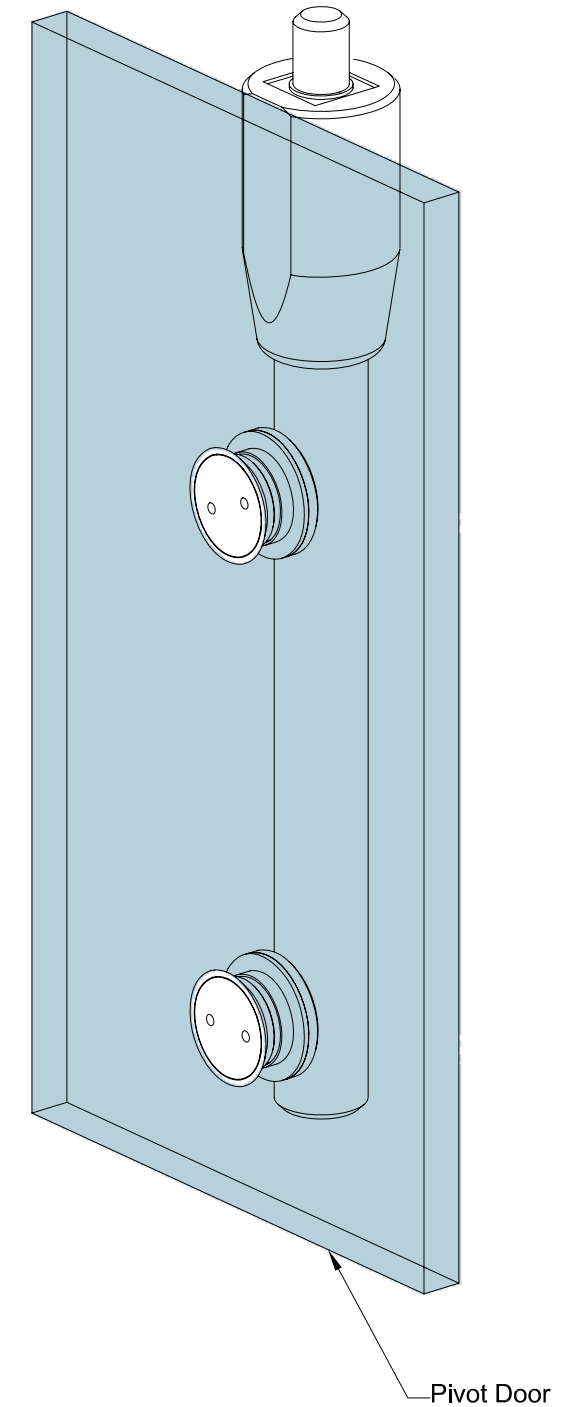
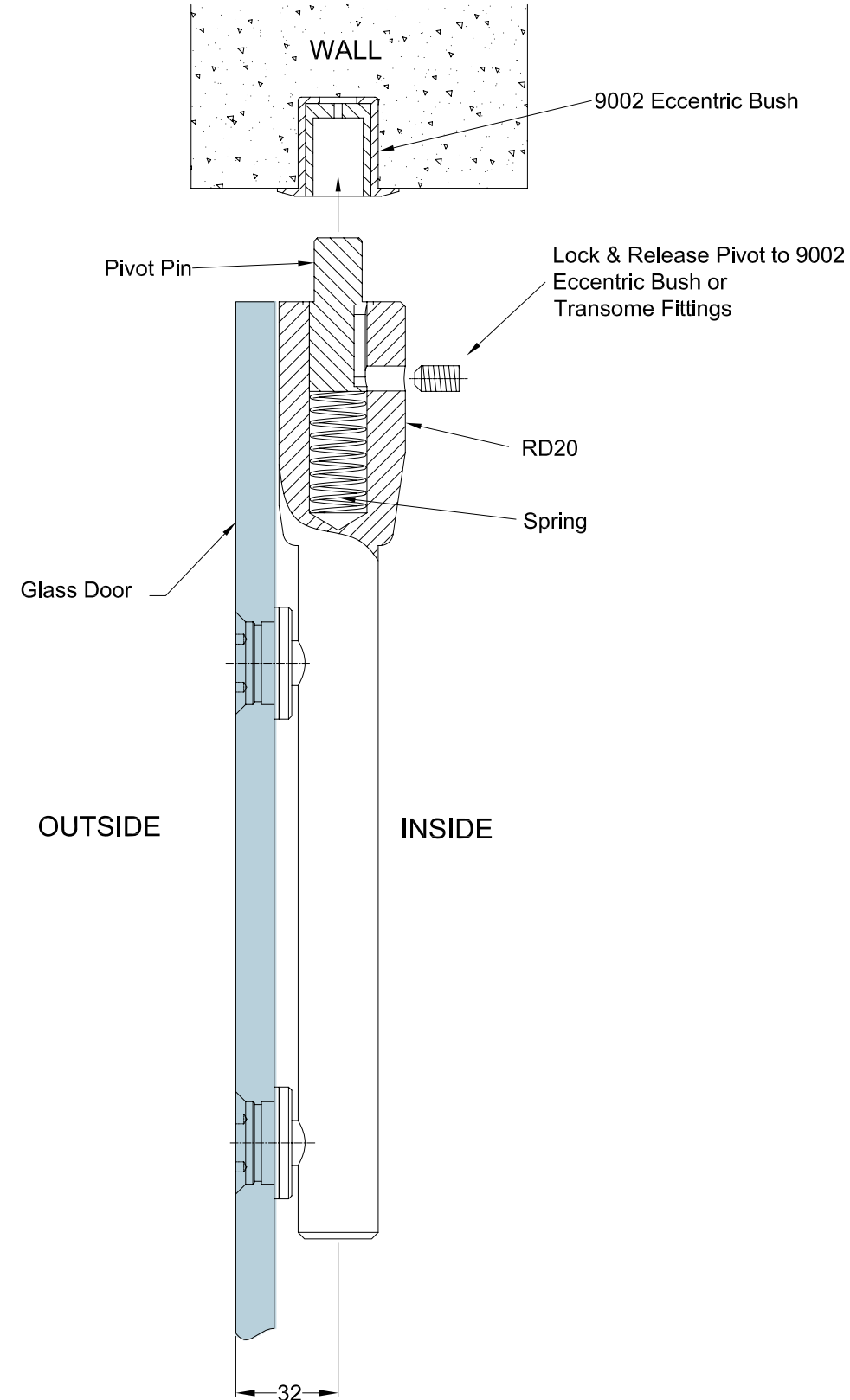

Note:
Must use 2pcs. of RD-CSF / RD-FHF Point Studs

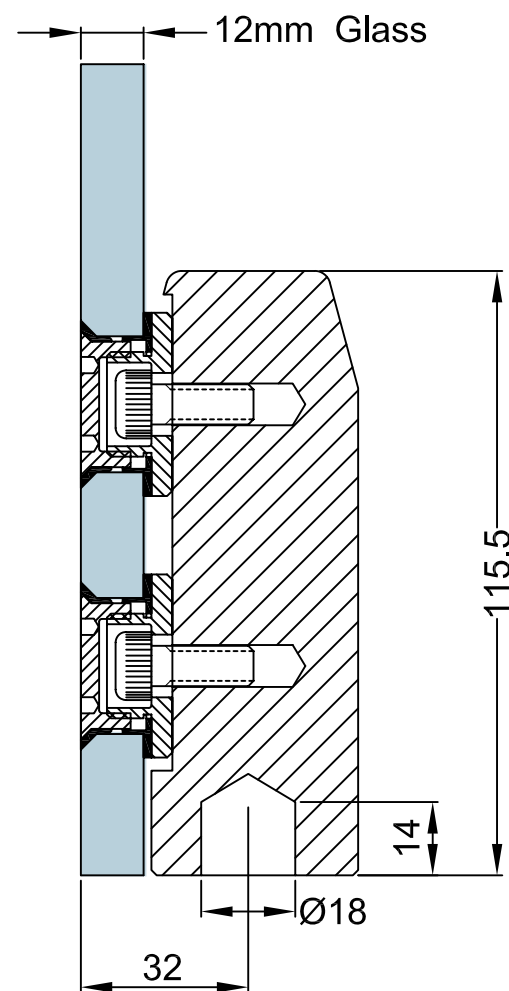
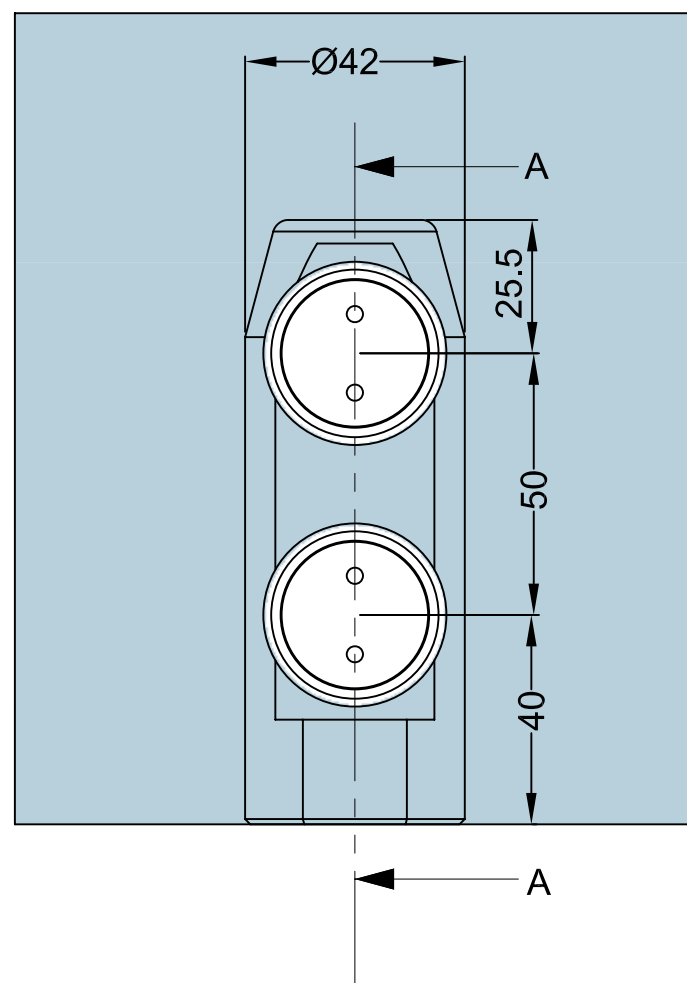
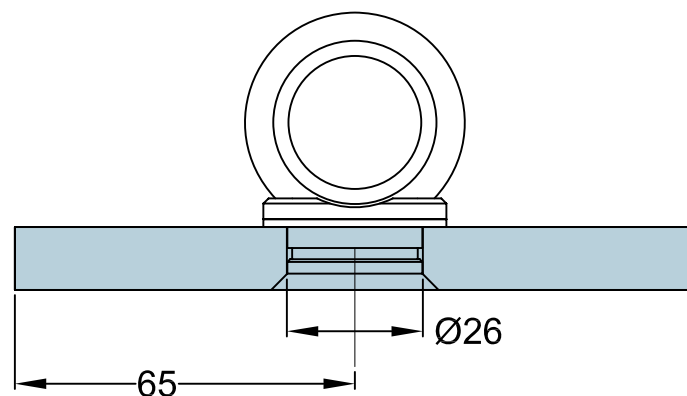

SECTION A-A

Overhead Fixed Glass

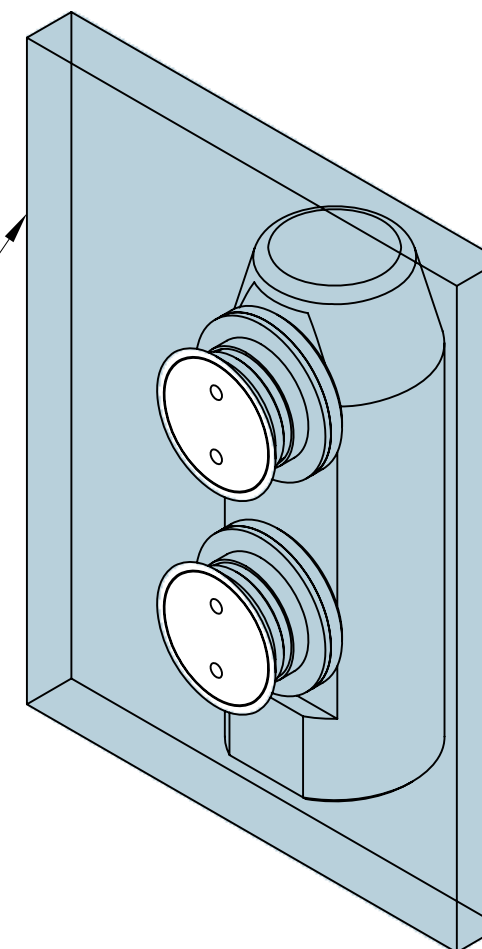

Note:
Must use 2pcs. of CSA / FHA Point Studs

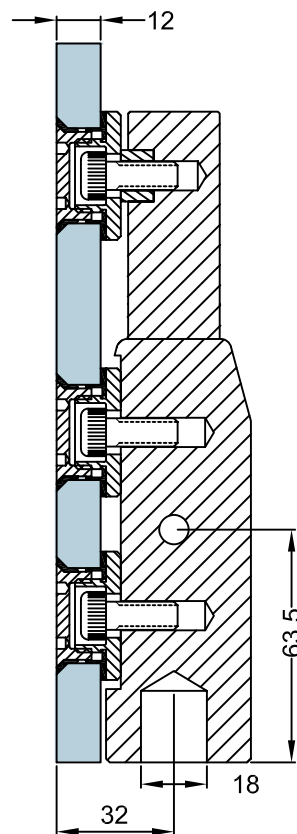
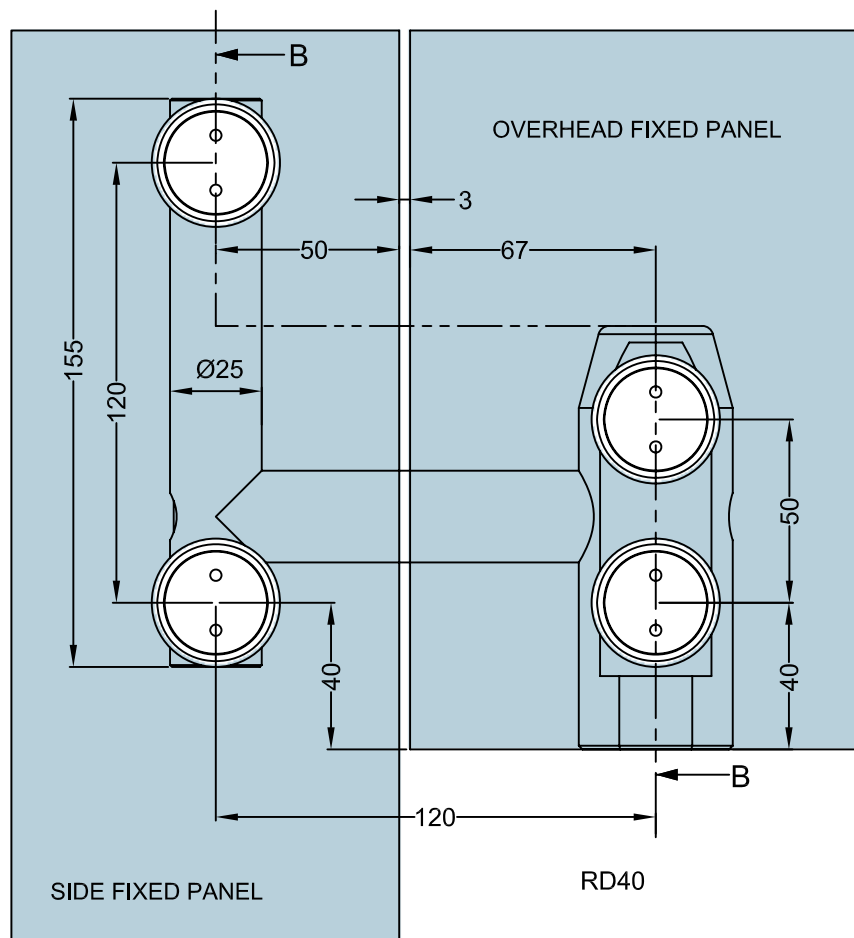

SECTION B-B

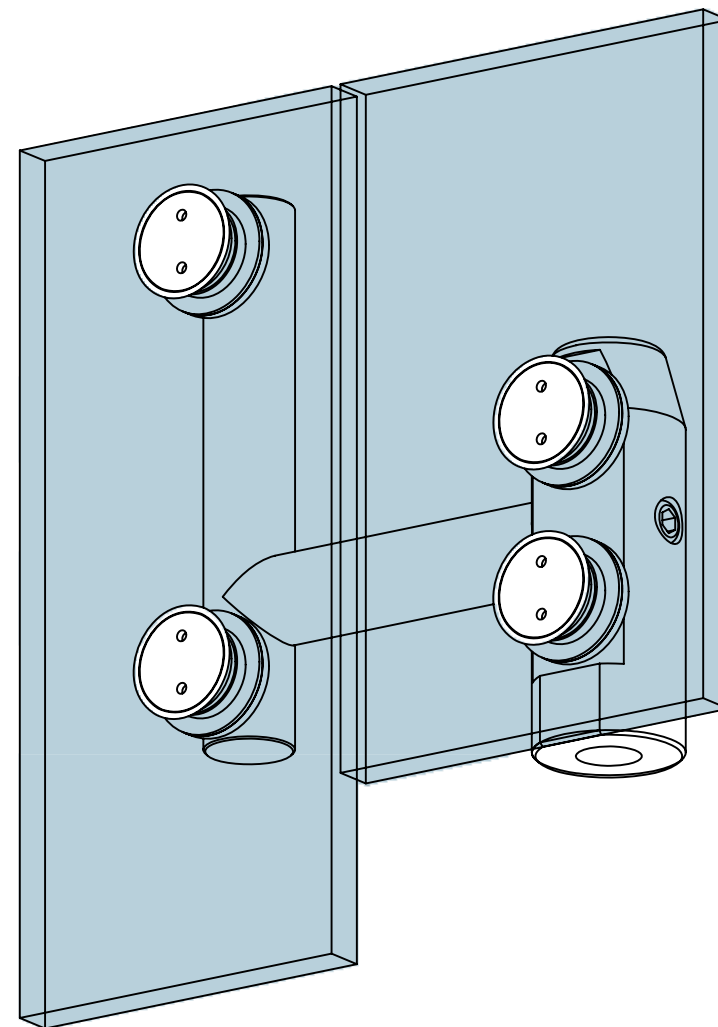

Note:
Must use 4pcs. of CSA / FHA Point Studs



Preference Pte. Ltd.
www.preference.com.sg

Model: Magtec RD40 Over Panel & Side Panel Pivot

Art. No.

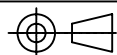

Date : 08-MAY-2013

Disclaimer:

This drawing shows the actual stage of product development at the date indicated. No claims or damages in any form can be made against Preference Pte. Ltd. as a result of the interpretation of this drawing. This drawing remains the property of Preference Pte. Ltd. and is made available to third parties only for the duration of contractual obligations. All rights connected with this drawing remain in possession of Preference Pte. Ltd. This drawing may not be copied or handed over to third parties without the express consent of Preference Pte. Ltd.

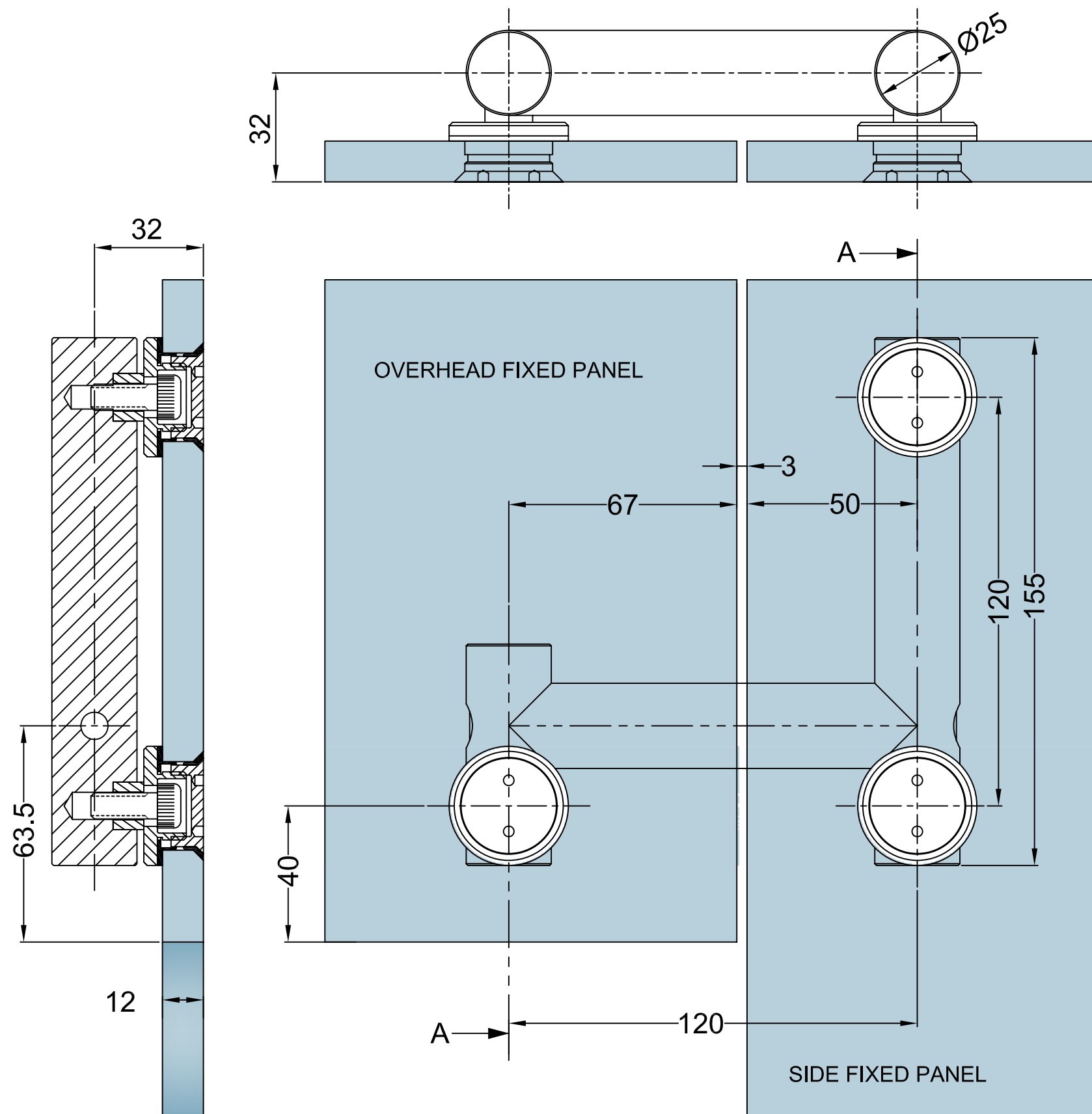

SECTION A-A

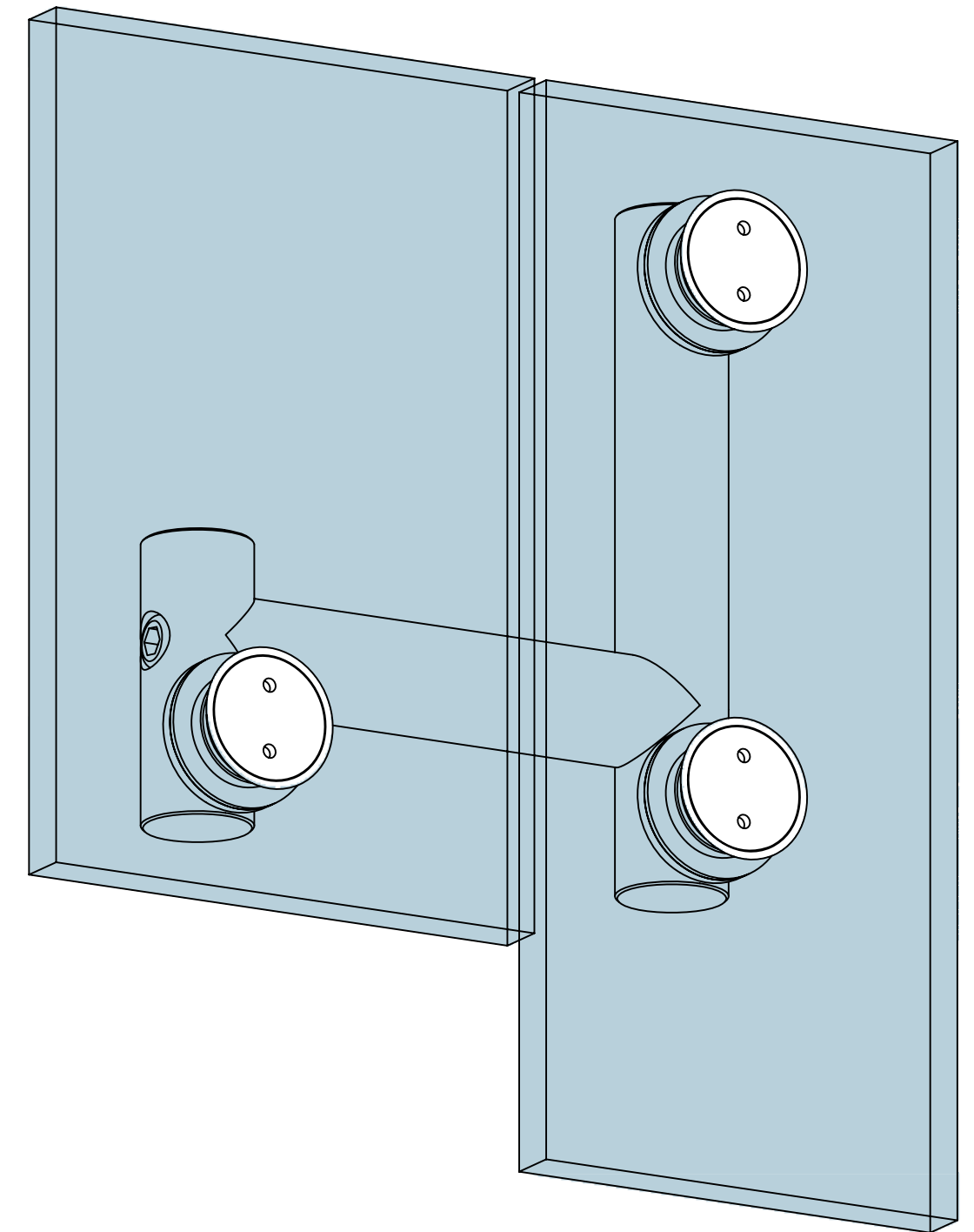

Note:
Must use 3pcs. of CSA / FHA Point Studs