

Glass Thickness	10 - 12 mm Glass Thickness
Material	Body: Aluminium Cover: Stainless Steel
Finishes	Polished Stainless Steel Satin Stainless Steel

To suit PD20 Top Patch

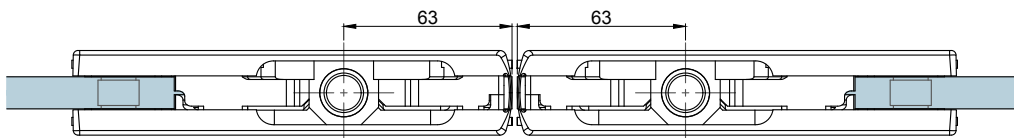

Glass Thickness
(10-12mm)

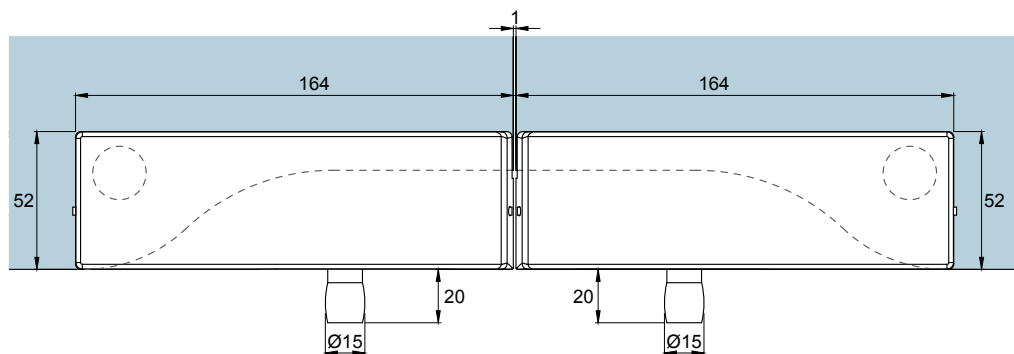
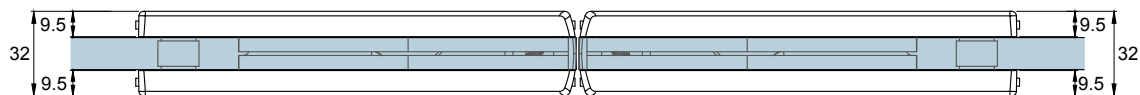
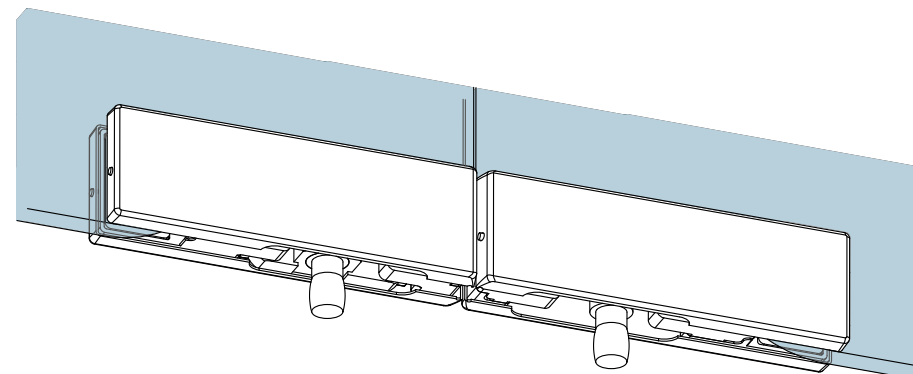
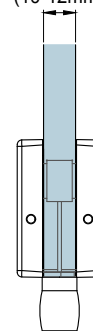

Glass Preparation

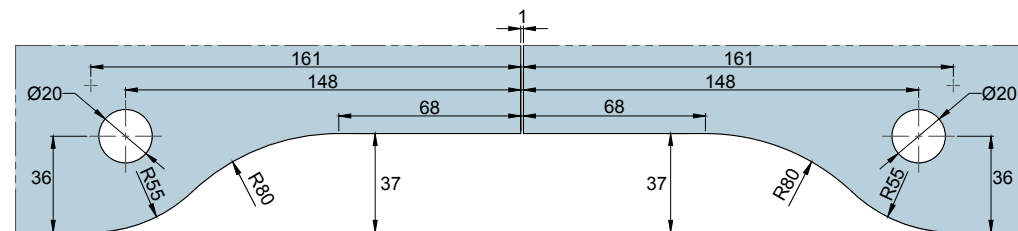

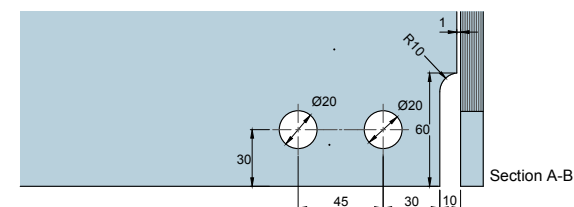
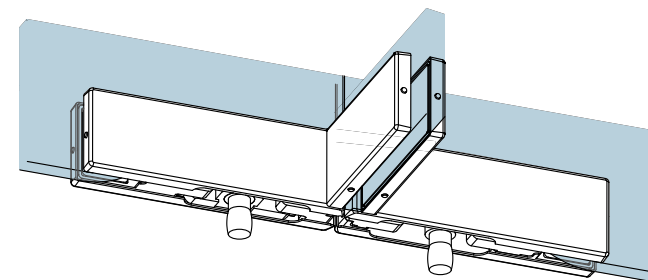
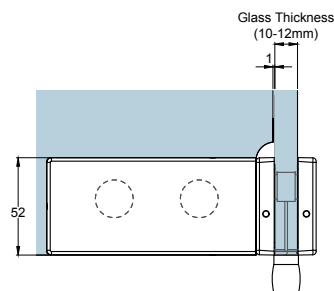
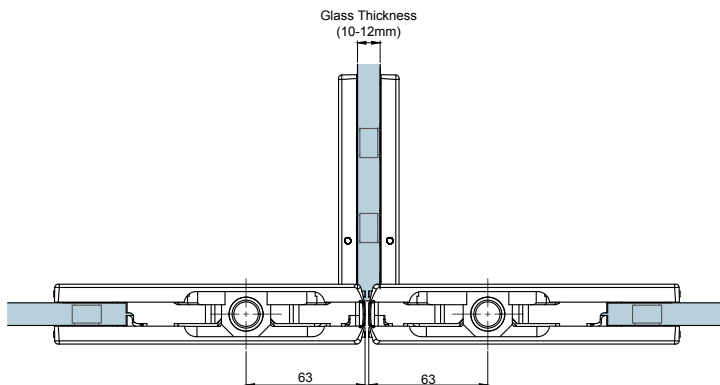
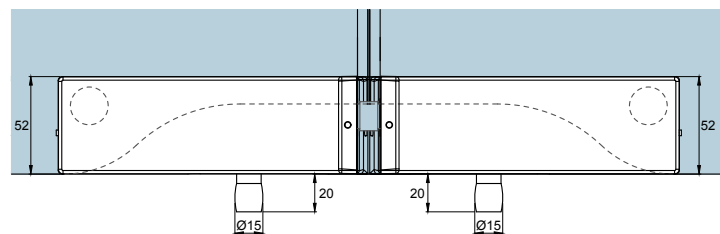
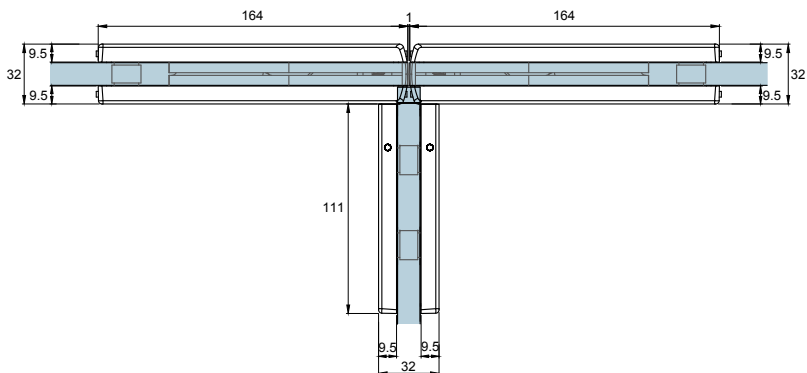

Glass Preparation for
Fin Fitting Attachment Panel

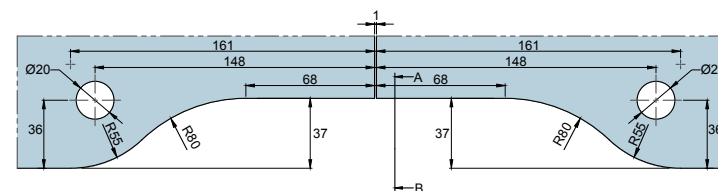

Glass Preparation for Overpanel

Glass Thickness	10 - 12 mm Glass Thickness
Material	Body: Aluminium Cover: Stainless Steel
Finishes	Polished Stainless Steel Satin Stainless Steel

To suit PD20 Top Patch

Glass Thickness	10 - 12 mm Glass Thickness
Material	Body: Aluminium Cover: Stainless Steel
Finishes	Polished Stainless Steel Satin Stainless Steel

Glass Thickness
(10-12mm)

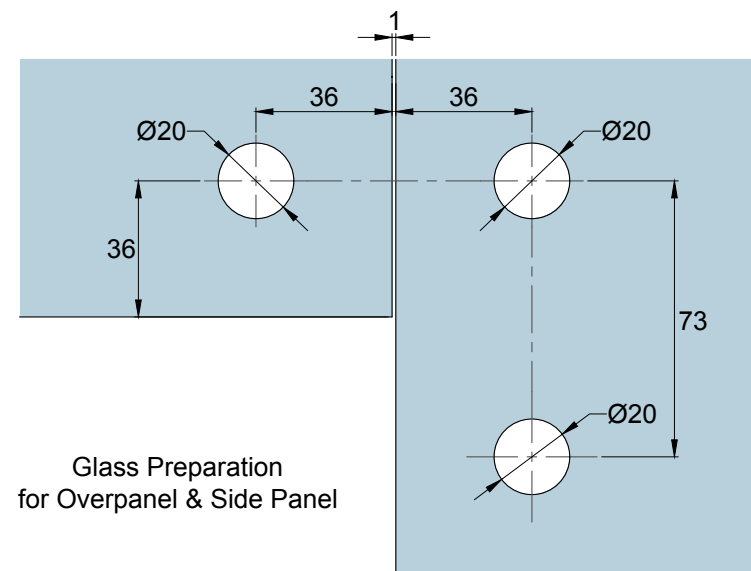
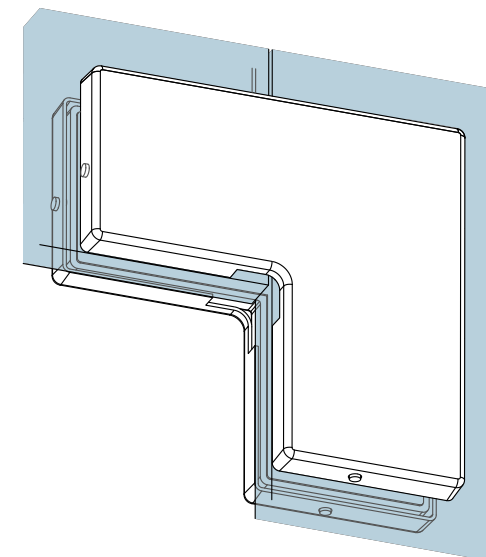
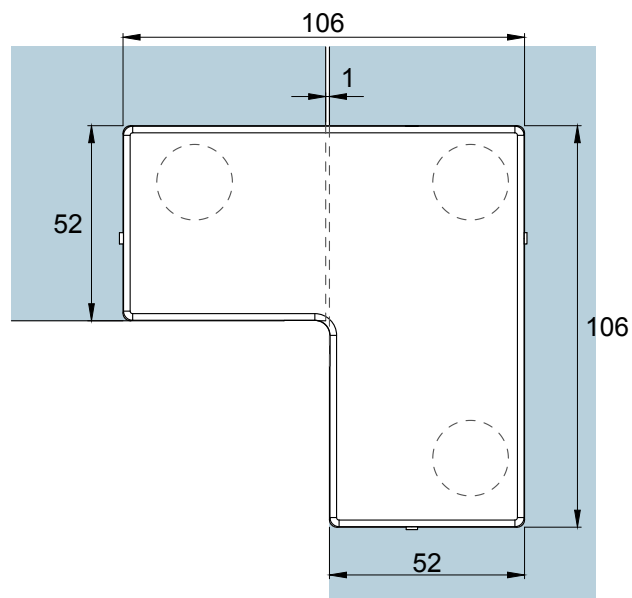
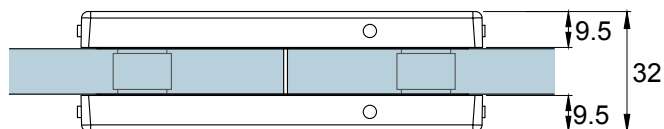
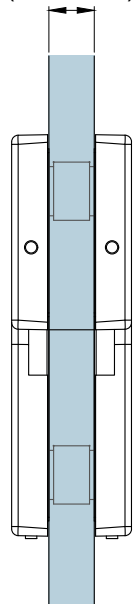

Glass Preparation
for Overpanel & Side Panel

Glass Thickness	10 - 12 mm Glass Thickness
Material	Body: Aluminium Cover: Stainless Steel
Finishes	Polished Stainless Steel Satin Stainless Steel

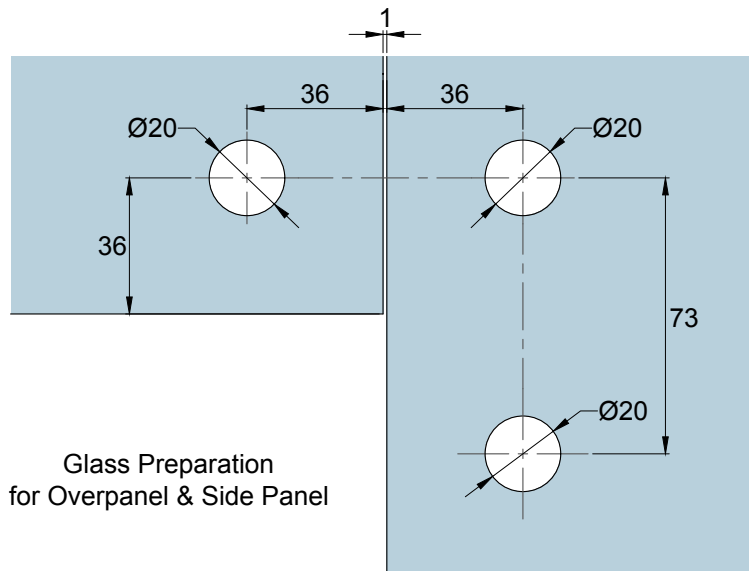
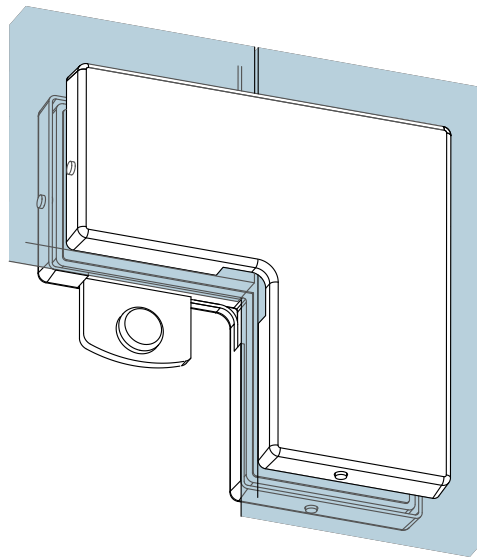
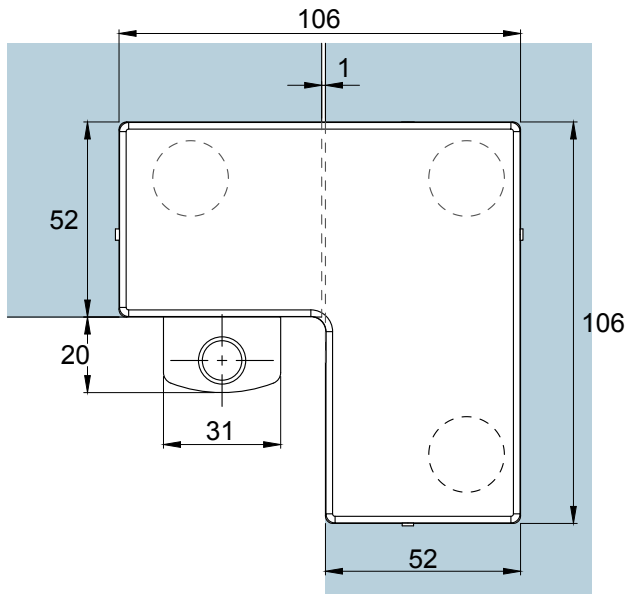
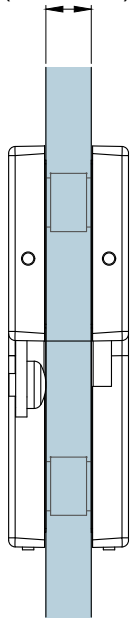
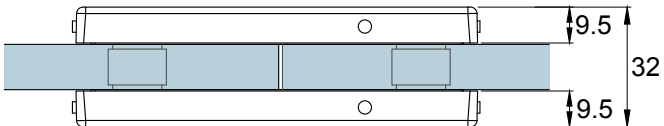

Glass Preparation for Overpanel & Side Panel

Glass Thickness	10 - 12 mm Glass Thickness
Material	Body: Aluminium Cover: Stainless Steel
Finishes	Polished Stainless Steel Satin Stainless Steel

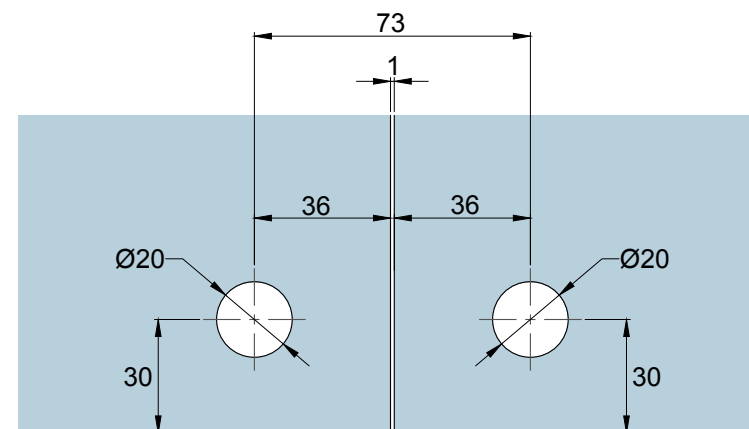
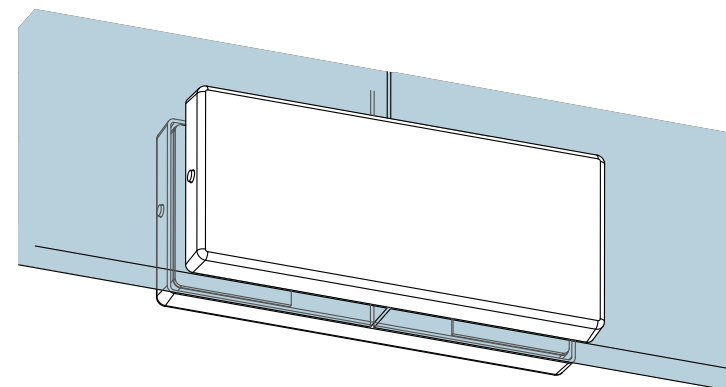
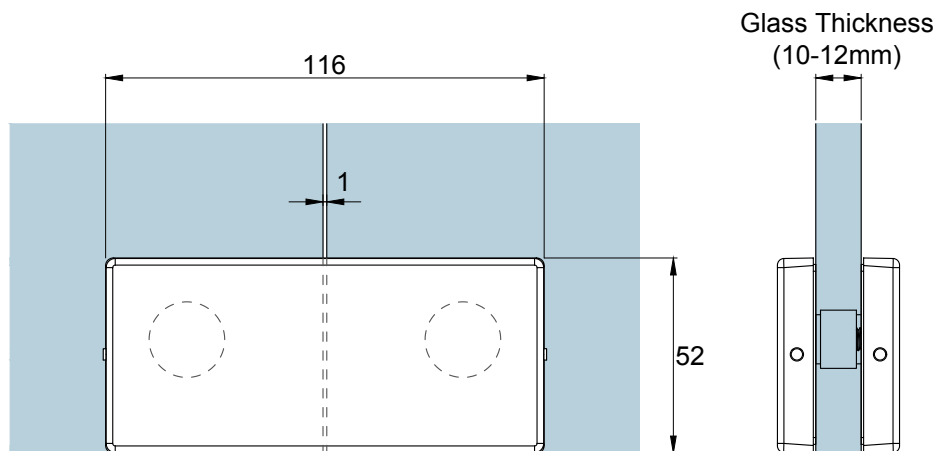
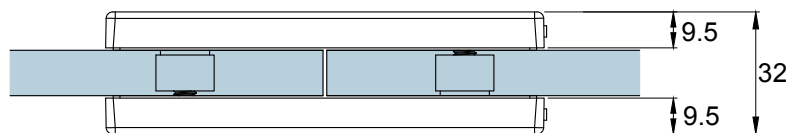

Glass Preparation

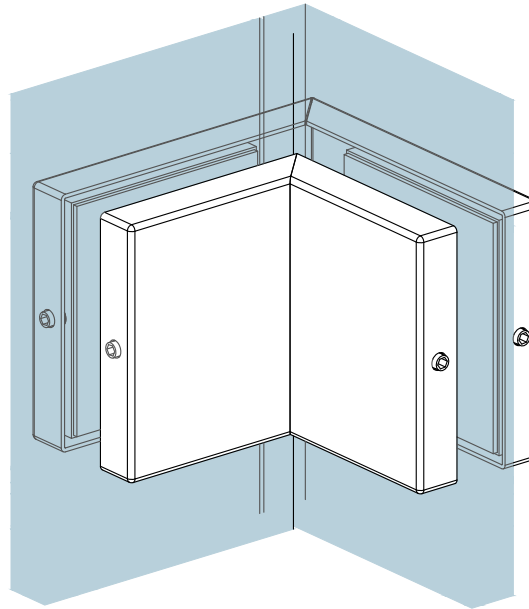
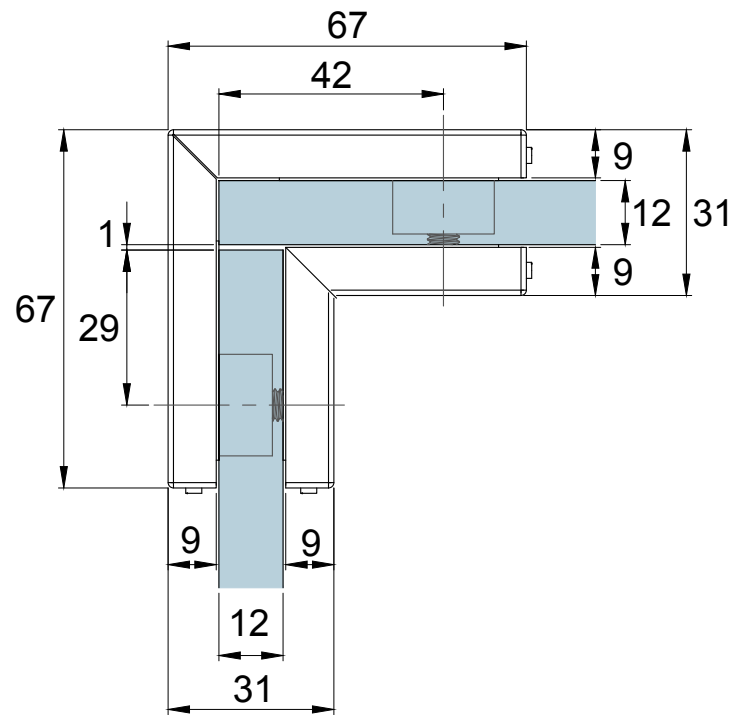

Glass Thickness	10 - 12 mm Glass Thickness
Material	Body: Aluminium Cover: Stainless Steel
Finishes	Polished Stainless Steel Satin Stainless Steel

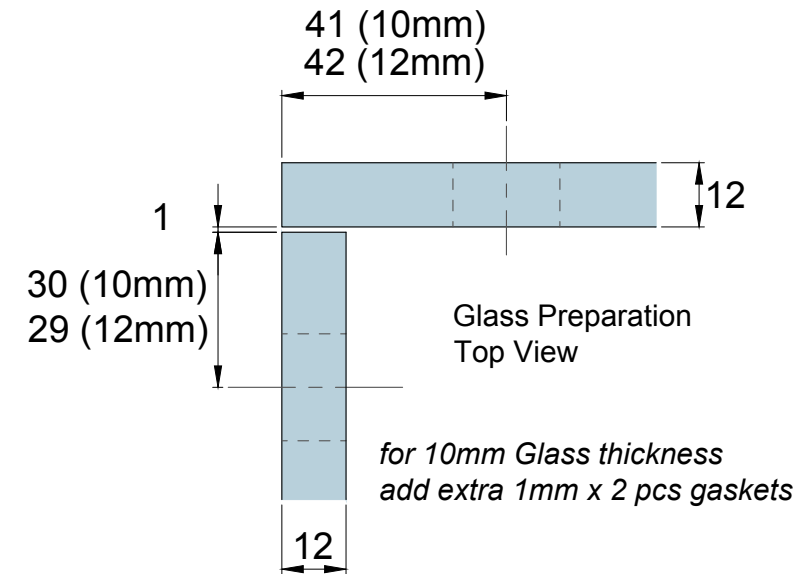

*for 10mm Glass thickness
add extra 1mm x 2 pcs gaskets*

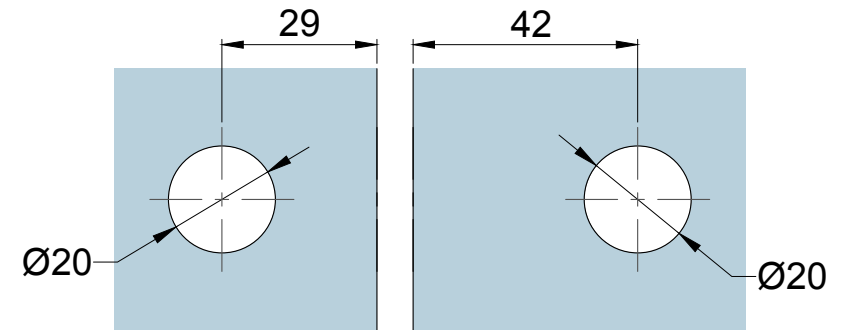
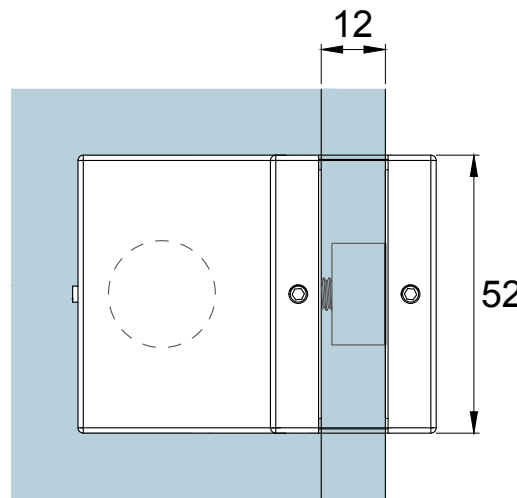
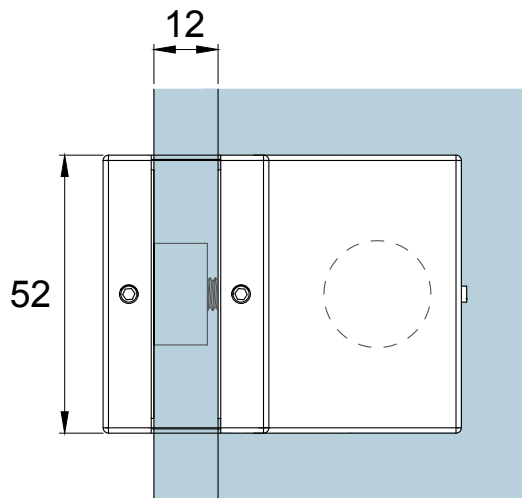

Glass Preparation
(12mm Glass Thickness)

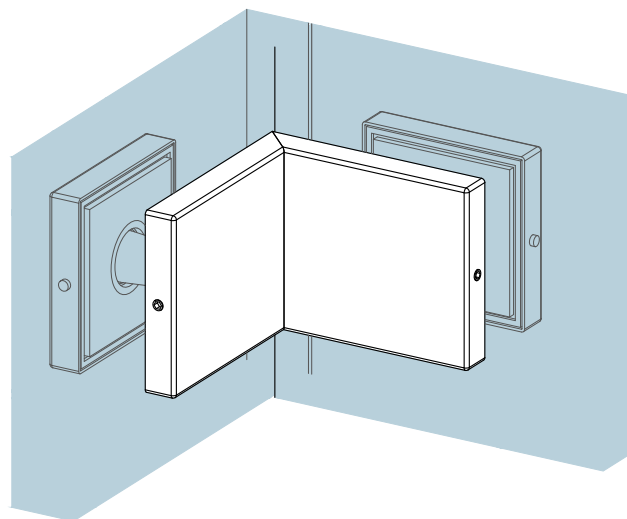
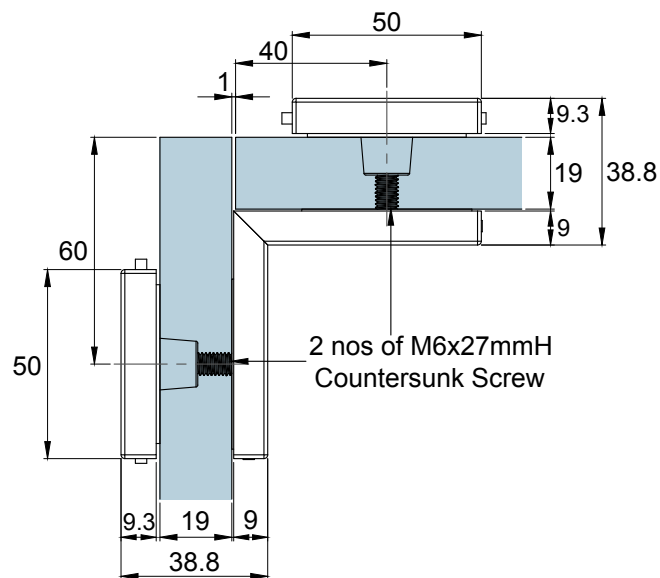

Glass Thickness	15 - 19 mm Glass Thickness
Material	Body: Aluminium Cover: Stainless Steel
Finishes	Polished Stainless Steel Satin Stainless Steel

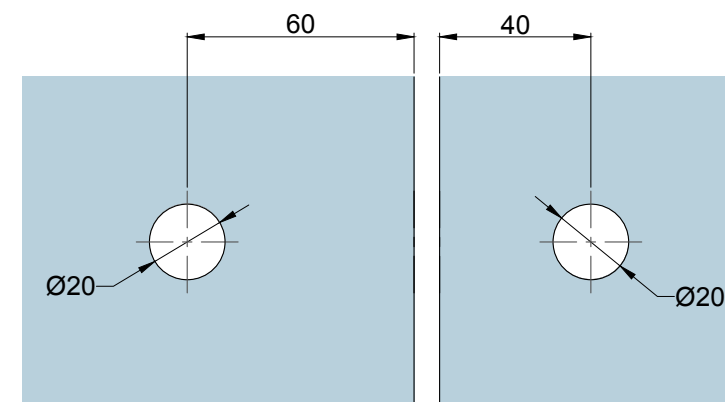
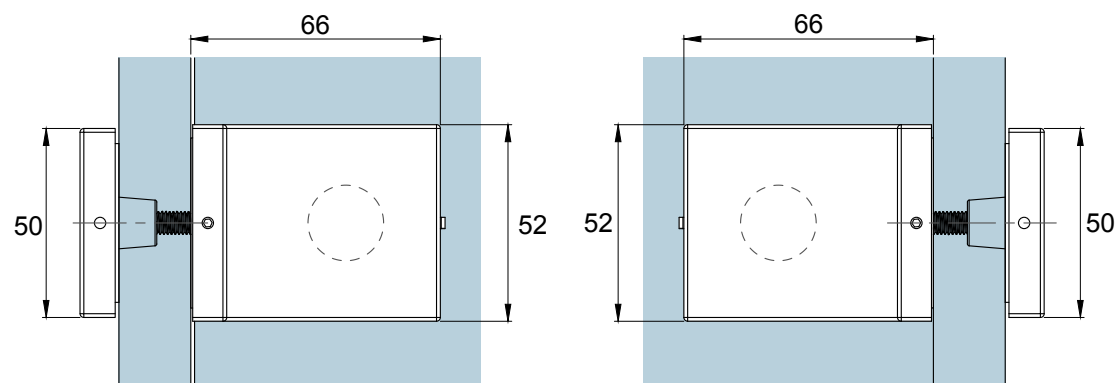
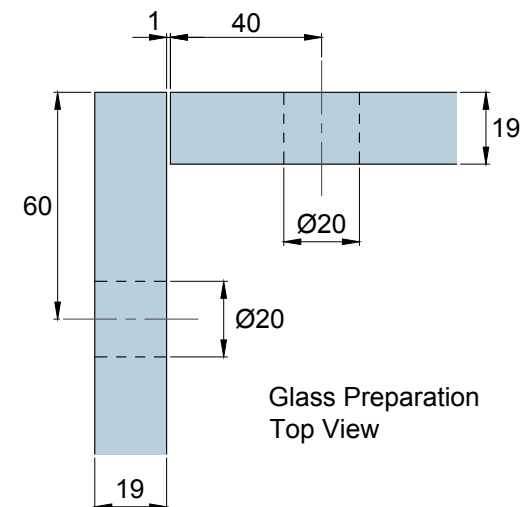

Glass Preparation
(19mm Glass Thickness)

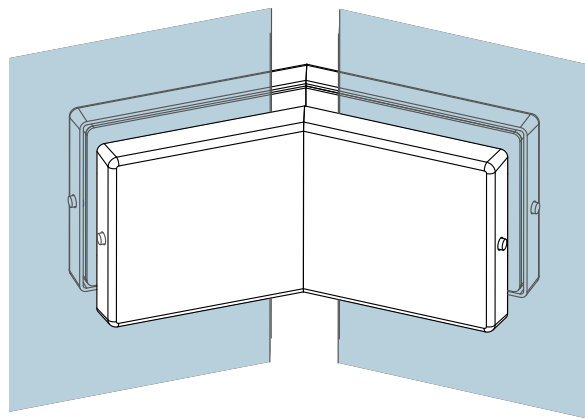
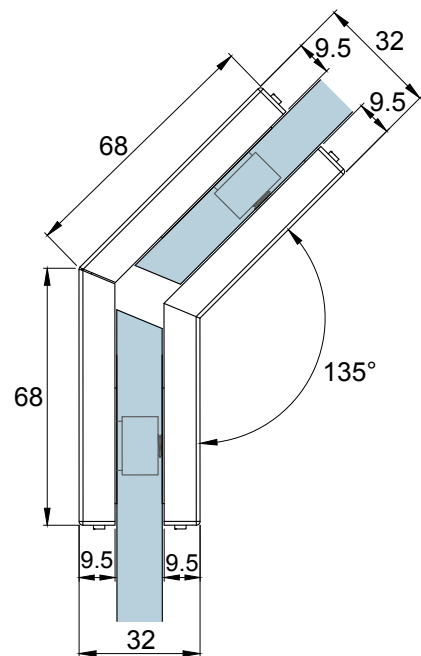

Glass Thickness	10 - 12 mm Glass Thickness
Material	Body: Aluminium Cover: Stainless Steel
Finishes	Polished Stainless Steel Satin Stainless Steel

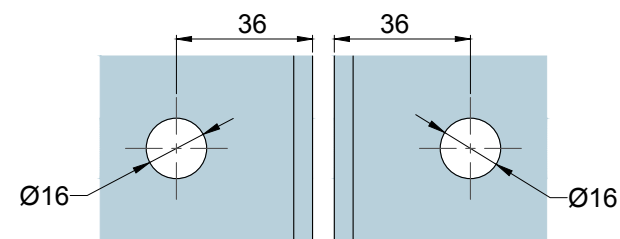
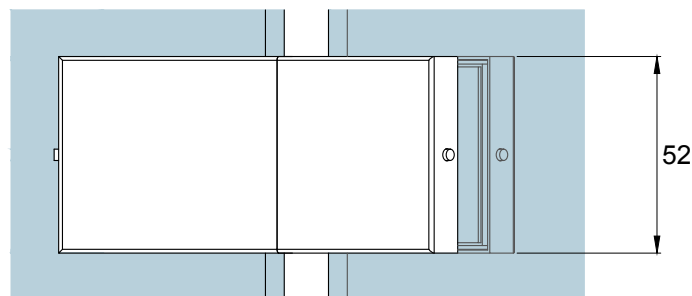
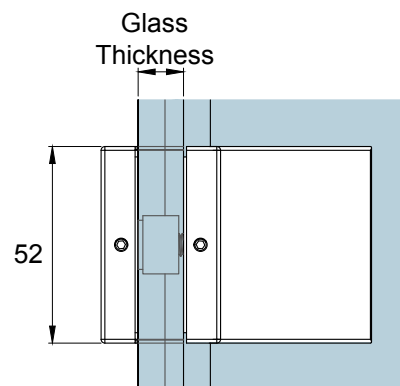
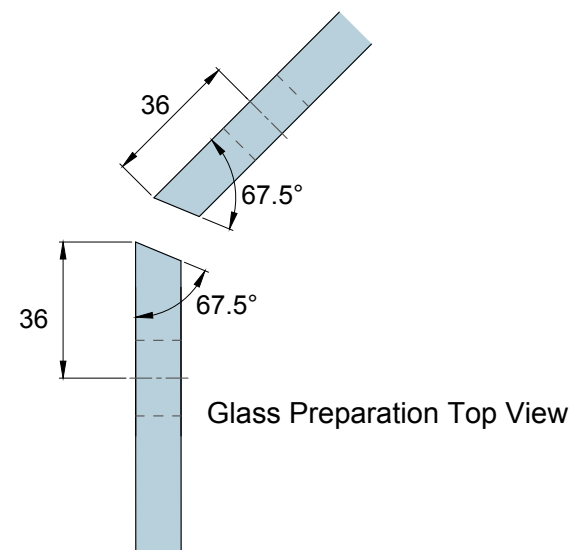

Glass Preparation

Glass Thickness	10 - 12 mm Glass Thickness
Material	Body: Aluminium Cover: Stainless Steel
Finishes	Polished Stainless Steel Satin Stainless Steel

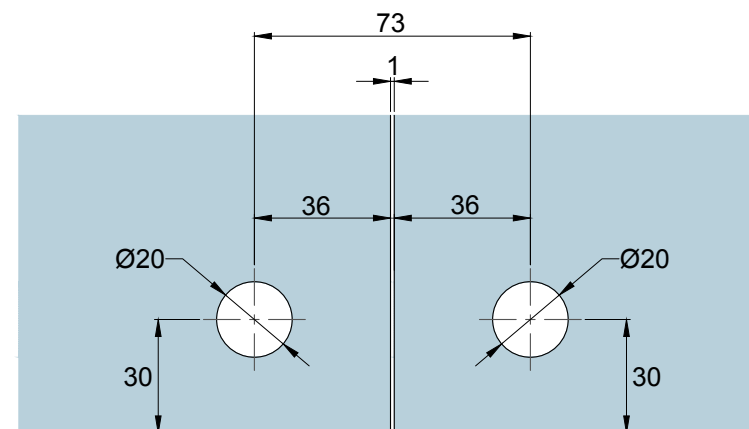
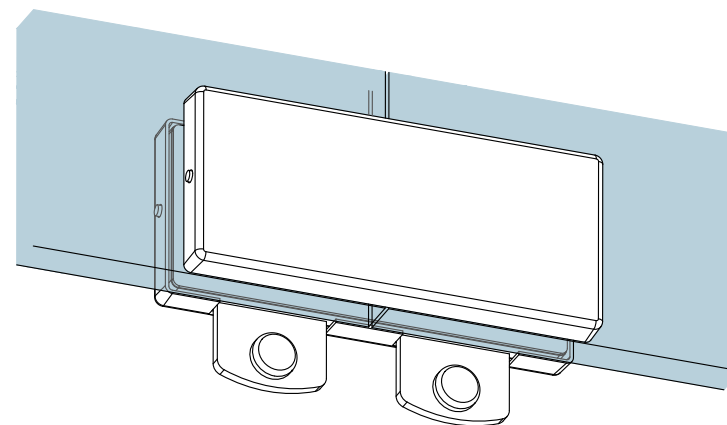
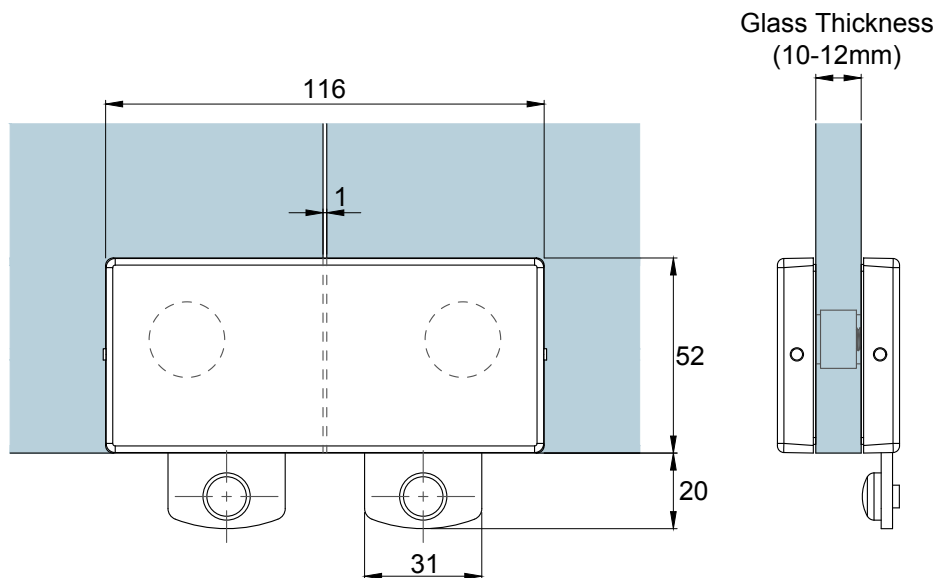
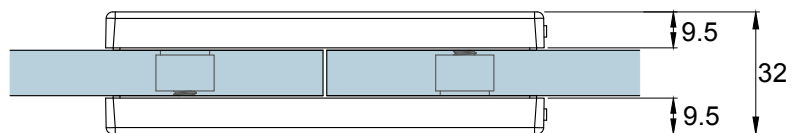

Glass Preparation