

Glass Thickness	10 - 12 mm Glass Thickness
Material	Body: Aluminium Cover: Stainless Steel
Finishes	Polished Stainless Steel Satin Stainless Steel

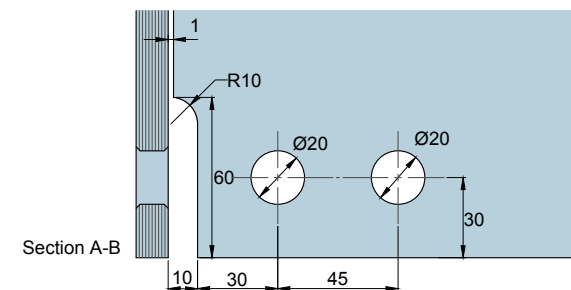

Glass Preparation
for Fin Fitting Attachment Panel

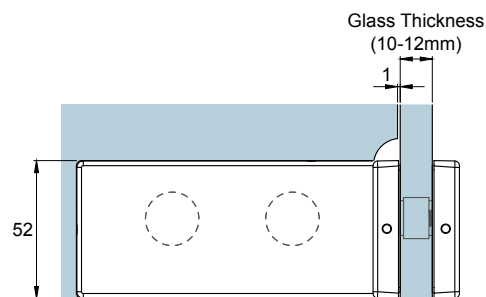
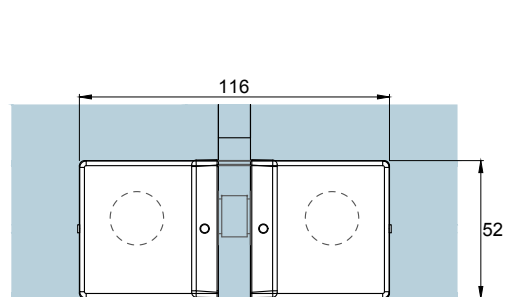
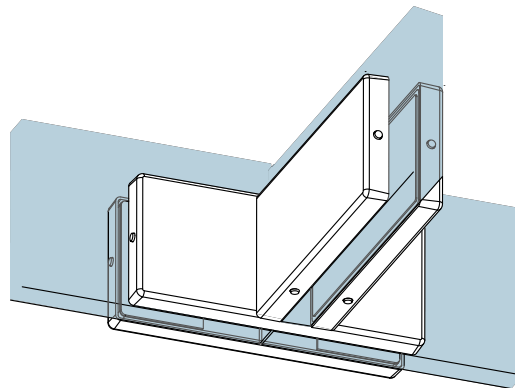
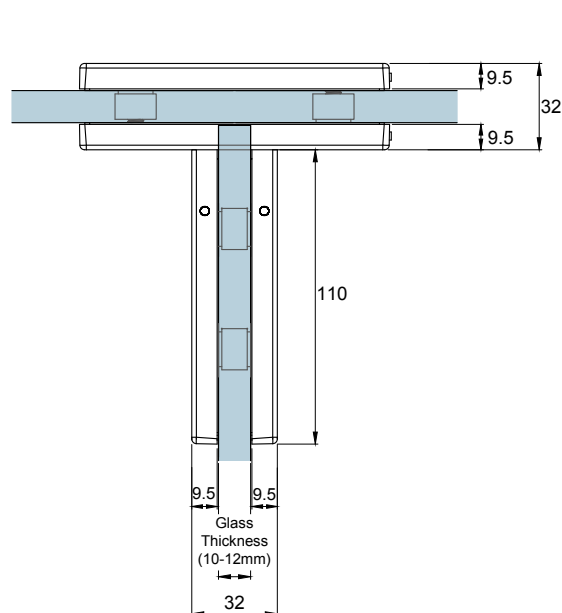
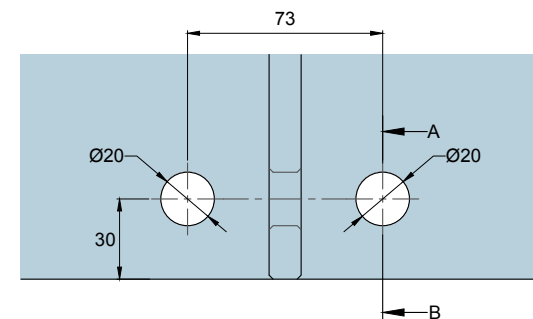

Glass Preparation for Overpanel

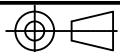

Glass Thickness	10 - 12 mm Glass Thickness
Material	Body: Aluminium Cover: Stainless Steel
Finishes	Polished Stainless Steel Satin Stainless Steel

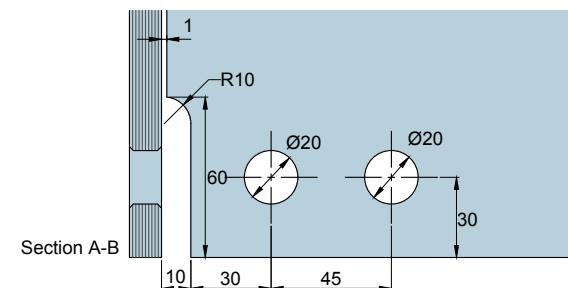
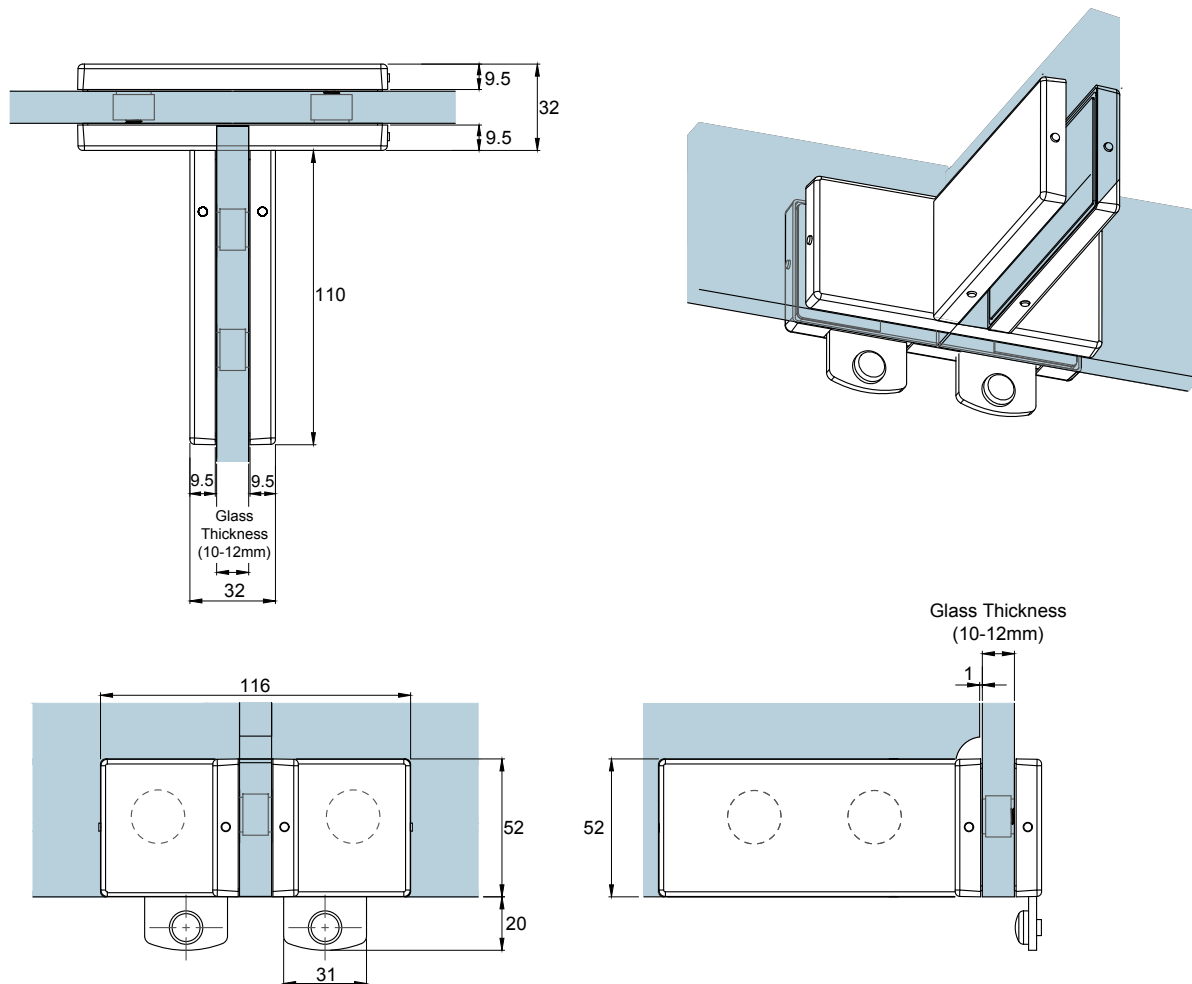

Glass Preparation
for Fin Fitting Attachment Panel

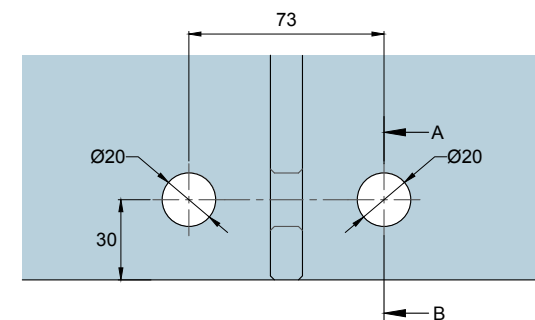

Glass Preparation for Overpanel

Glass Thickness	10 - 12 mm Glass Thickness
Material	Body: Aluminium Cover: Stainless Steel
Finishes	Polished Stainless Steel Satin Stainless Steel

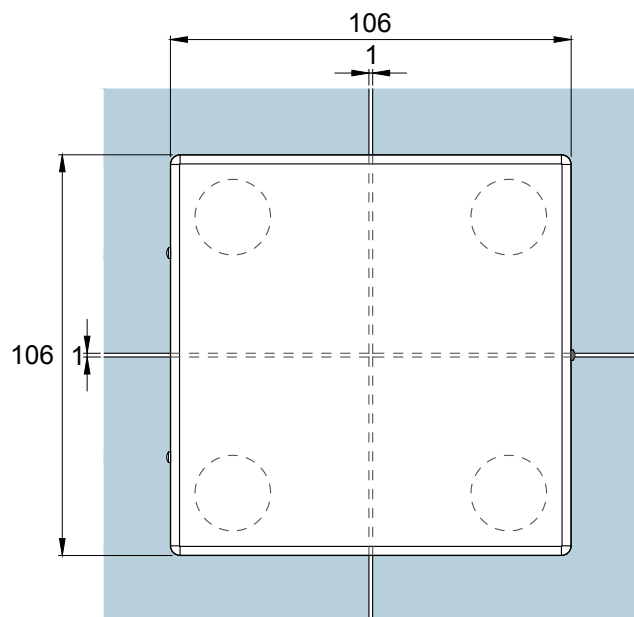
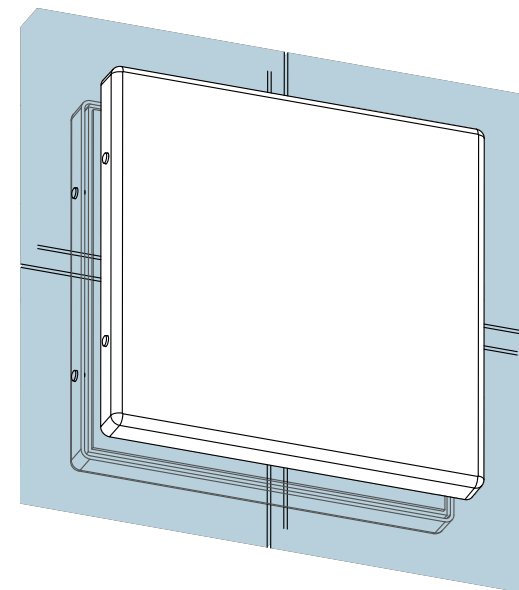
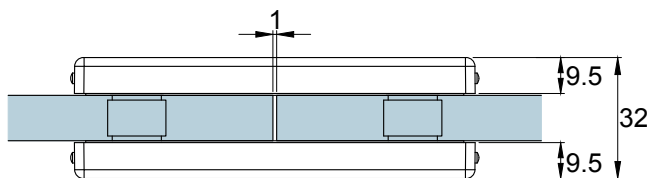

Glass Thickness
(10-12mm)

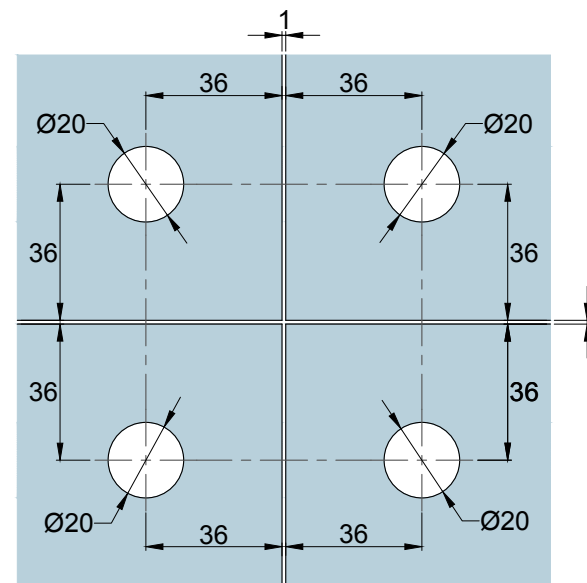
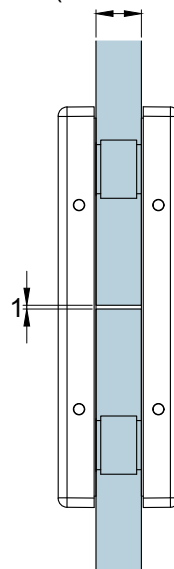

Glass Preparation

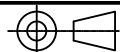

Glass Thickness	10 - 12 mm Glass Thickness
Material	Body: Aluminium Cover: Stainless Steel
Finishes	Polished Stainless Steel Satin Stainless Steel

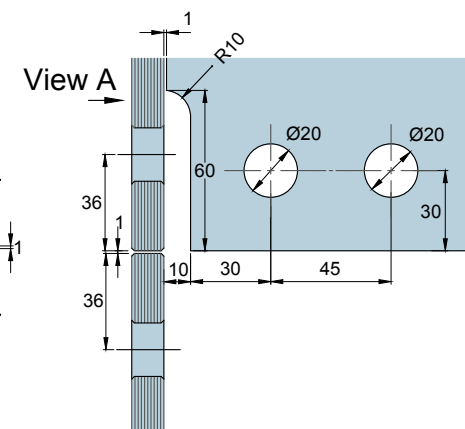
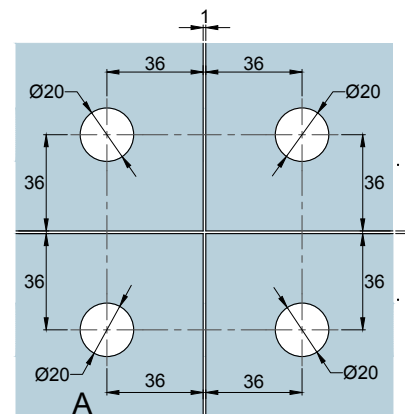
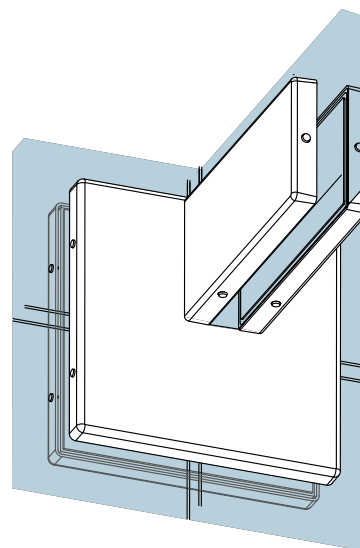
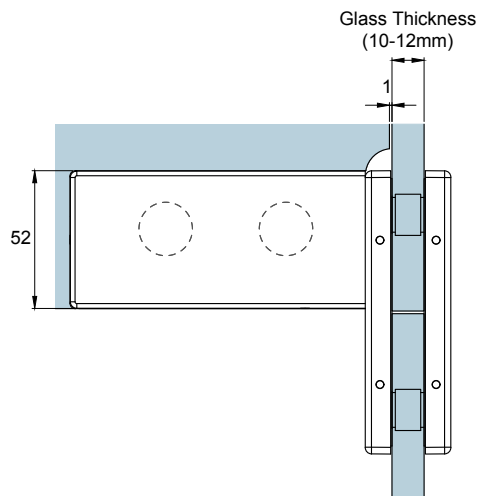
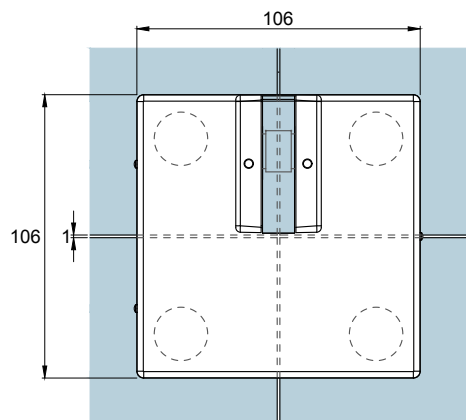
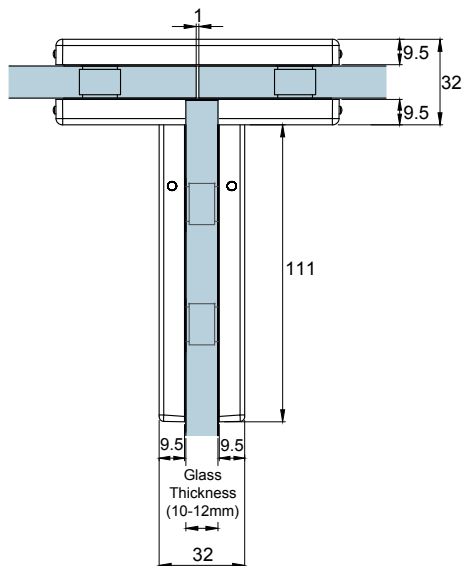

Glass Preparation

Glass Thickness	10 - 12 mm Glass Thickness
Material	Body: Aluminium Cover: Stainless Steel
Finishes	Polished Stainless Steel Satin Stainless Steel

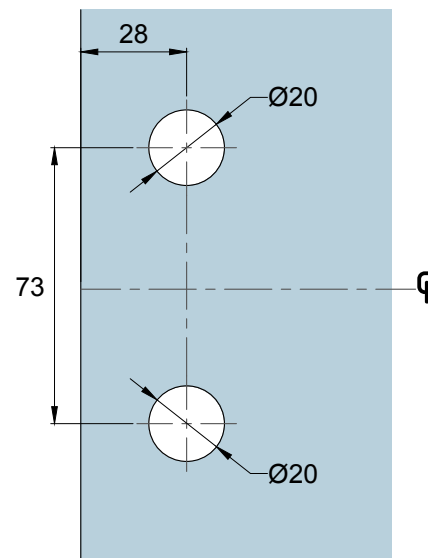
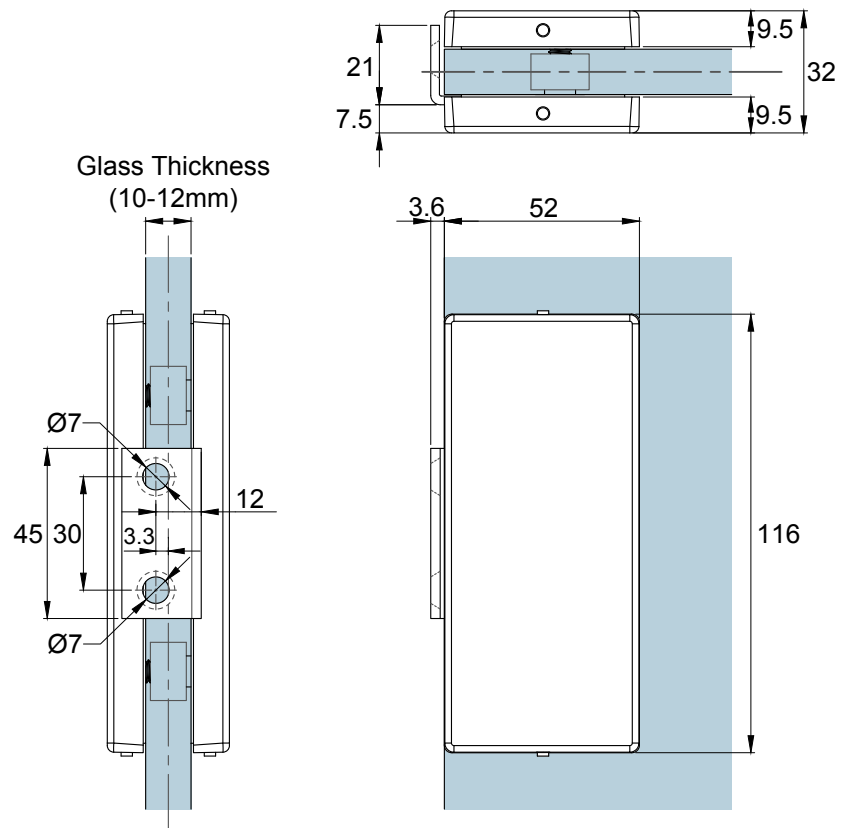

Glass Preparation

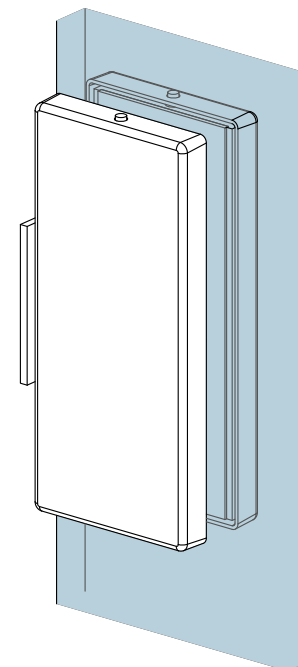

Glass Thickness	10 - 12 mm Glass Thickness
Material	Body: Aluminium Cover: Stainless Steel
Finishes	Polished Stainless Steel Satin Stainless Steel

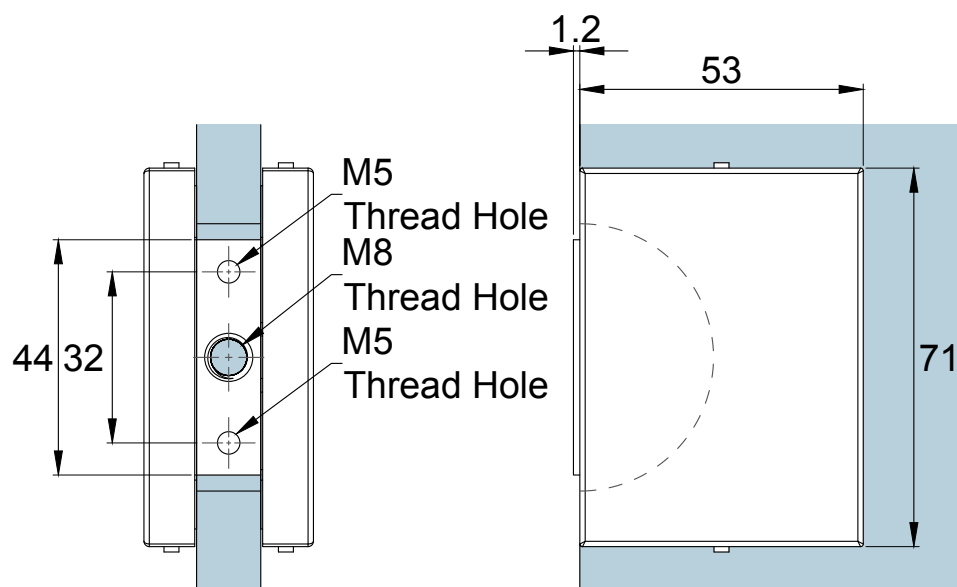
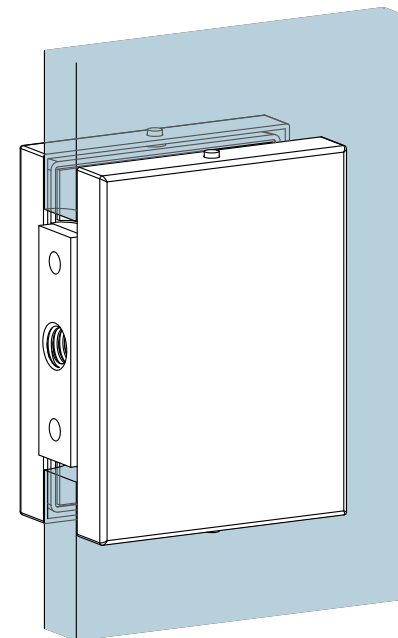
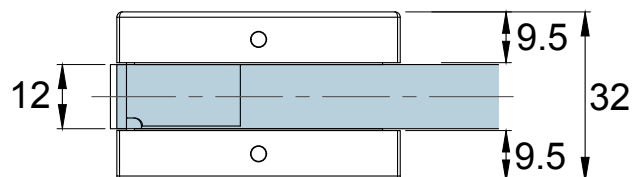

Glass Thickness
(10-12mm)

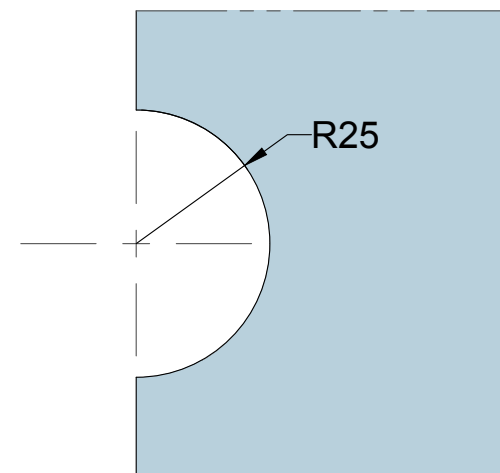
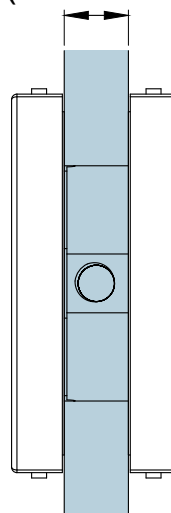

Glass Preparation

Glass Thickness	10 - 12 mm Glass Thickness
Material	Body: Aluminium Cover: Stainless Steel
Finishes	Polished Stainless Steel Satin Stainless Steel

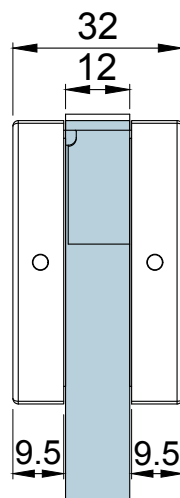
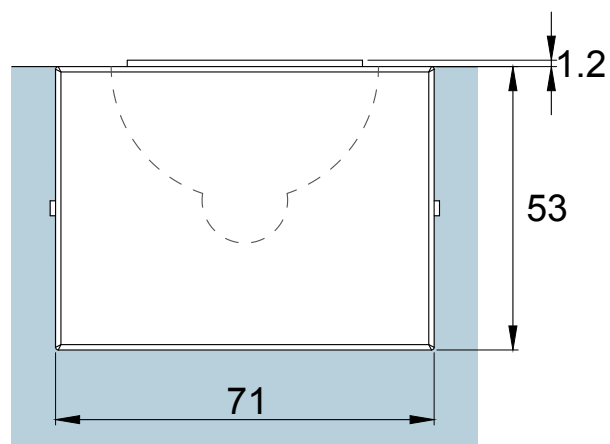
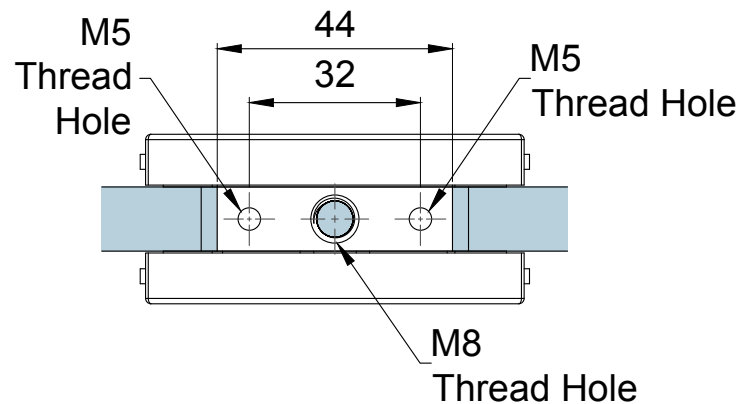

Glass Thickness
(10-12mm)

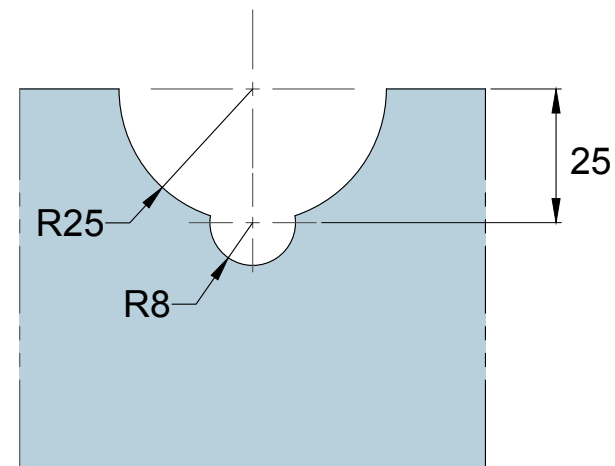
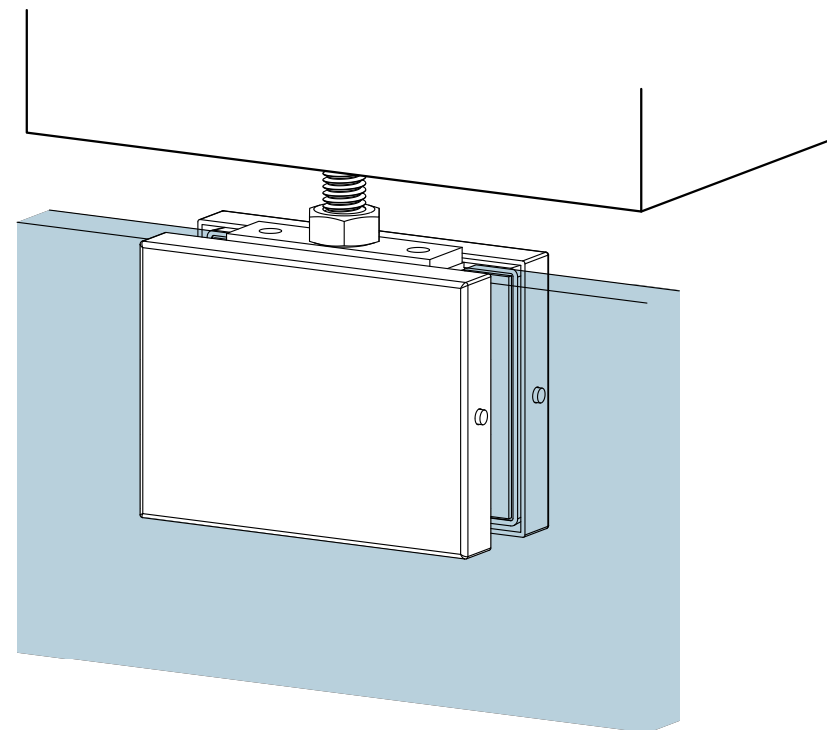

Glass Preparation