

Glass Preparation for Sliding Door

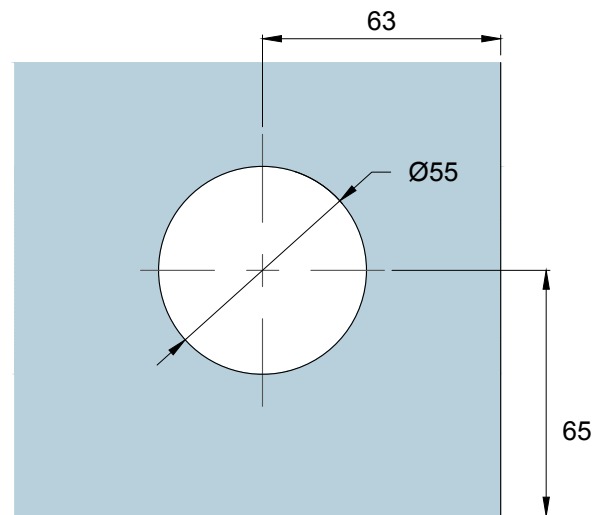

Glass Preparation for Swing Door

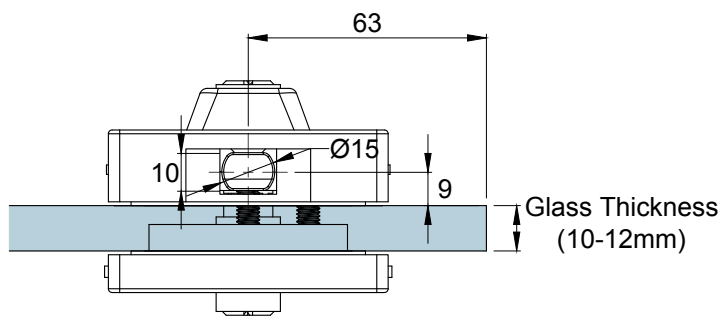

| | |
|-----------------|---|
| Glass Thickness | 10 - 12 mm Glass Thickness |
| Material | Body: Aluminium Cover: Stainless Steel |
| Finishes | Polished Stainless Steel Satin Stainless Steel |

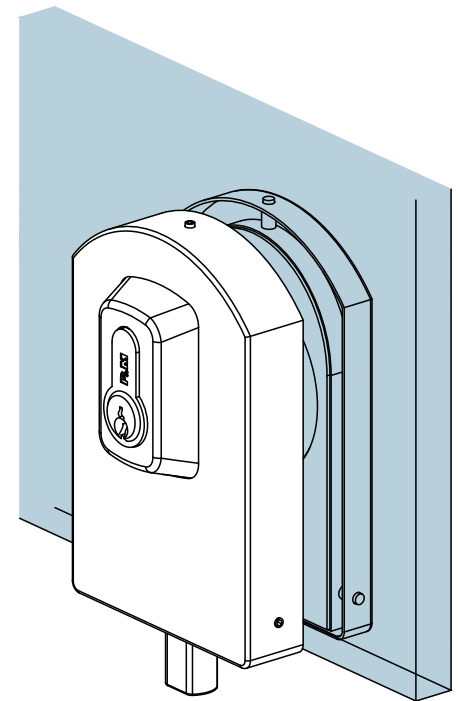

| | |
|-----------------|---|
| Glass Thickness | 10 - 12 mm Glass Thickness |
| Material | Body: Aluminium Cover: Stainless Steel |
| Finishes | Polished Stainless Steel Satin Stainless Steel |

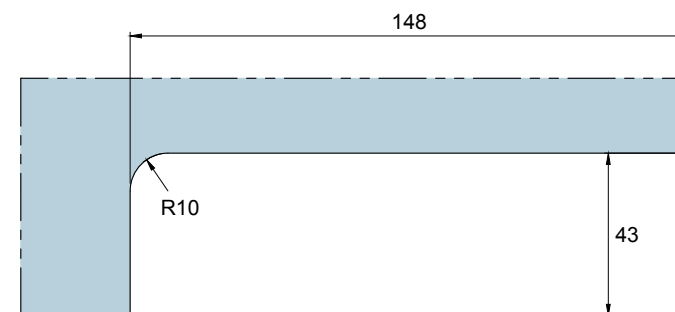
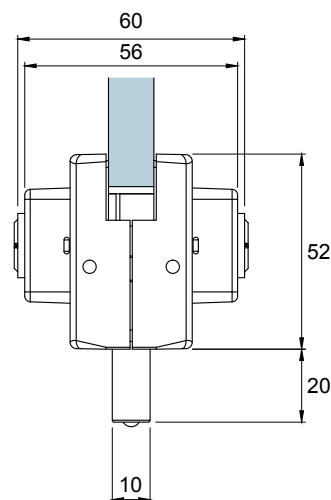
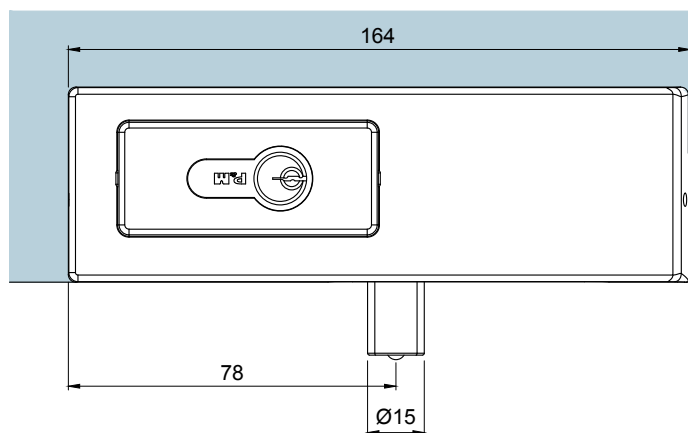
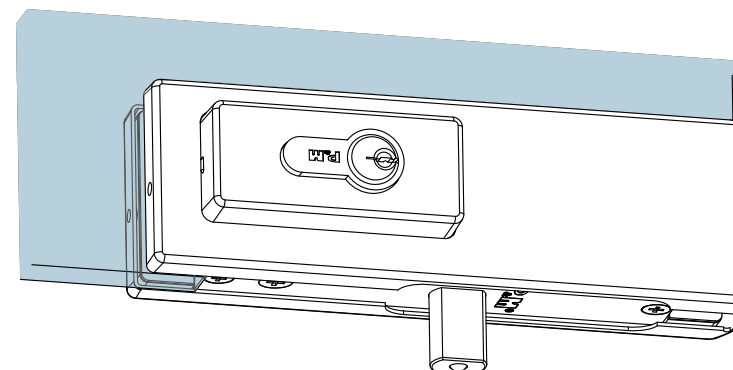
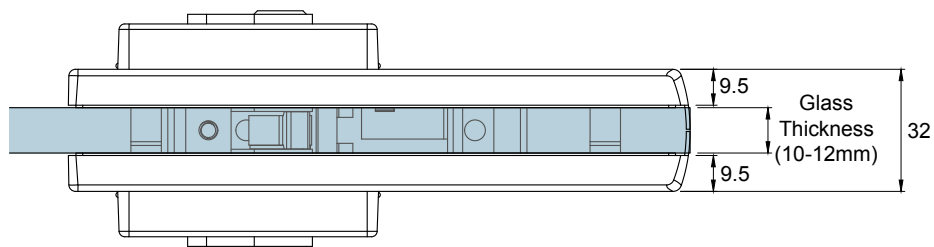

Glass Preparation PL50 Corner Patch

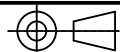

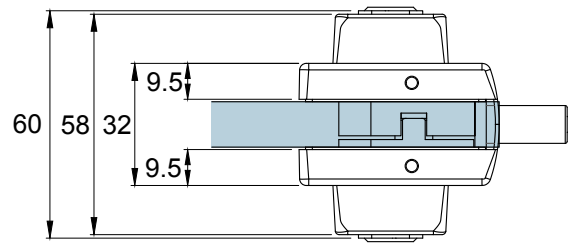

| | |
|-----------------|---|
| Glass Thickness | 10 - 12 mm Glass Thickness |
| Material | Body: Aluminium Cover: Stainless Steel |
| Finishes | Polished Stainless Steel Satin Stainless Steel |

Glass Thickness
(10-12mm)

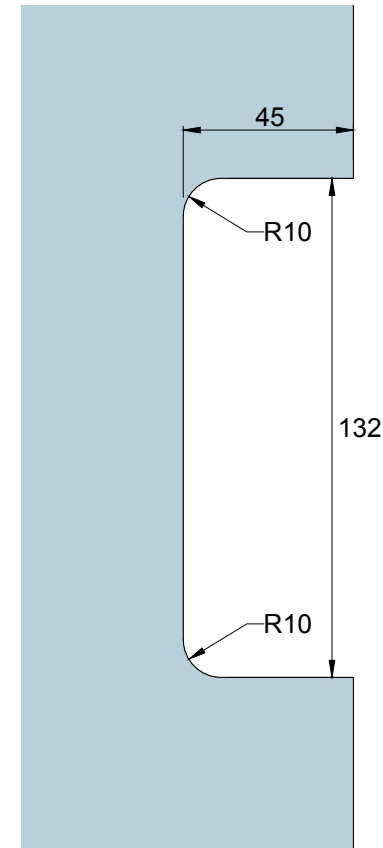
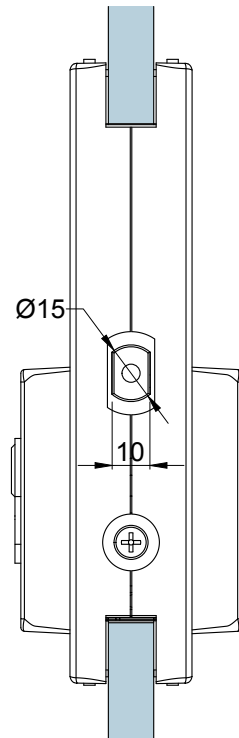
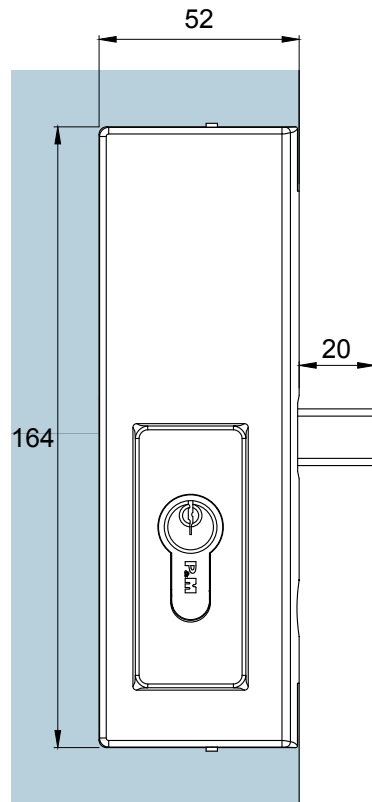
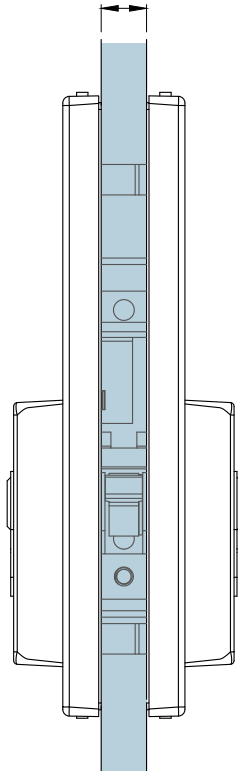

Glass Preparation

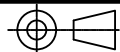
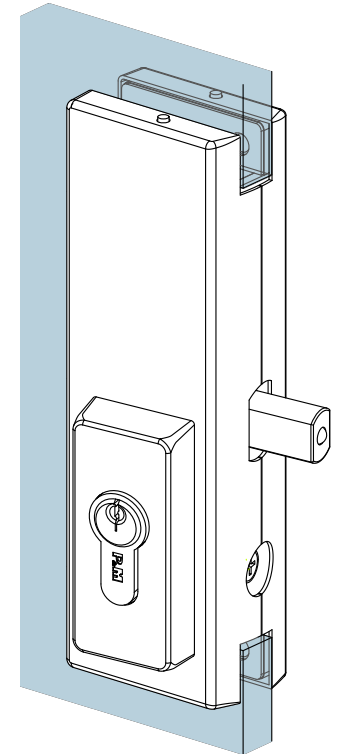

| | |
|-----------------|---|
| Glass Thickness | 10 - 12 mm Glass Thickness |
| Material | Body: Aluminium Cover: Stainless Steel |
| Finishes | Polished Stainless Steel Satin Stainless Steel |

