

Glass Thickness	10 - 12 mm Glass Thickness
Material	SUS304
Material Finish	Satin Stainless Steel

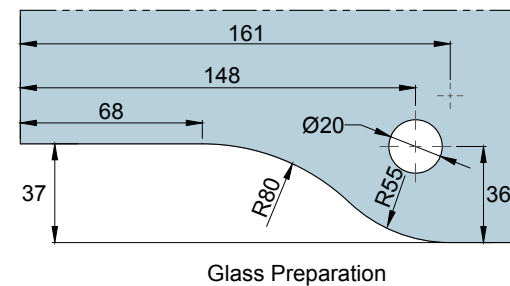

Glass Thickness	10 - 12 mm Glass Thickness
Material	SUS304
Material Finish	Satin Stainless Steel

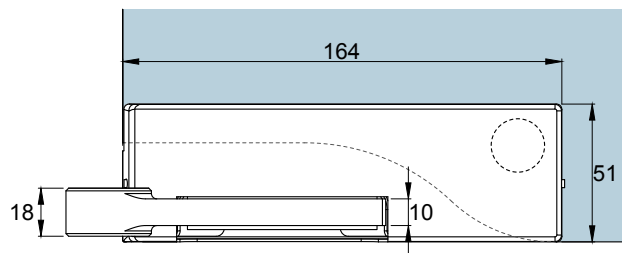
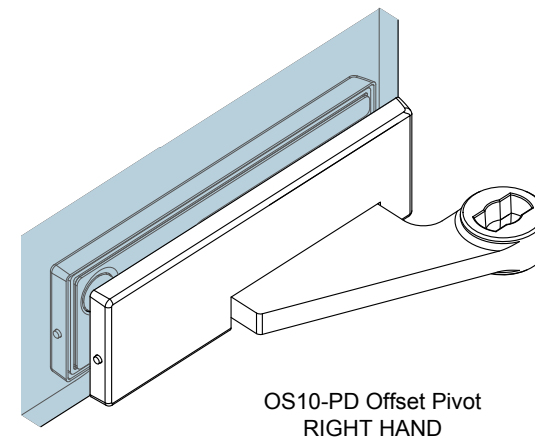
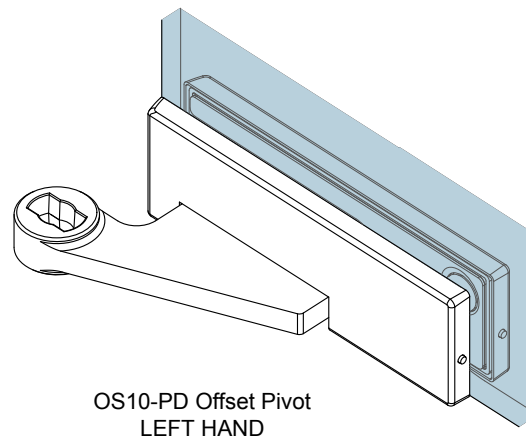
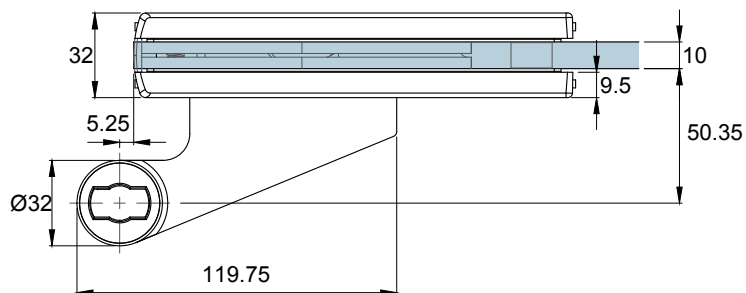
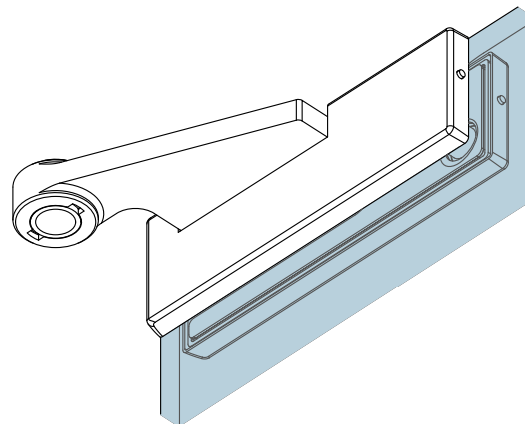
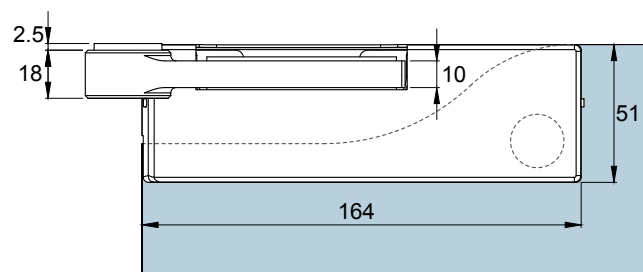
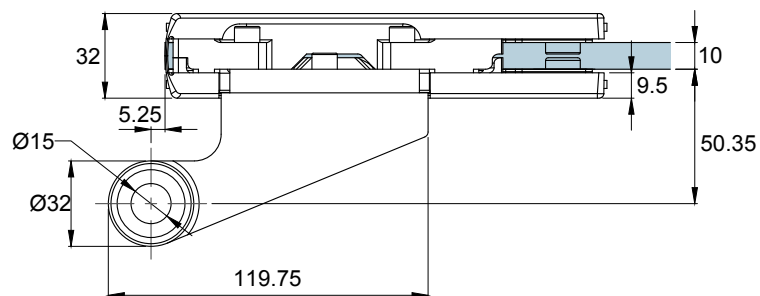

OS20-PD Offset Pivot  
LEFT HAND

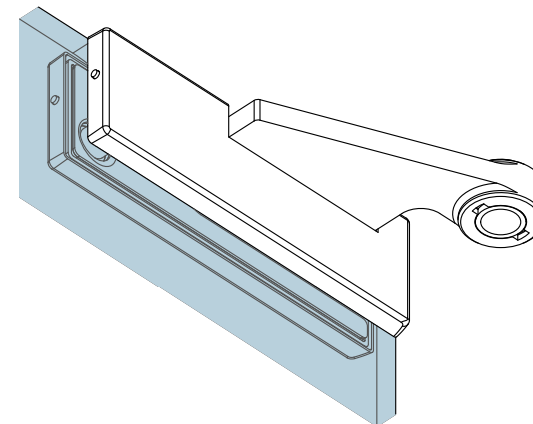

OS20-PD Offset Pivot  
RIGHT HAND

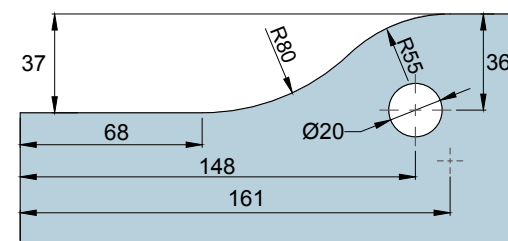

Glass Preparation

Glass Thickness	10 - 12 mm Glass Thickness
Material	SUS304
Material Finish	Satin Stainless Steel

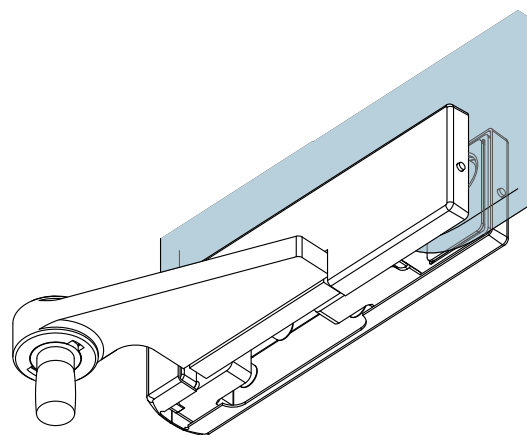
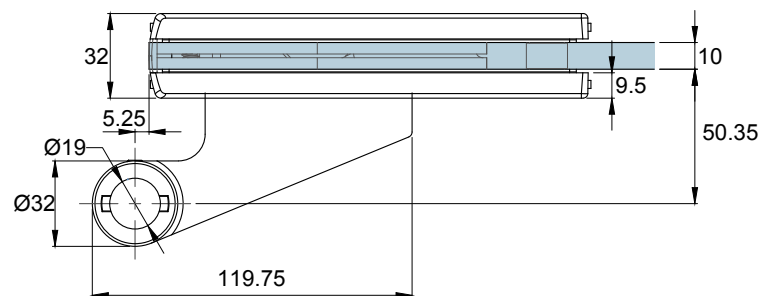

OS30-PD Offset Pivot  
LEFT HAND

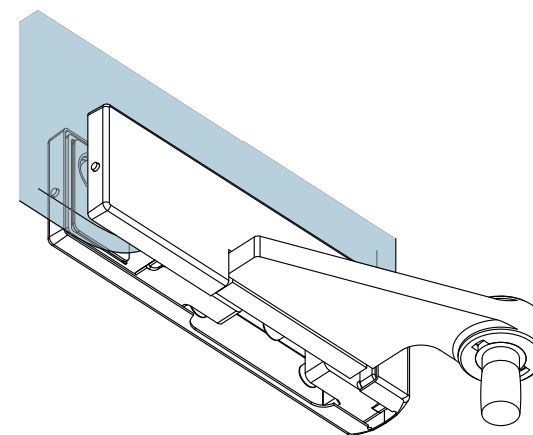

OS30-PD Offset Pivot  
RIGHT HAND

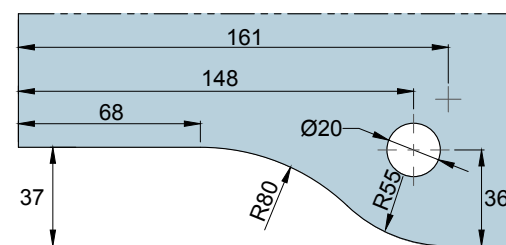
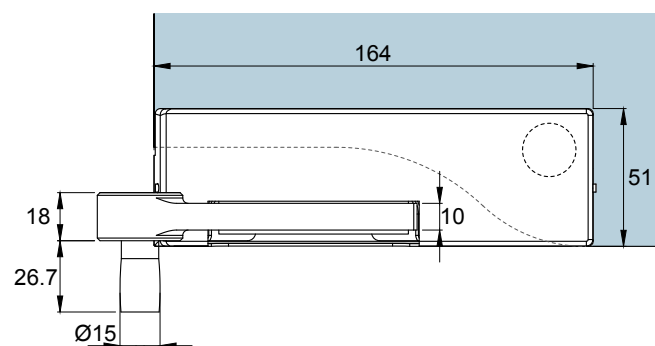

Glass Preparation

Glass Thickness	10 - 12 mm Glass Thickness
Material	SUS304
Material Finish	Satin Stainless Steel

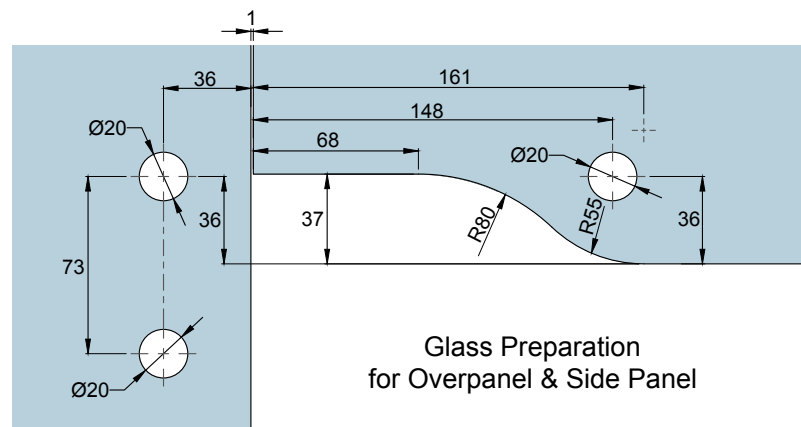
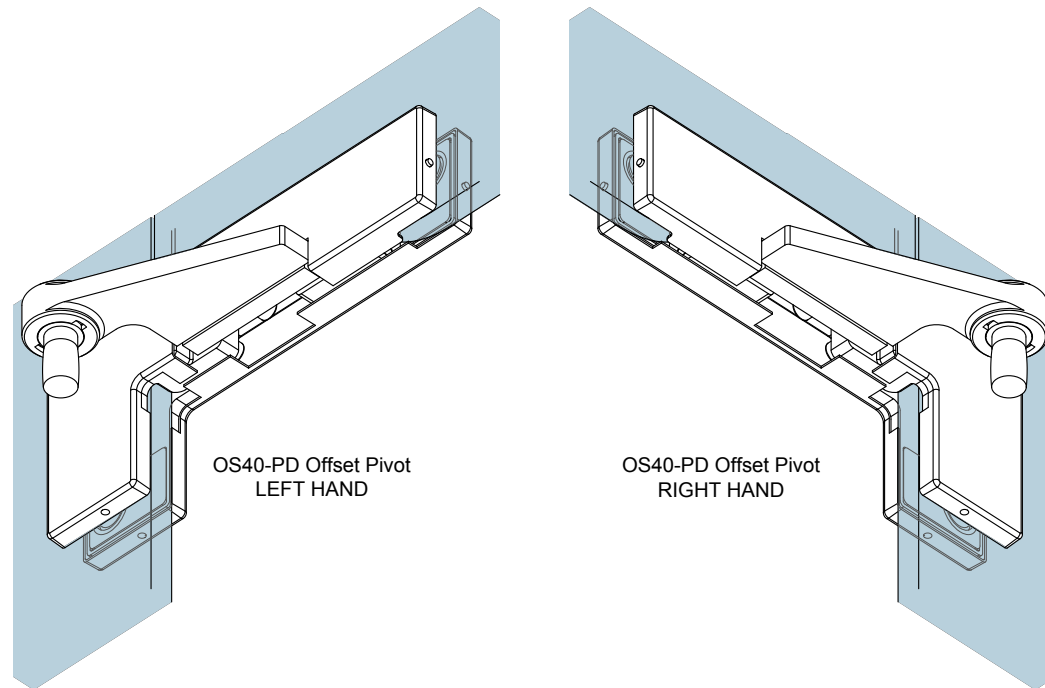
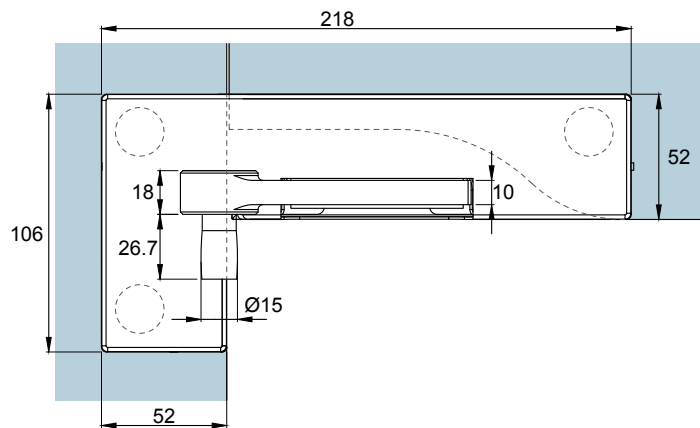
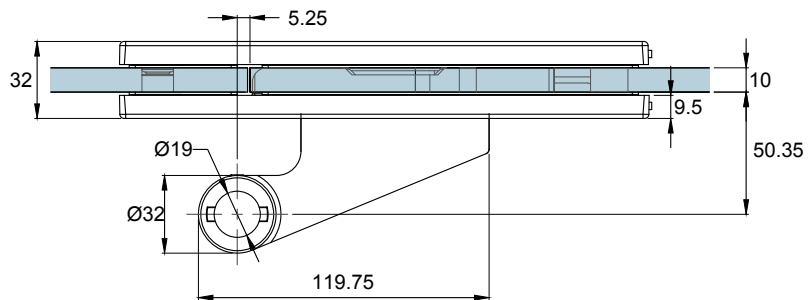

## Glass Preparation for Overpanel & Side Panel



Glass Thickness	8 - 12 mm Glass Thickness
Material	SUS304
Material Finish	Satin Stainless Steel

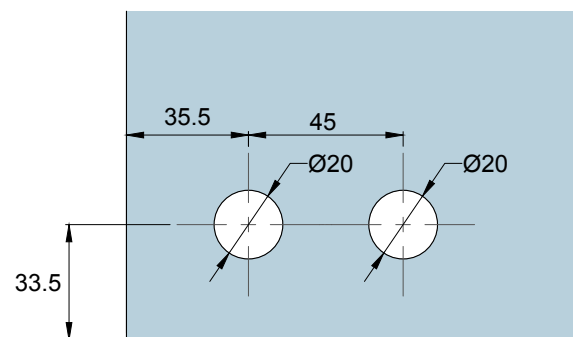
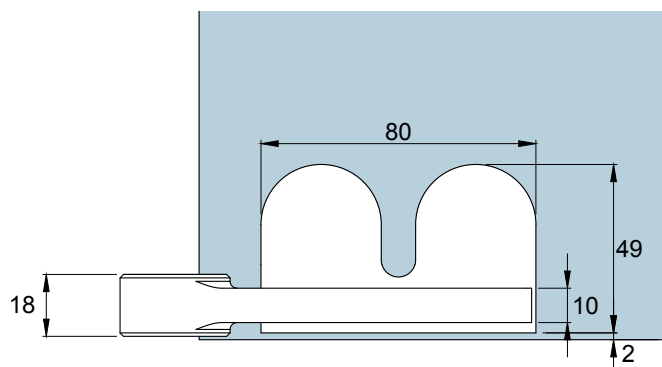
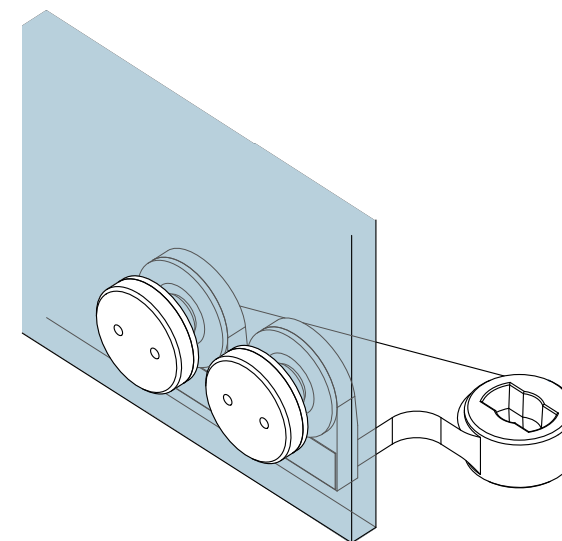
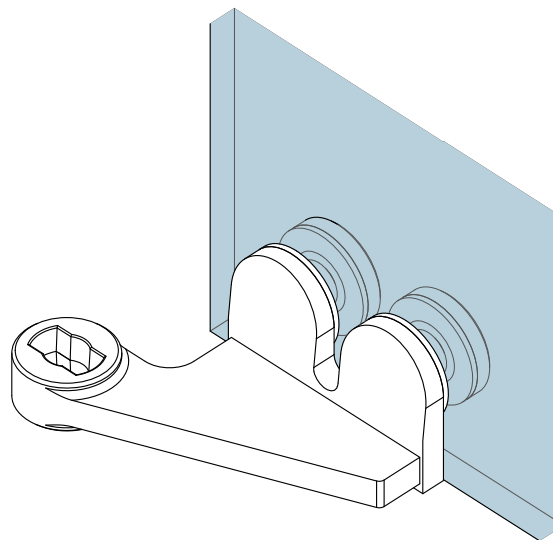
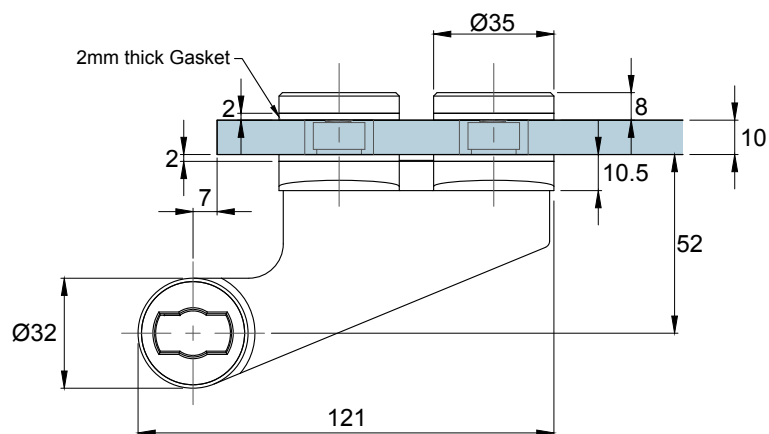

Glass Preparation

Glass Thickness	8 - 12 mm Glass Thickness
Material	SUS304
Material Finish	Satin Stainless Steel

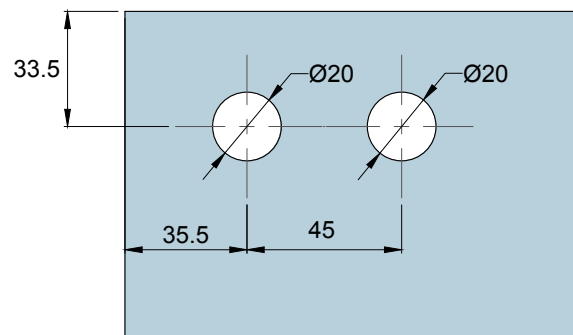
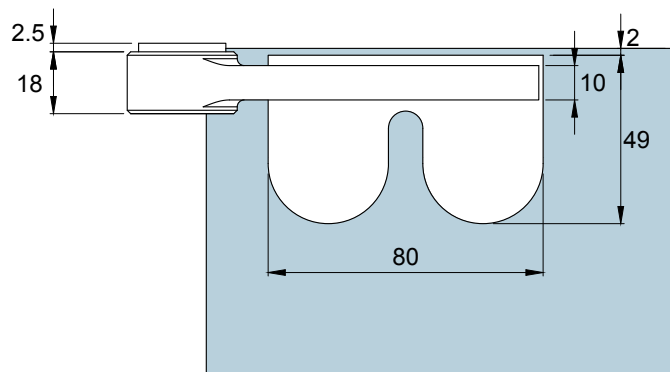
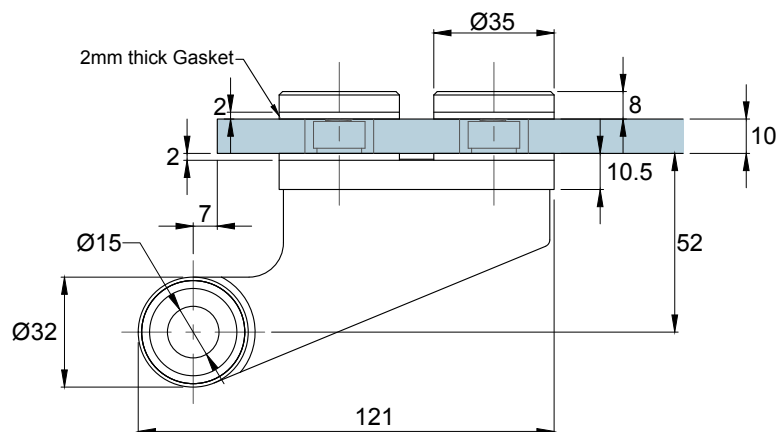
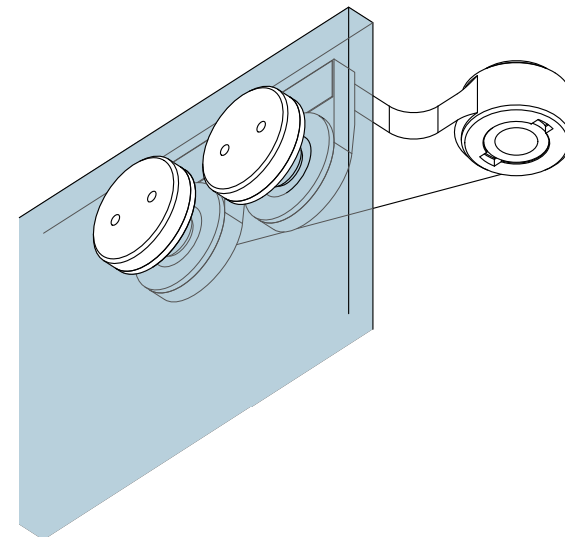
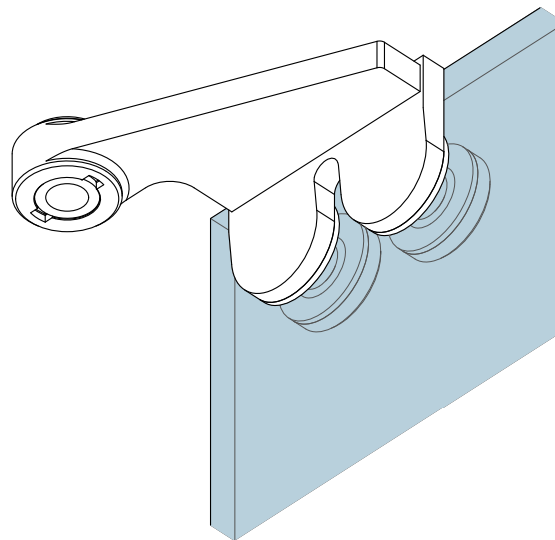

Glass Preparation

Glass Thickness	8 - 12 mm Glass Thickness
Material	SUS304
Material Finish	Satin Stainless Steel

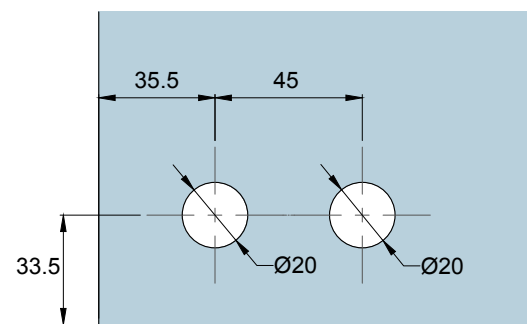
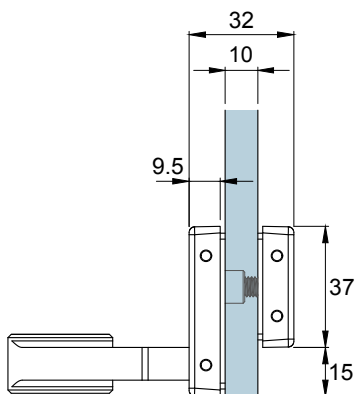
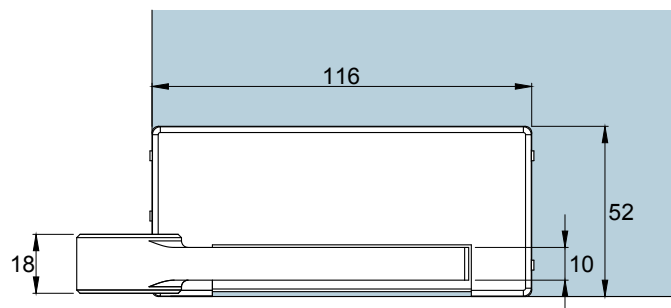
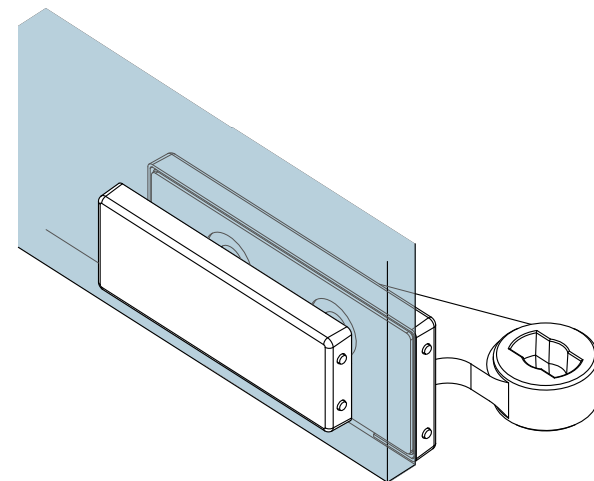
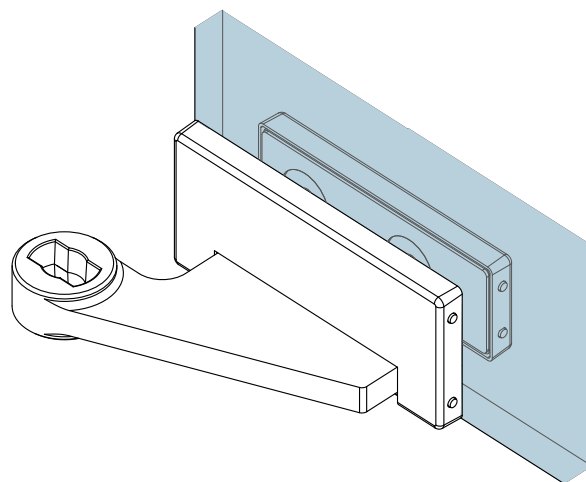
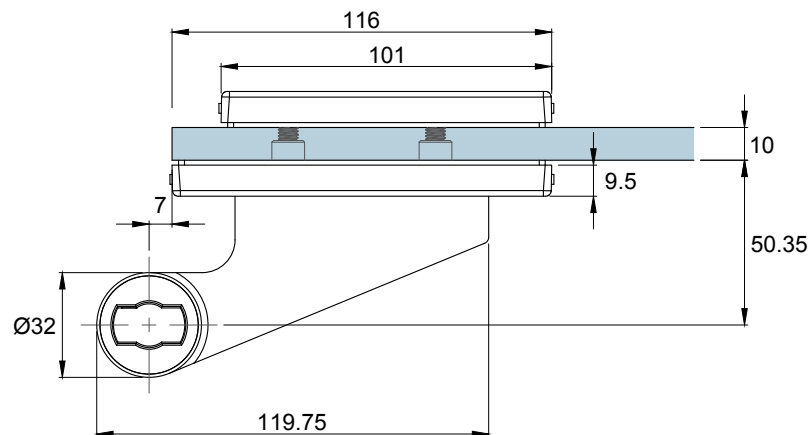

Glass Preparation

Glass Thickness	8 - 12 mm Glass Thickness
Material	SUS304
Material Finish	Satin Stainless Steel

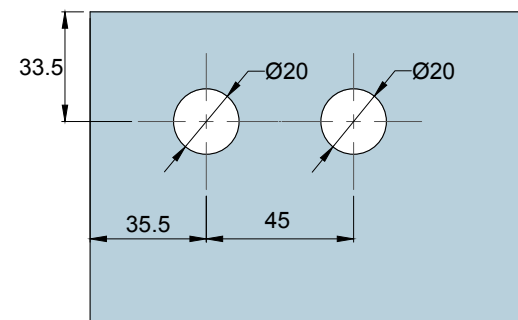
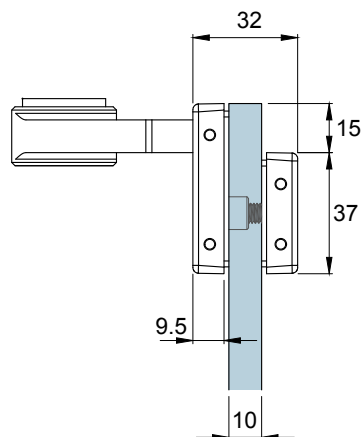
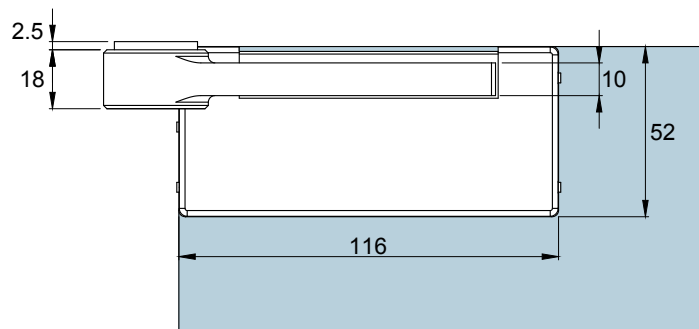
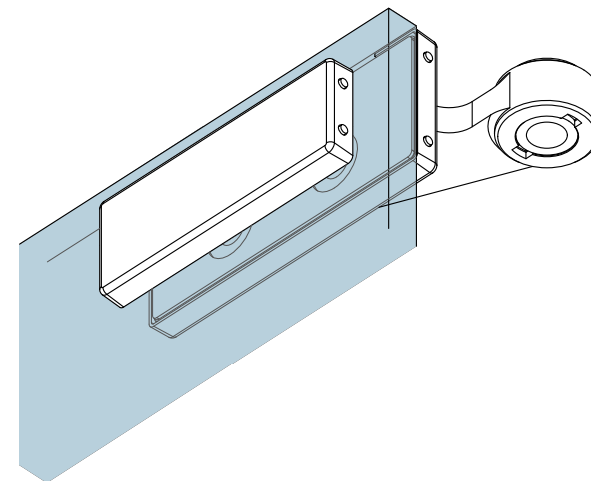
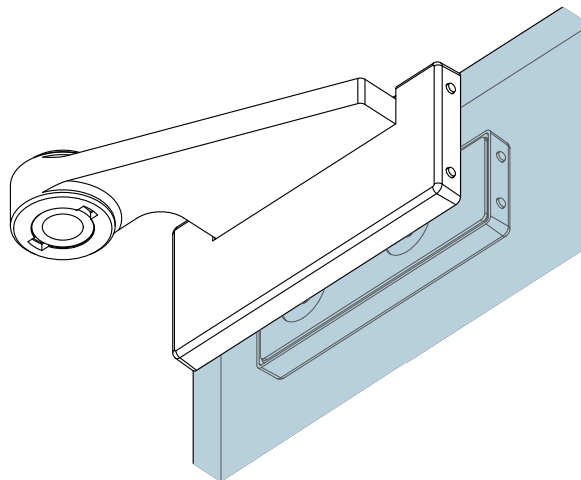
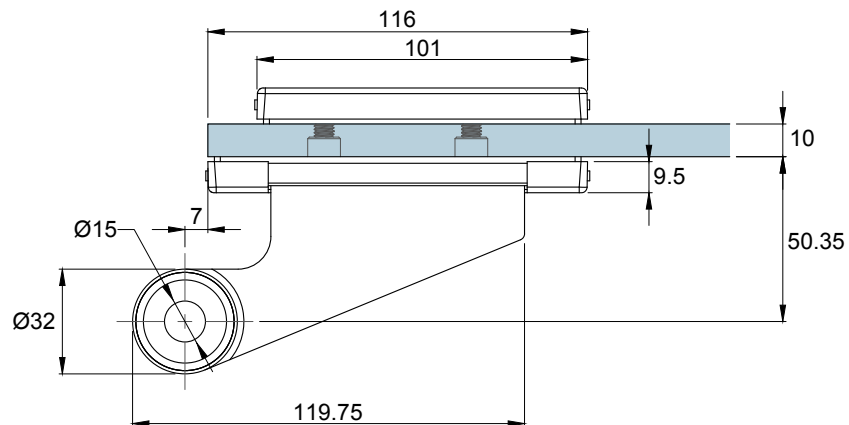

Glass Preparation

Material	SUS304
Material Finish	Satin Stainless Steel

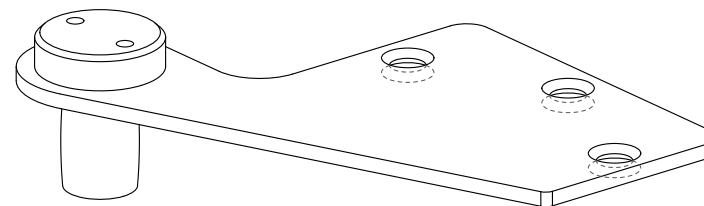
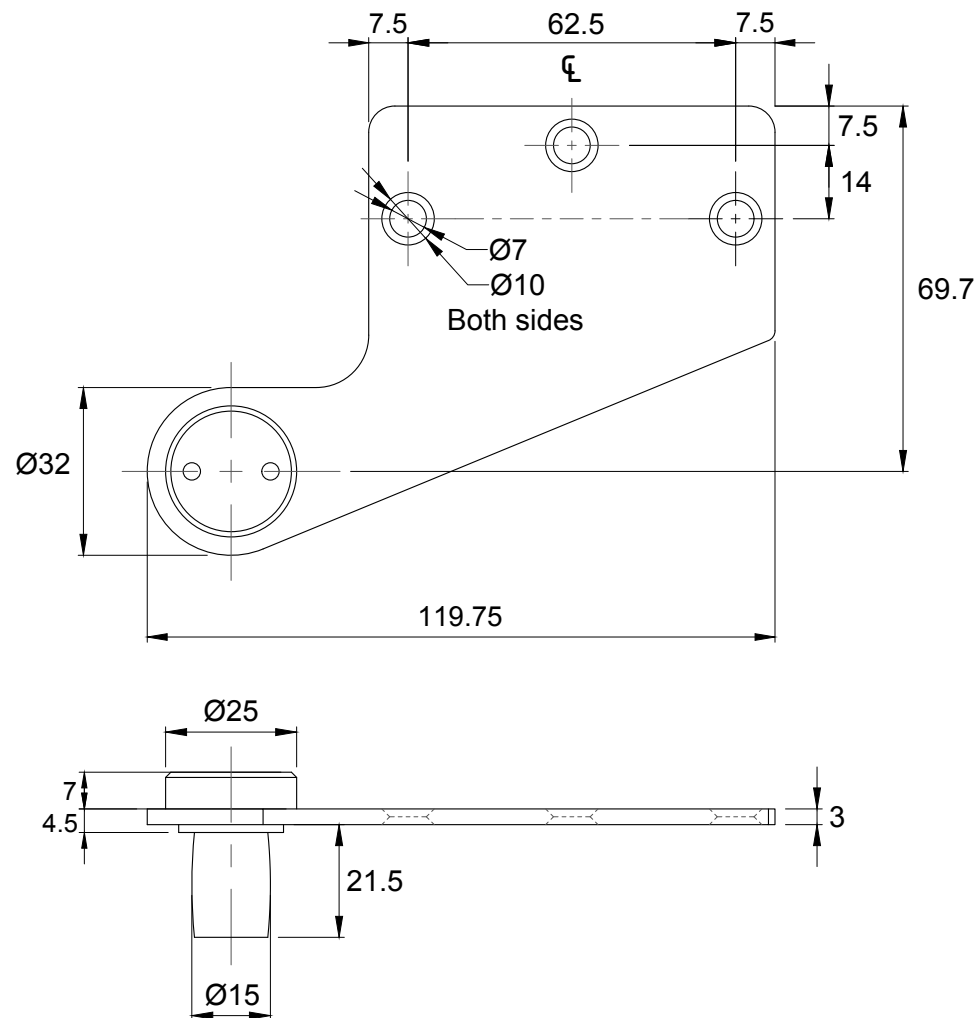

Material	SUS304
Material Finish	Satin Stainless Steel

